

Gjerrild - Grenaa Jernbane

Planbog

1 - 2000.



Planbog

for

Gjerrild-Grenaa Jernbane

1914.

A. A. Jensen

Landinspektör.

Gjerild - Grenaa Jernbane.

Stat. 309 - 355

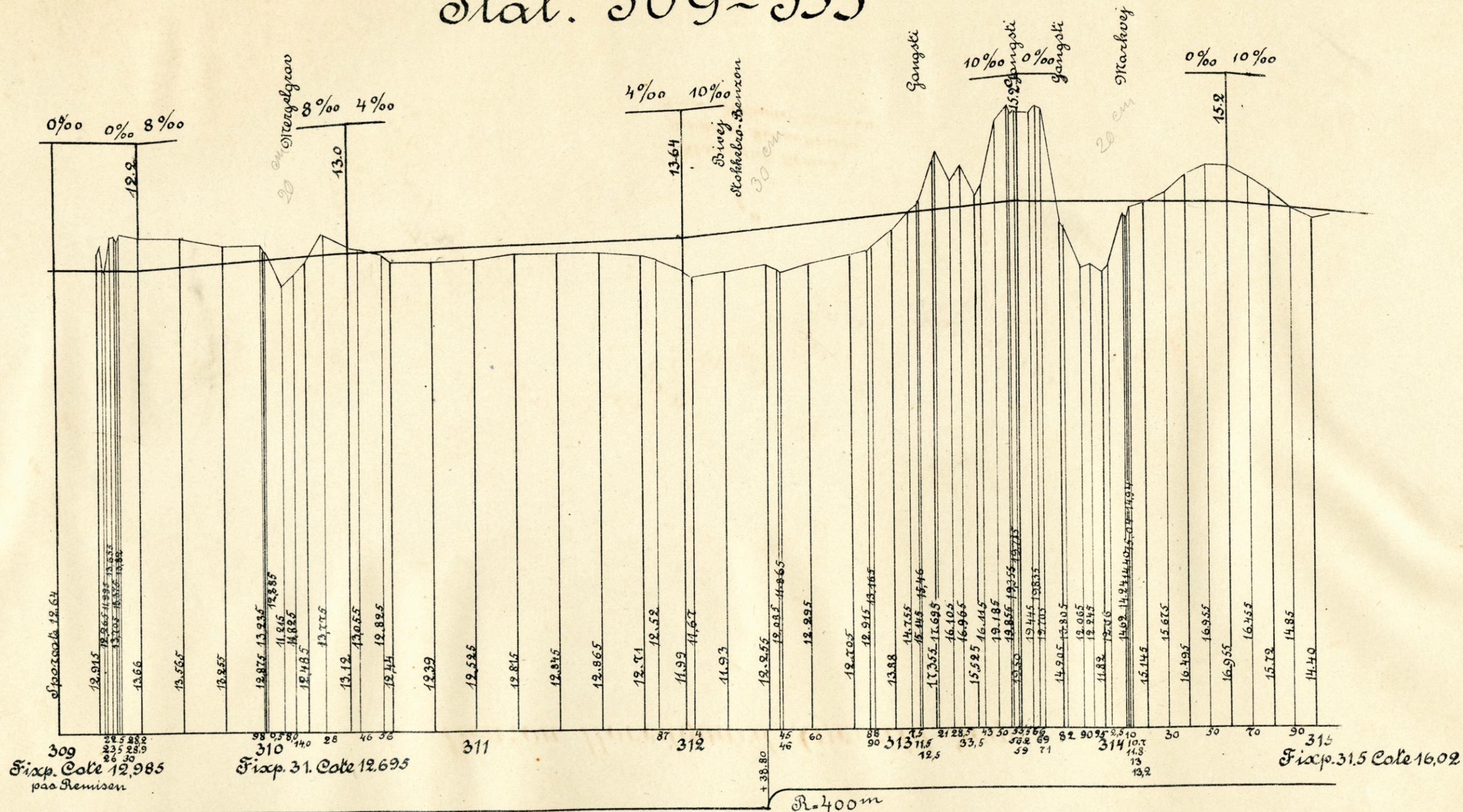

329
91

201
325

314
97

28
315

Benzon Hovedgaard, Gjerrild Sogn

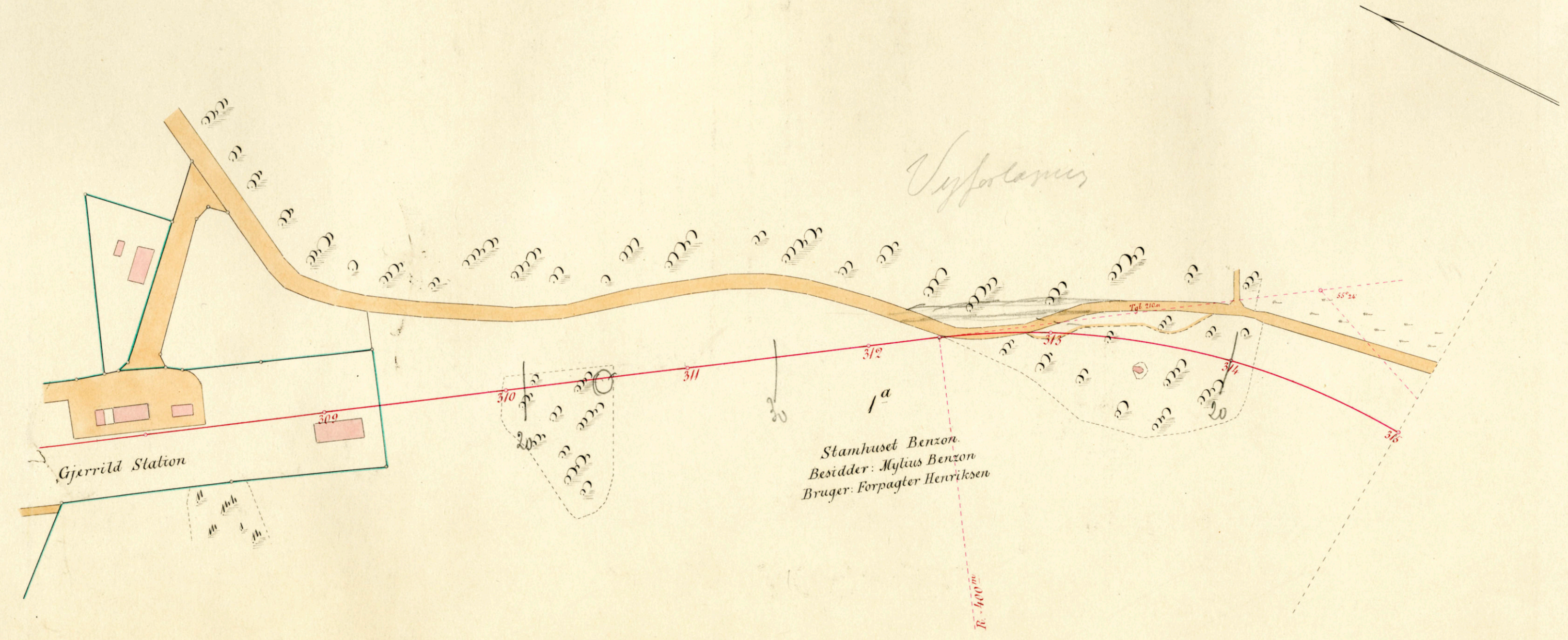

Stamhuset Benzon.
 Besidder: Mylius Benzon
 Bruger: Forpagter Henriksen

Benzon Hovedgaard, Gjerrild Sogn

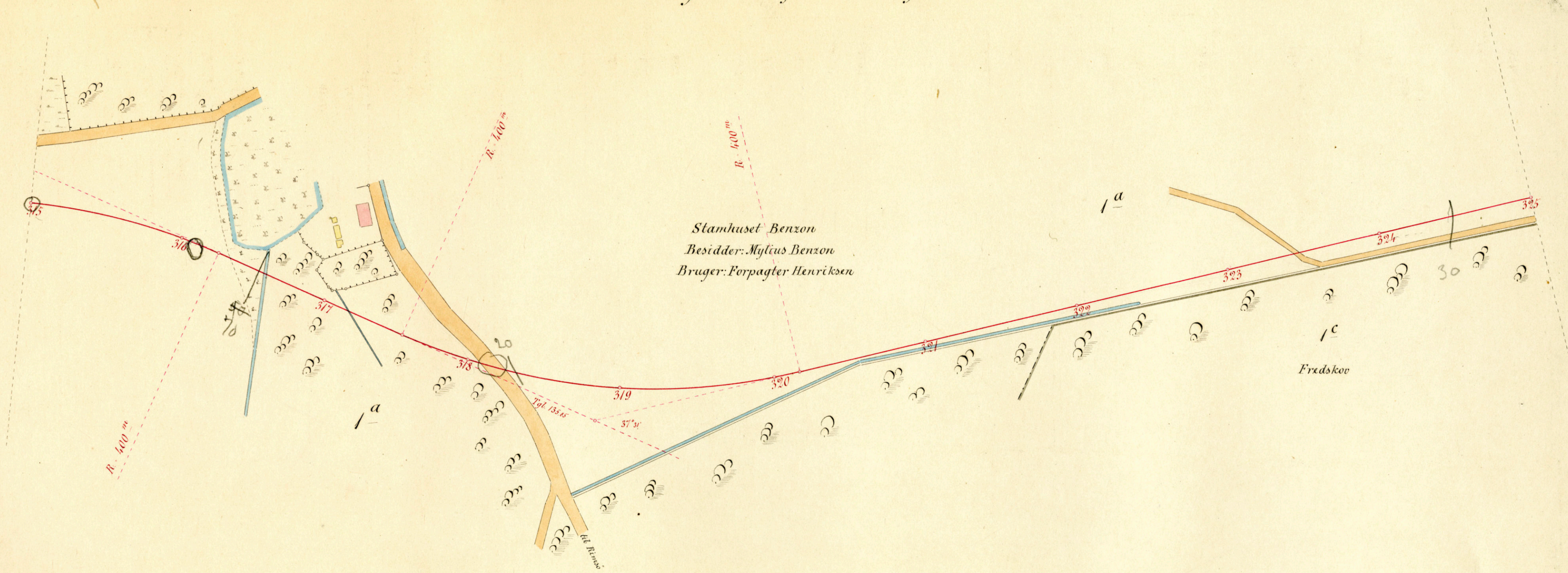
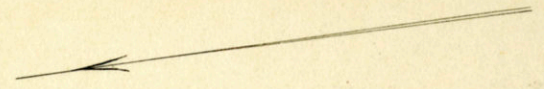

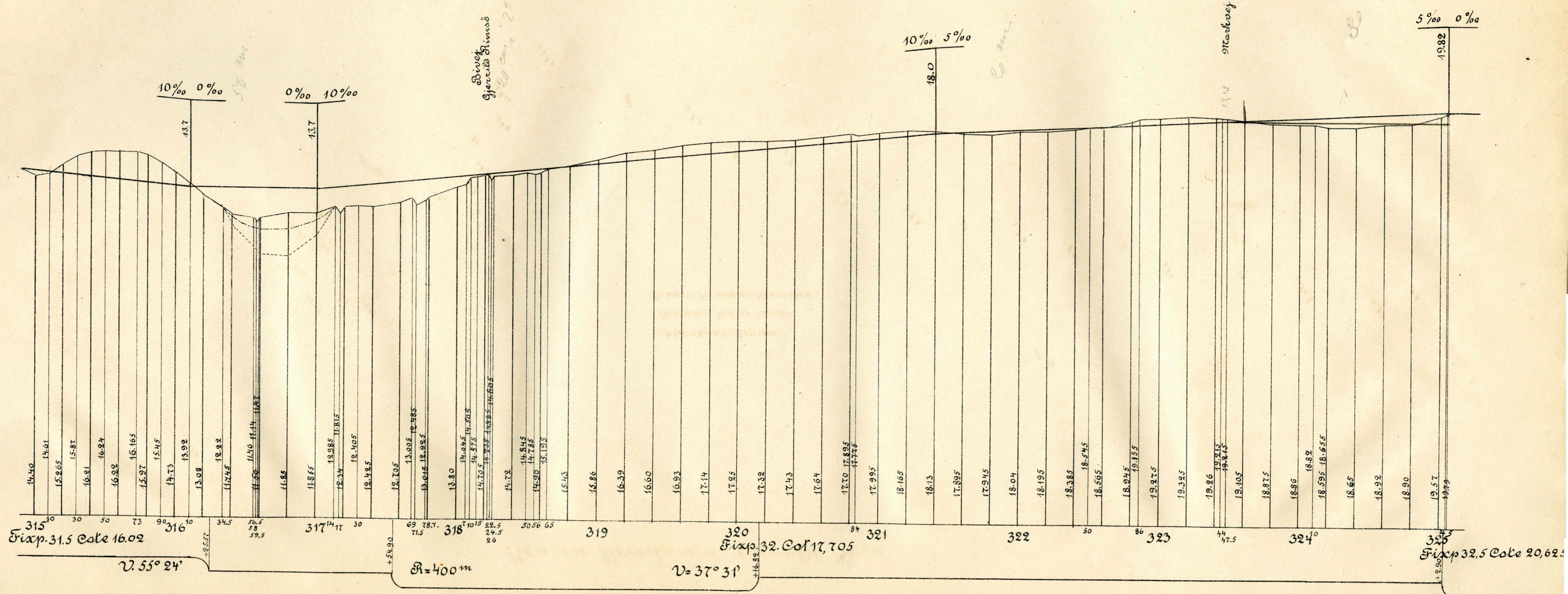

315⁴⁰
Fixp. 31.5 Cole 16.02

$\nu = 55^\circ 24'$

$R = 400m$

$\nu = 37^\circ 31'$

320
Fixp. 32. Col 17.705

325
Fixp. 32.5 Cole 20.625

Divioz
Gjercica Rimso
20 cm, 20 cm, 20 cm

Markovoy

10‰ 0‰

0‰ 10‰

10‰ 5‰

5‰ 0‰

43.7

13.7

18.0

19.82

- 14.40
- 14.61
- 15.265
- 15.87
- 16.24
- 16.22
- 16.165
- 15.97
- 15.45
- 14.73
- 13.92
- 13.08
- 12.32
- 11.745
- 11.40
- 11.14
- 11.17
- 11.85
- 11.855
- 12.385
- 12.34
- 12.385
- 12.405
- 12.425
- 12.705
- 13.005
- 13.485
- 13.045
- 12.925
- 13.80
- 14.045
- 14.505
- 14.705
- 14.575
- 14.785
- 14.90
- 15.195
- 14.72
- 15.43
- 16.86
- 16.39
- 16.60
- 16.93
- 17.14
- 17.25
- 17.32
- 17.43
- 17.64
- 17.10
- 17.895
- 17.725
- 17.995
- 18.165
- 18.13
- 17.895
- 17.945
- 18.04
- 18.195
- 18.385
- 18.545
- 18.565
- 18.945
- 19.155
- 19.275
- 19.325
- 19.26
- 19.312
- 19.345
- 19.105
- 18.875
- 18.86
- 18.82
- 18.595
- 18.655
- 18.65
- 18.92
- 18.90
- 19.57
- 19.79

316

317

318

319

321

322

323

324

325

34.5

56.5

58

59.5

69

78.7

71.5

82.5

24.5

26

50

56

65

87

86

44

47.5

30

86

19.13

30 cm

20 cm

30 cm

58 cm

19.13

30 cm

20 cm

30 cm

58 cm

19.13

30 cm

20 cm

30 cm

58 cm

19.13

30 cm

20 cm

30 cm

58 cm

19.13

30 cm

20 cm

30 cm

58 cm

19.13

30 cm

20 cm

30 cm

58 cm

19.13

30 cm

20 cm

30 cm

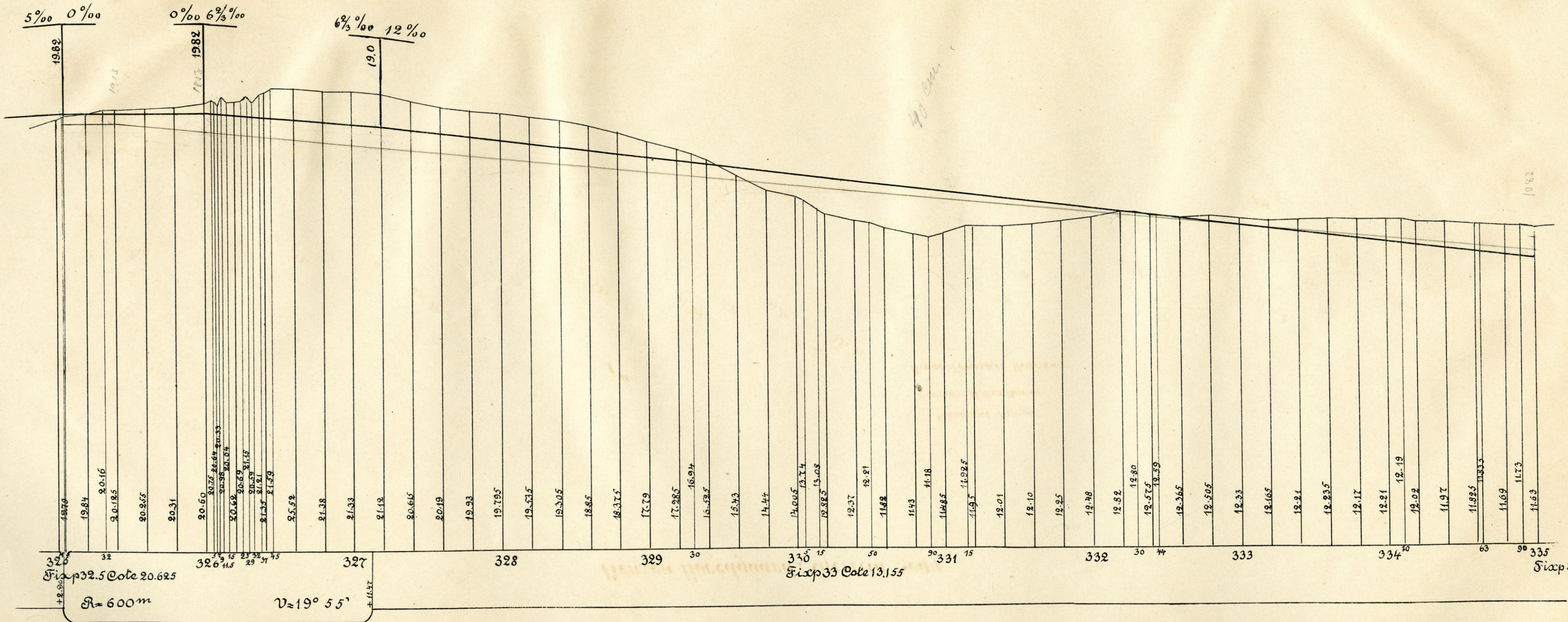

40 mm

Benzon Hovedgaard, Gjerrild Sogn

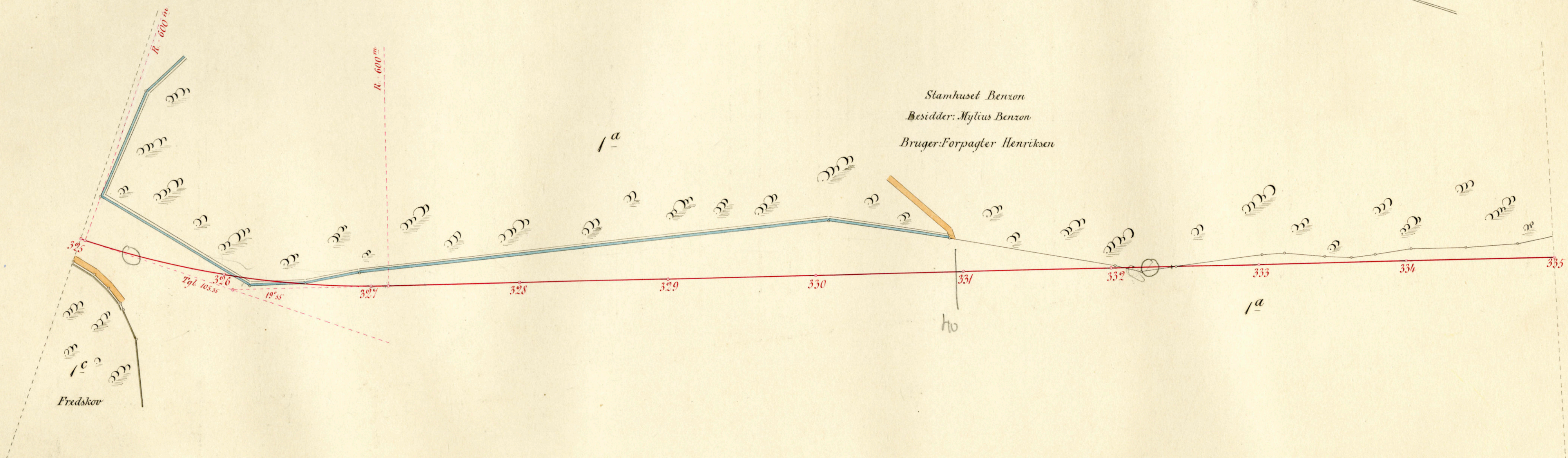
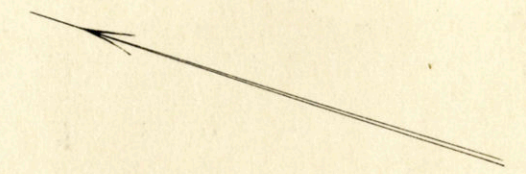

Ճիժ Տինե

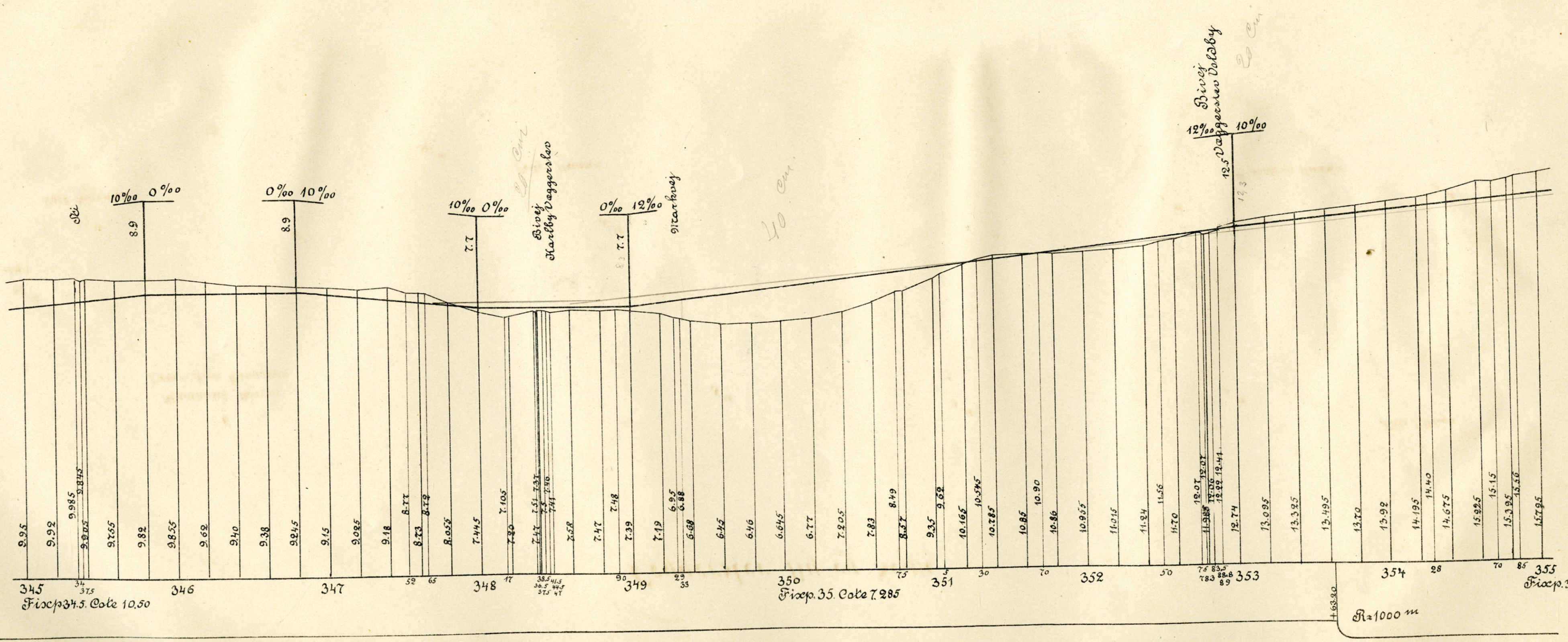

Յիւրջ
Մարկի Վոցցոսև

Յիւրջ

Յիւրջ
Վոցցոսև

40 cm

12.3

Ֆիւք 345. Շոժ 10.50

Ֆիւք 35. Շոժ 7.285

Ֆիւք 355. Շոժ 16.275

R=1000 m

249
247

232
901

100
982

Uggerstev By og Sogn

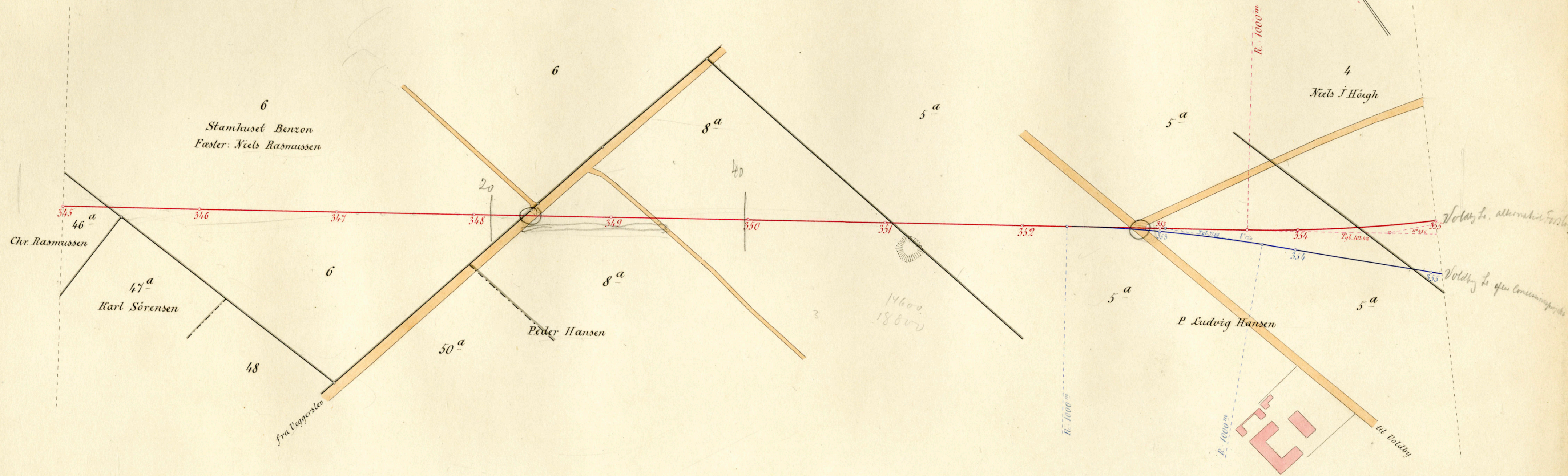

229
911

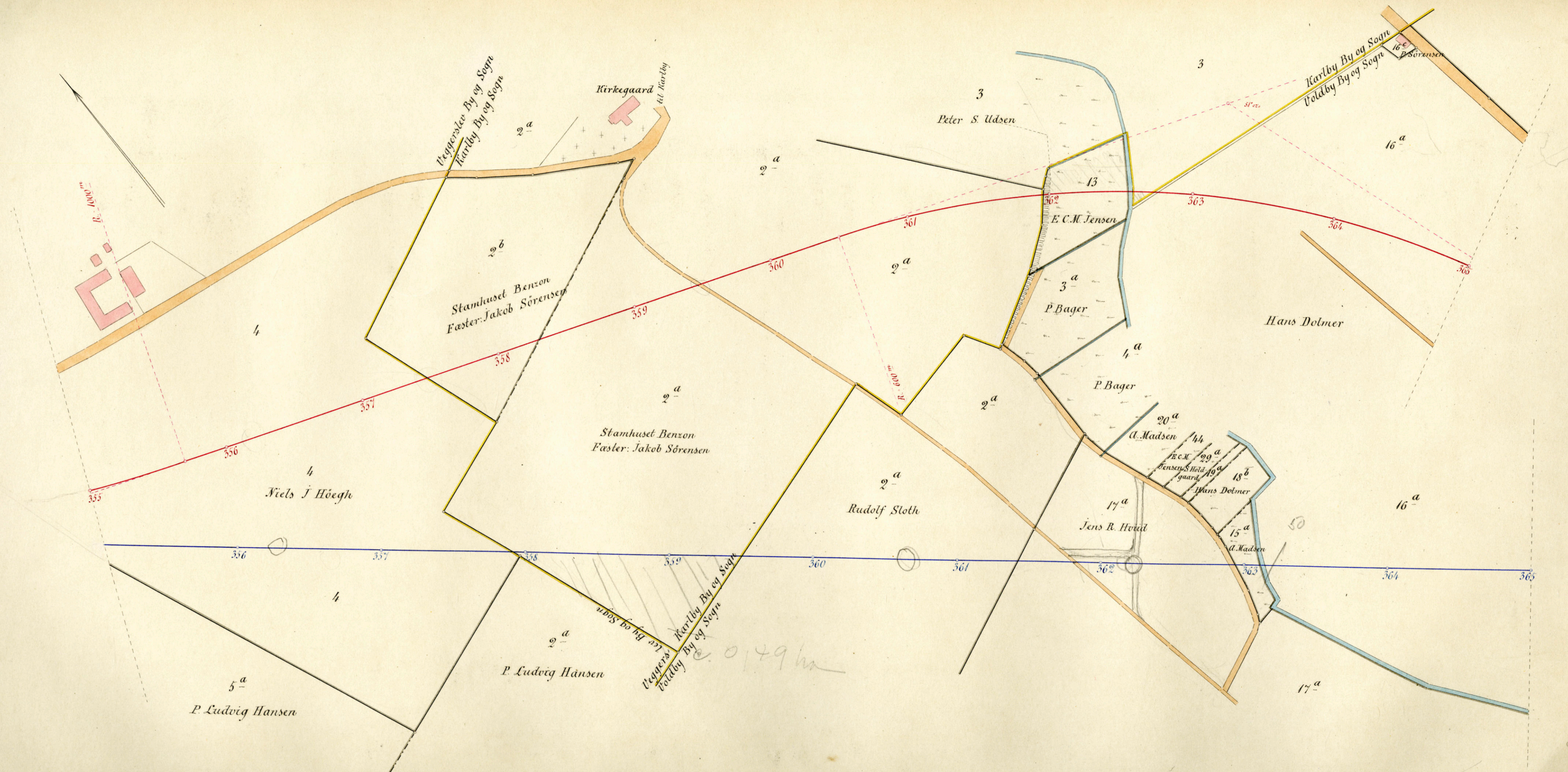

211
926

Gjerild - Grenaa Jernbane.

Stat. 355 ~ 405.

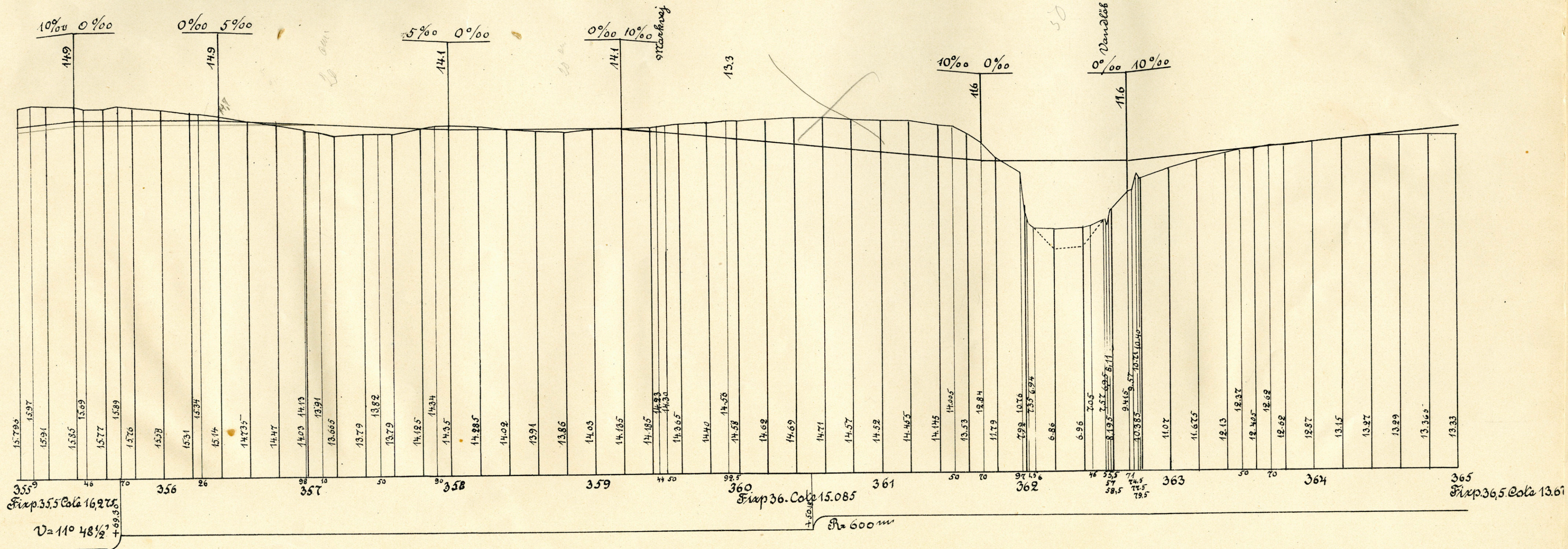

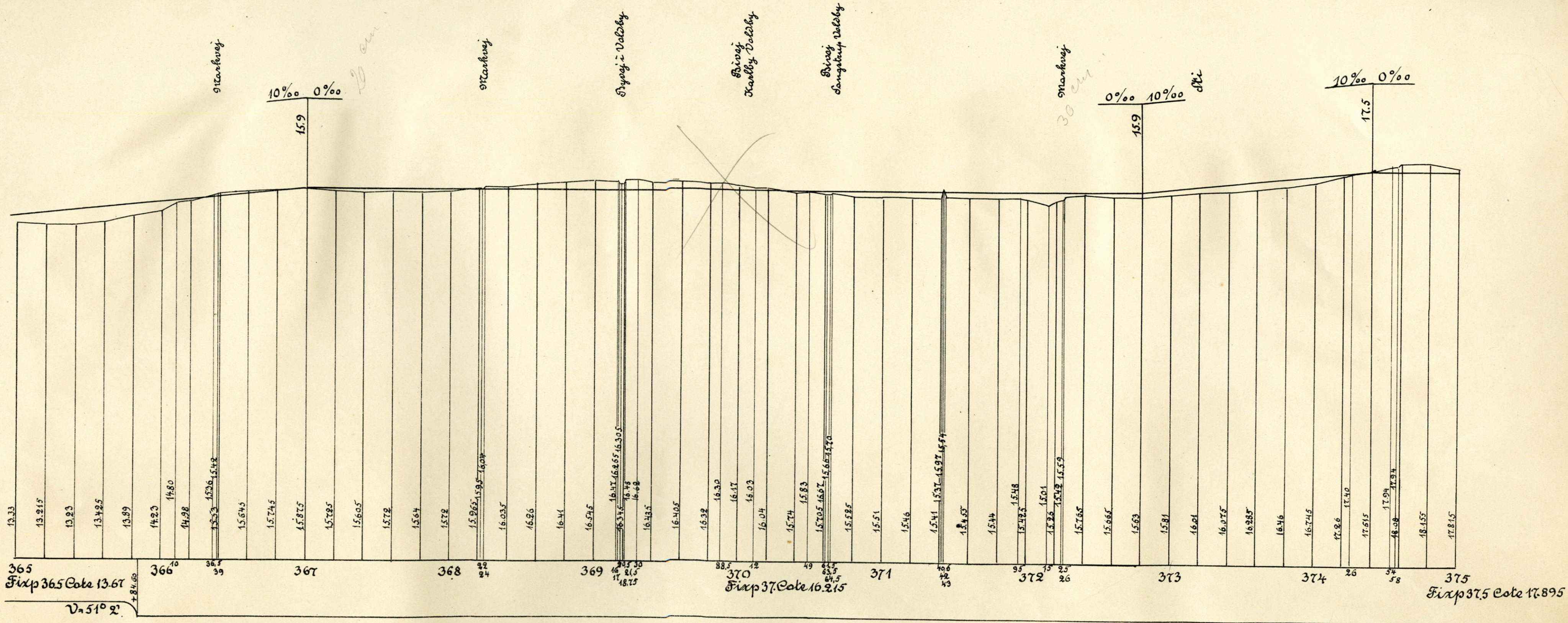

Markvej

Markvej

Dyng i Voldby

Bivog Karby Voldby

Bivog Langstrup Voldby

Markvej

10‰ 0‰

0‰ 10‰

10‰ 0‰

20 cm

30 cm

365
Fixp 365 Cote 13.67

366¹⁰
365³⁹

367

368

369

370
Fixp 370 Cote 16.215

371

372

373

374

375
Fixp 375 Cote 17.895

V = 51° 2'

371
106

Sjerrild - Grenaa Fermbane.

35 laa Linie

Briny
Karby. Vrbky
Mkarbyj

30 cm
Briny
Saugstrup Vrbky

Mkarbyj

10‰ 0‰

16.5

10‰ 0‰

12.0

0‰ 10‰

12.0

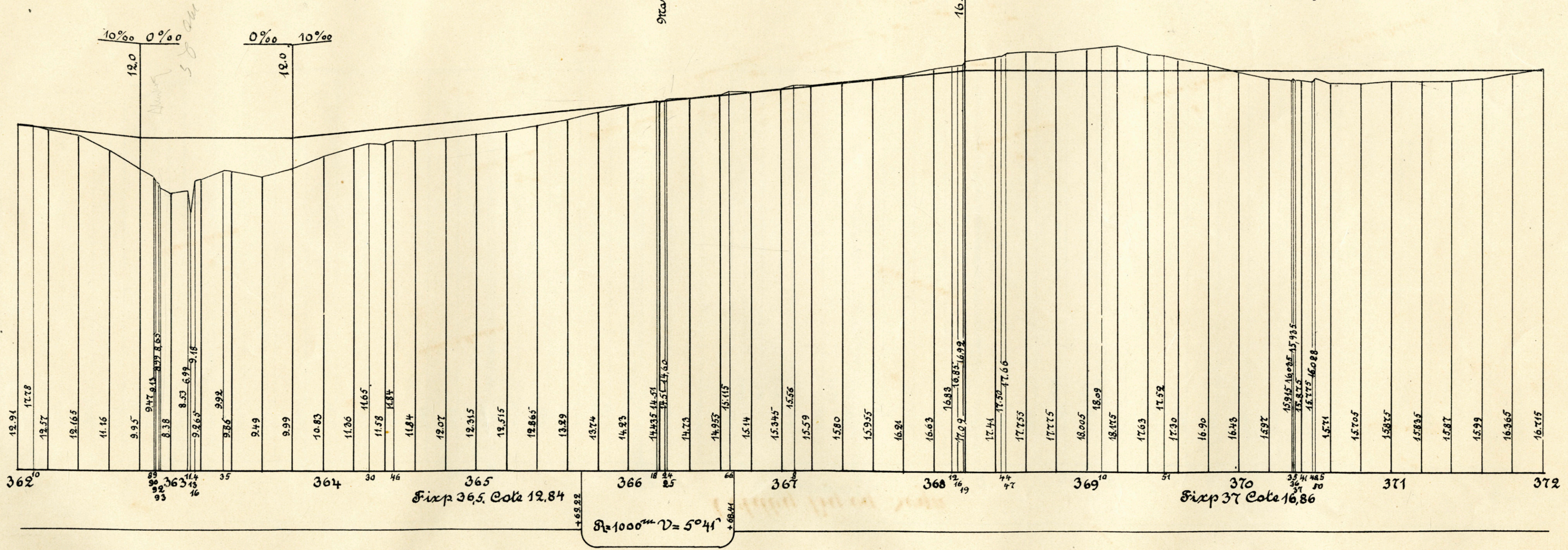

Fixp 36,5 Cote 12,84

Fixp 37 Cote 16,86

$R=1000m$ $V=5^{\circ}41'$

180
191

190
181

179
16b
991

16c
971

Voldby By og Sogn

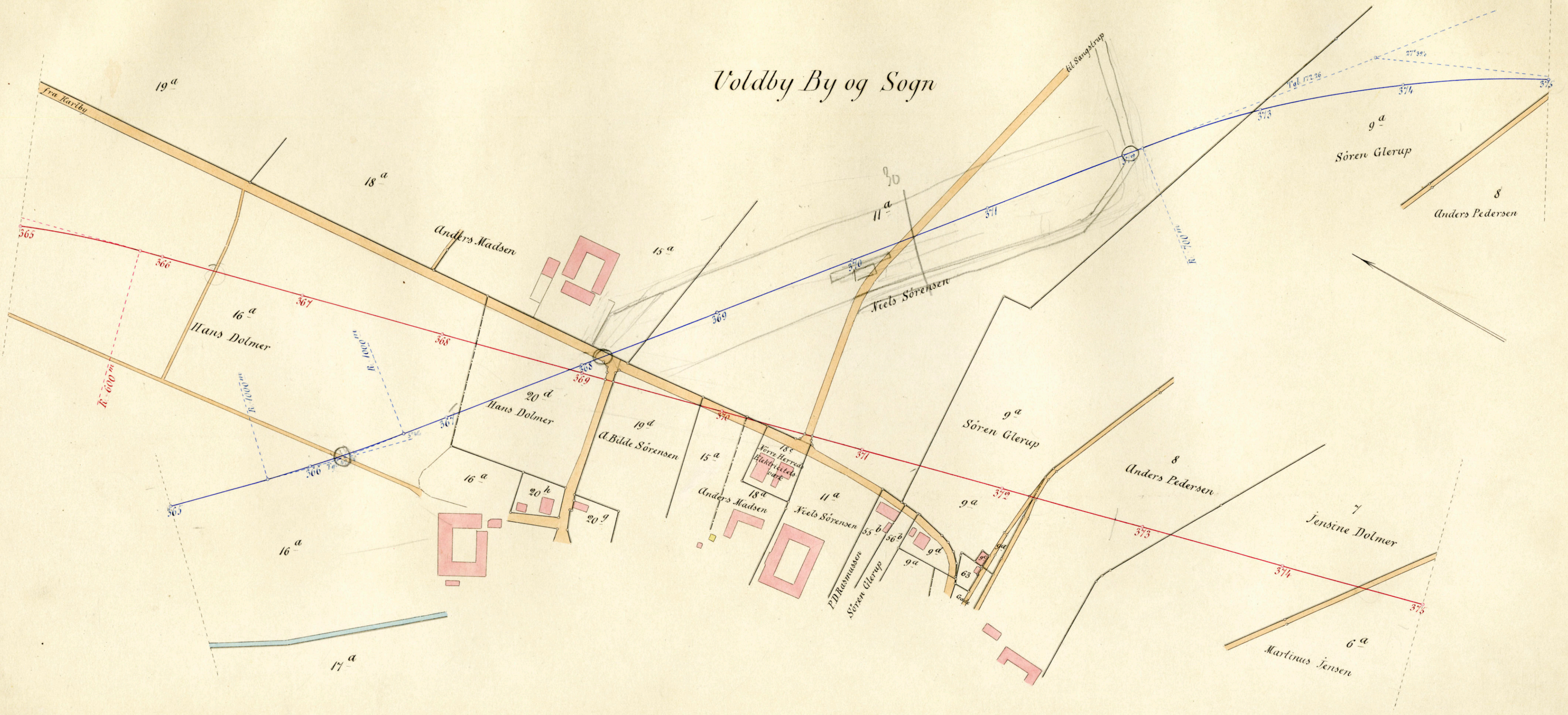

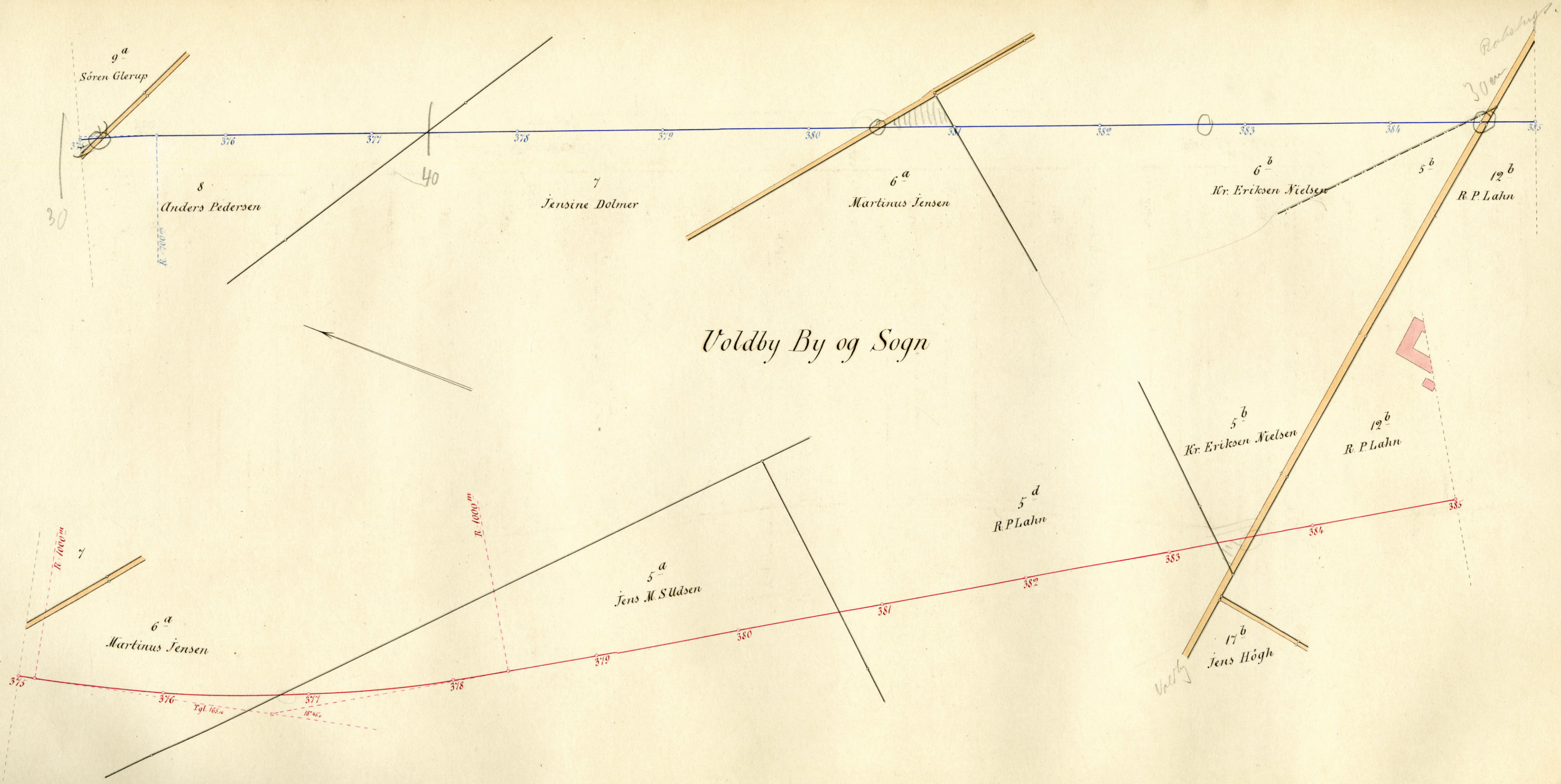

16a
9L1

991
17a

159
981

184
159

Blaa Linie

30 cm

40 cm

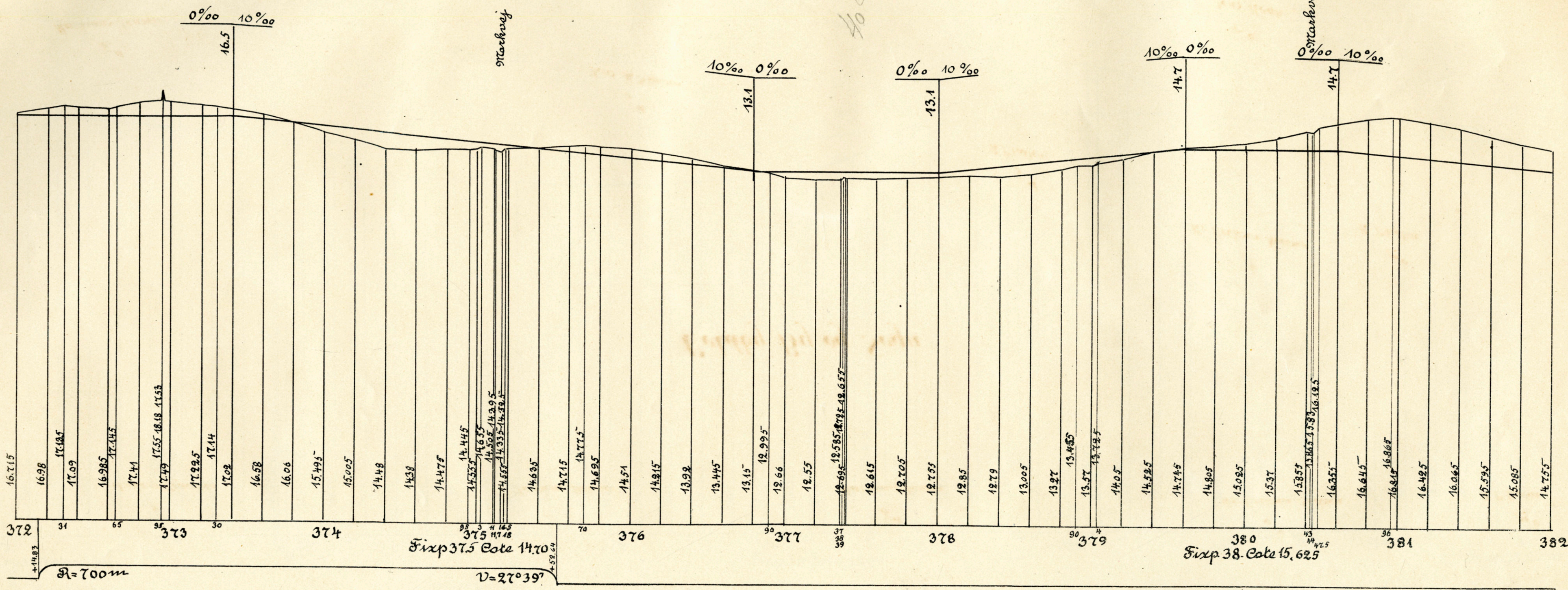

140
961

190
977

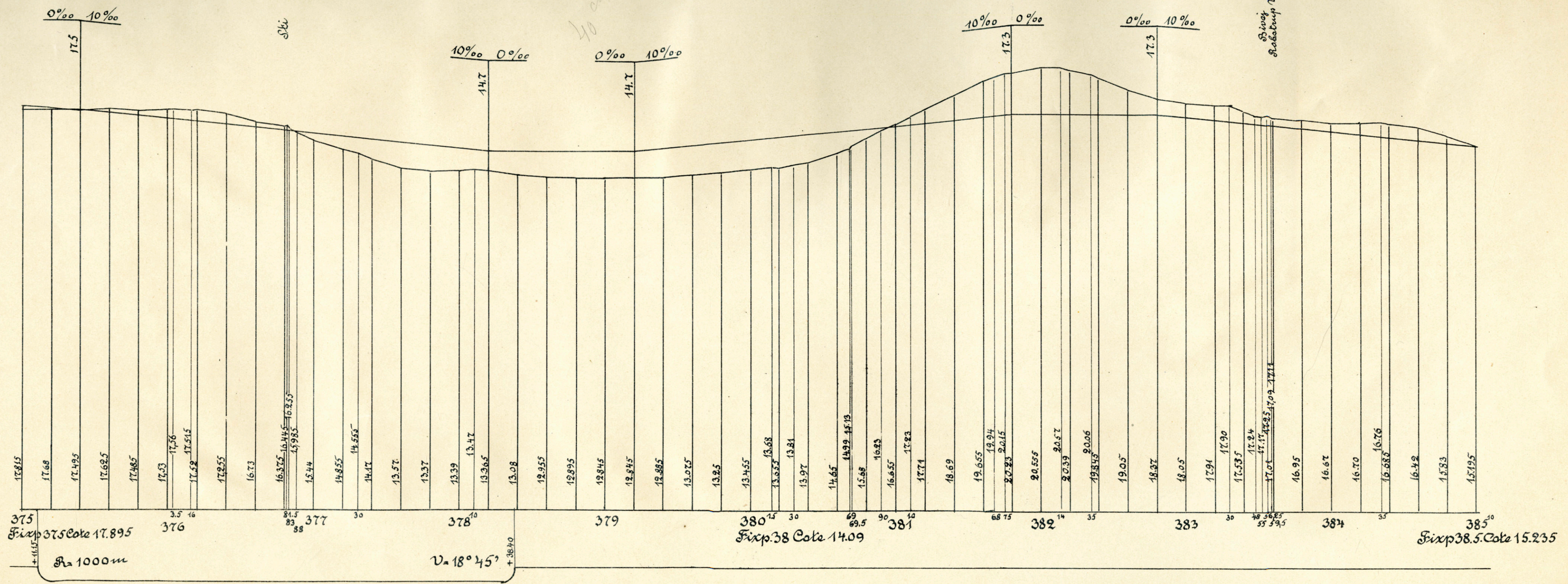

Stk

40 cm

Stroj
Stobrup Nalaby

375
Fixp 375 Cote 17.895

378¹⁰
Fixp 38 Cote 14.09

385¹⁰
Fixp 38.5 Cote 15.235

R = 1000 m

v = 18° 45'

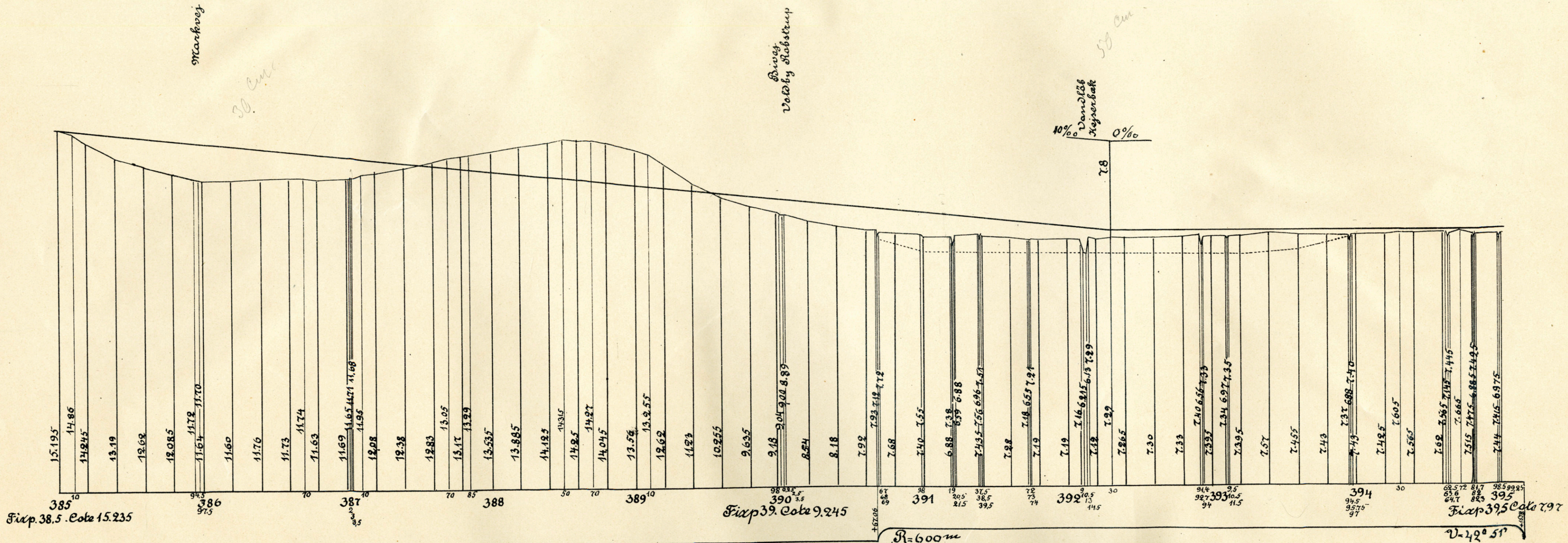

Fixp. 38.5. Cote 15.235

Fixp. 39. Cote 9.245

Fixp. 39.5 Cote 7.97

200
98

Hammelev By og Sogn

395,2000
394,9928
0,2072

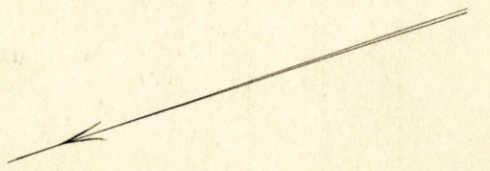
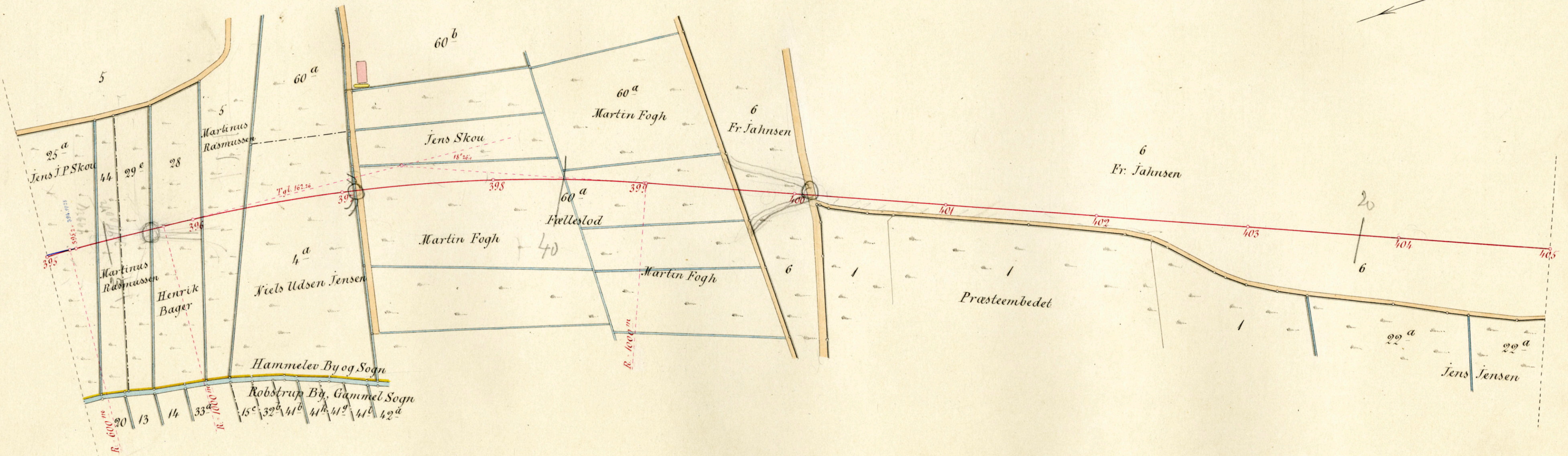

139
99

990
991

246

246

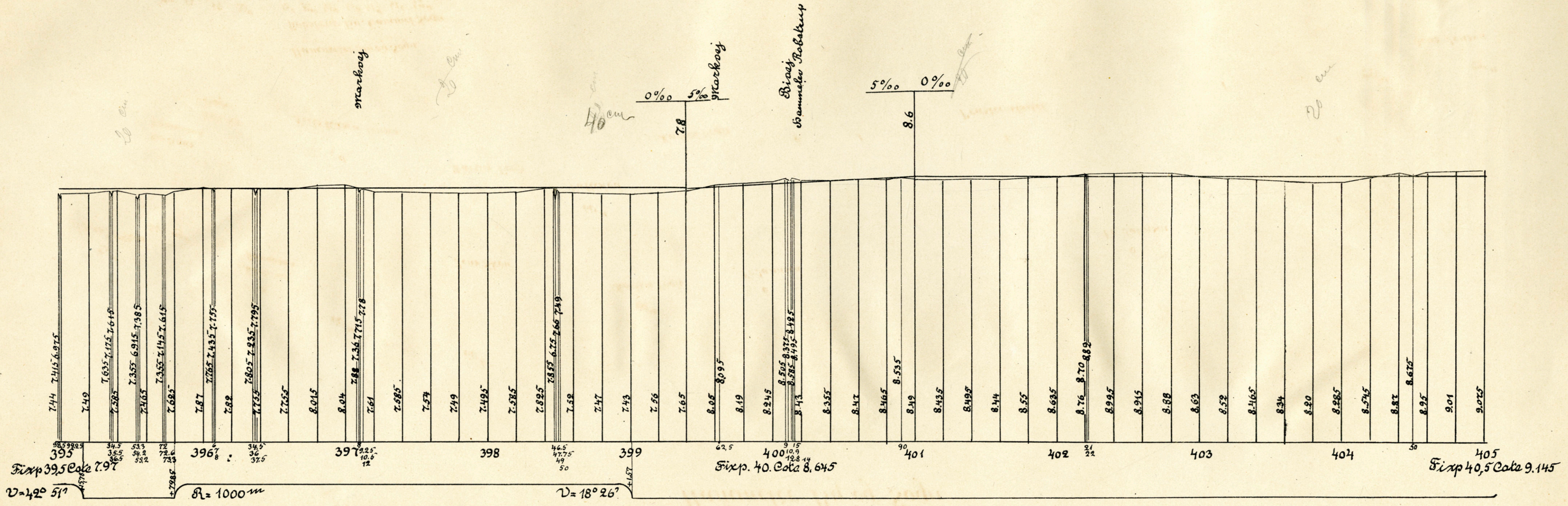

20 cm

starkey

40 cm

starkey

20 cm

Fixp 39,5 Cota 7.97

Fixp. 40. Cota 8.645

Fixp 40,5 Cota 9.145

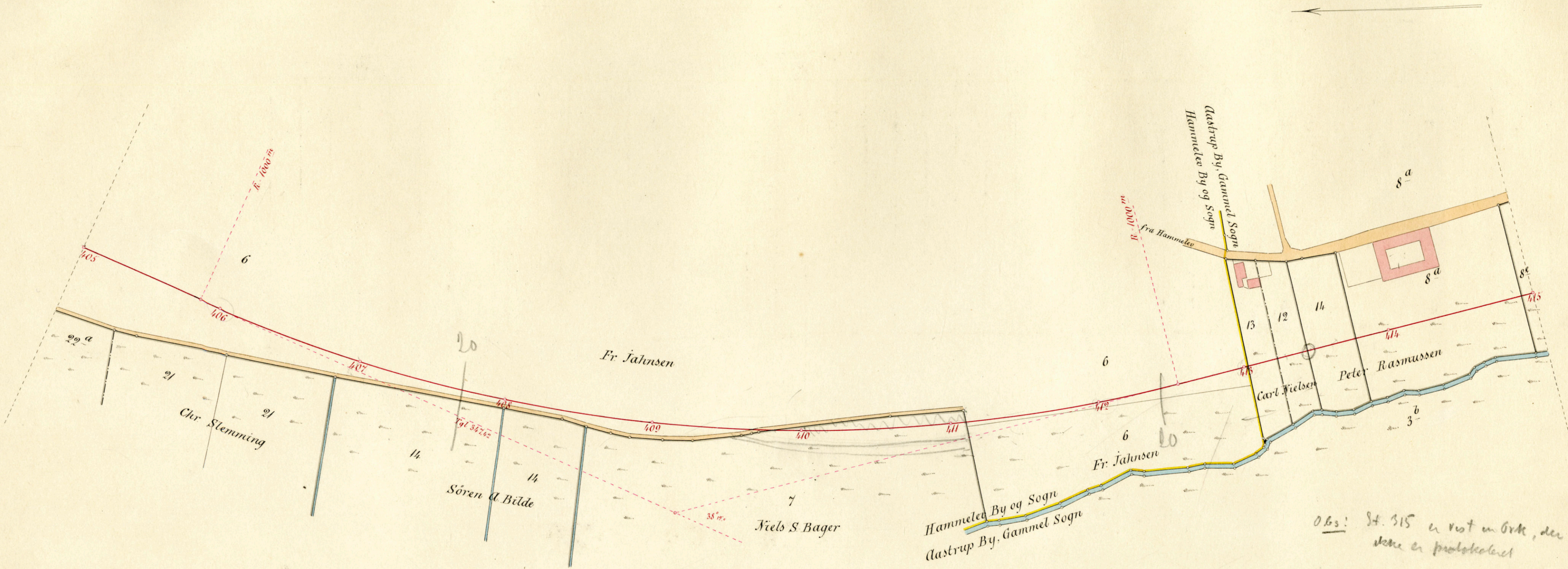

Obs! St. 315 er vist en Ort, der
 ikke er protokollet

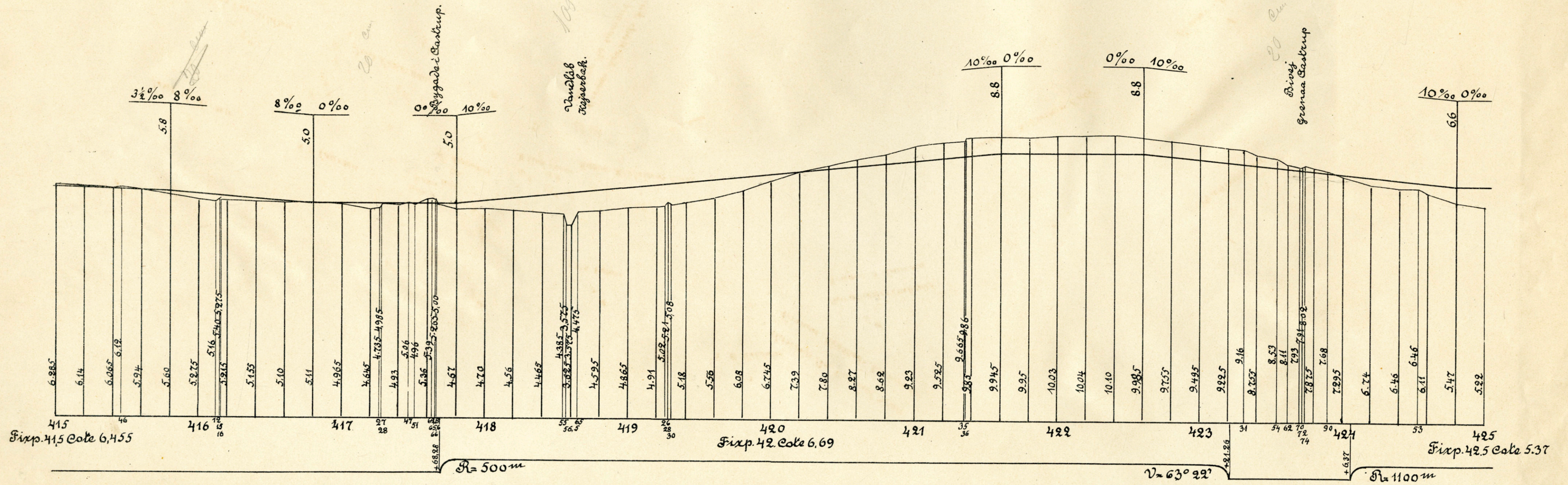

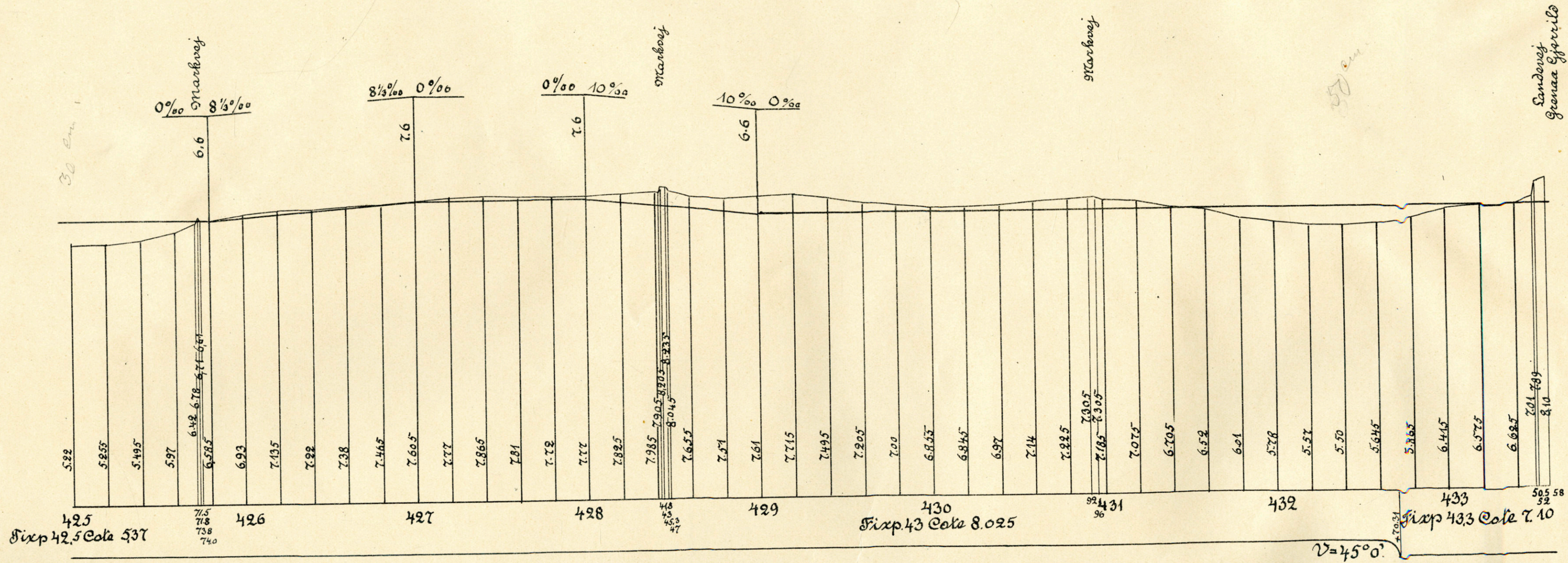

Gjerild - Grenaa Jernbane

Forbindelsesspor med Statsbanen.

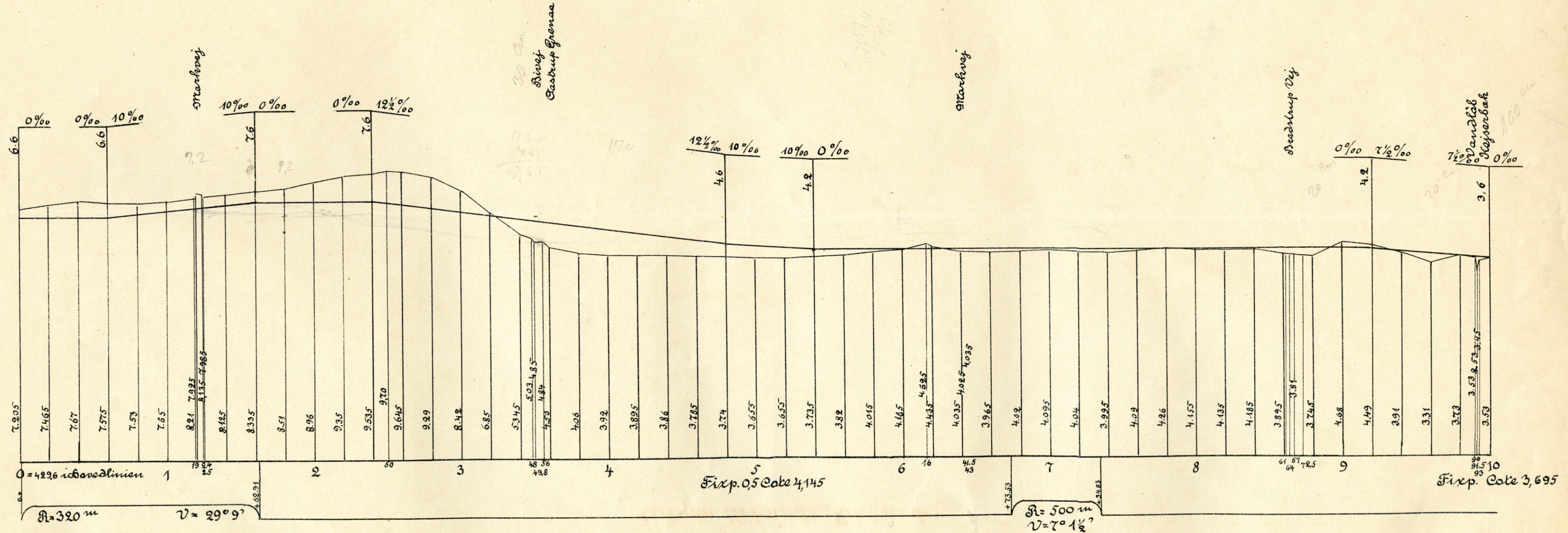

Grenaa Købstads Markjorder

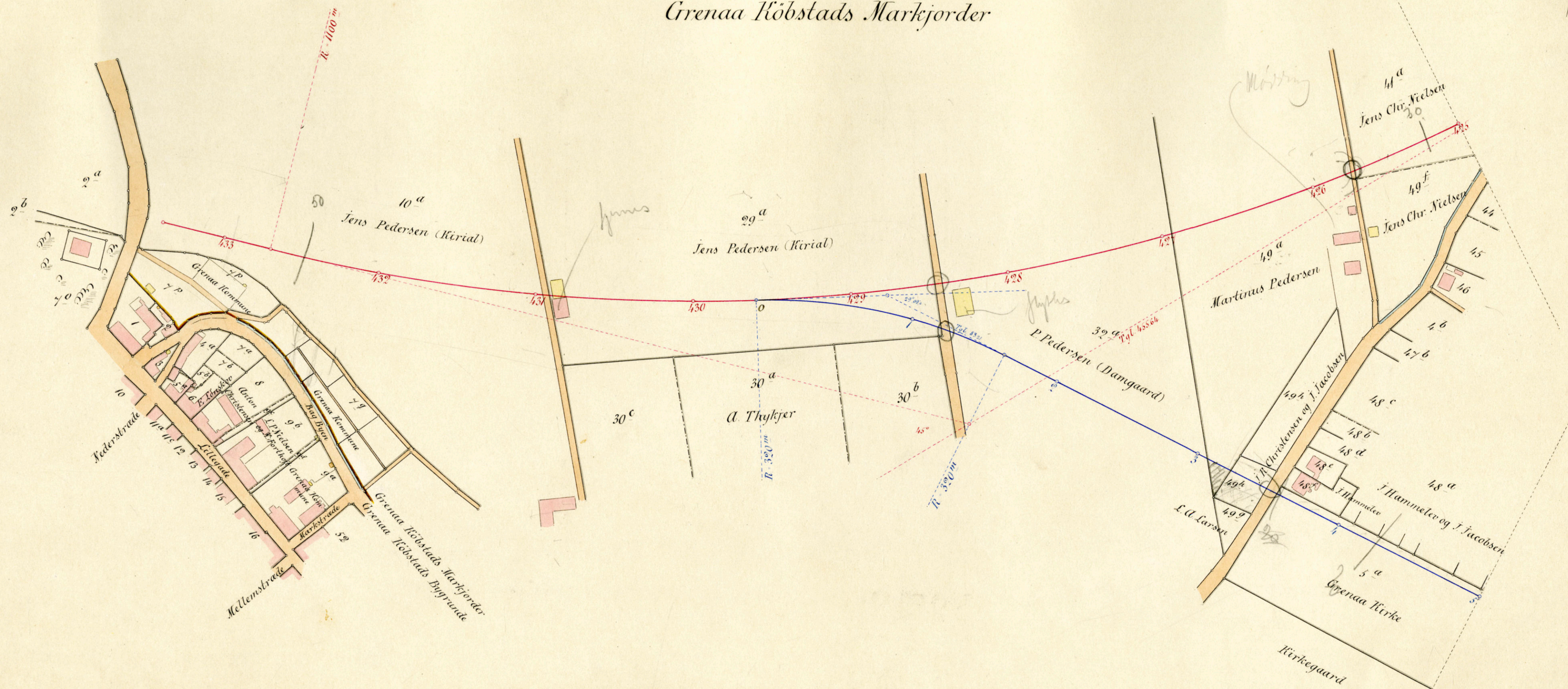

29
918
919

97
31a

Grenaa K obstads Markjorder

Brendstrup By, Gammel Sogn

