

Planbog
for
Aalborg - Hadsundbanen

Station 0-1200.

1:2000.



Aalborg Købstads Grunde.



Aalborg Ladegaards Dorder

Aalborg Købstads Markjorder

Aalborg Købstads Markjorder

Aalborg Ladegaards Jorder



Aalborg Frøbstaads Markjorder

Aalborg Ladegaards Dorder

Gamle Stasseris Bøndelsi Landsogn.

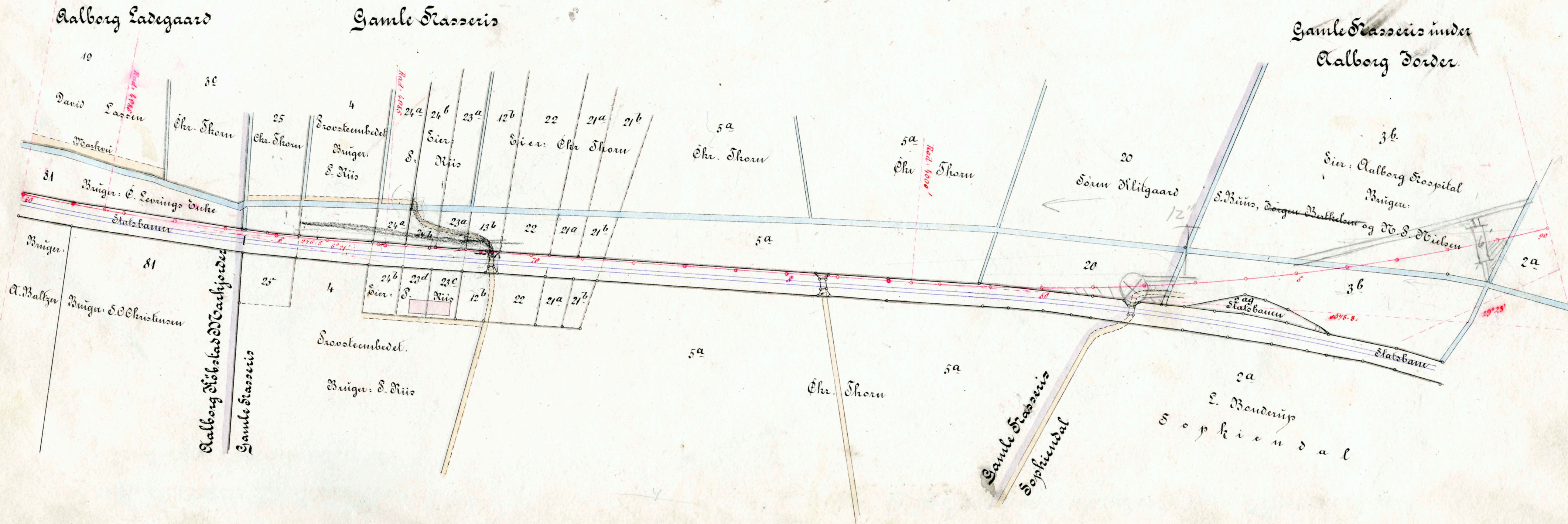

Gamle Grasseris By, Büdolfi
Landsogn, Hornum Herred.

Güg By, Sønder Tranders Sogn, Fleskum Herred.

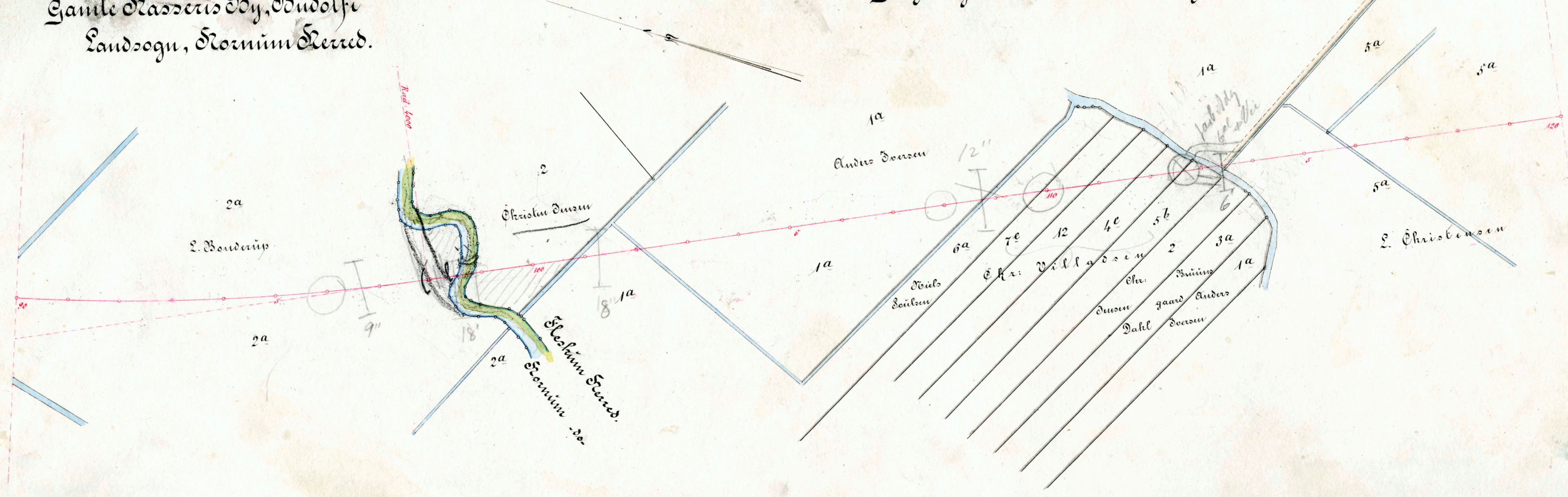

Güing By, Sønder Franders Sogn.

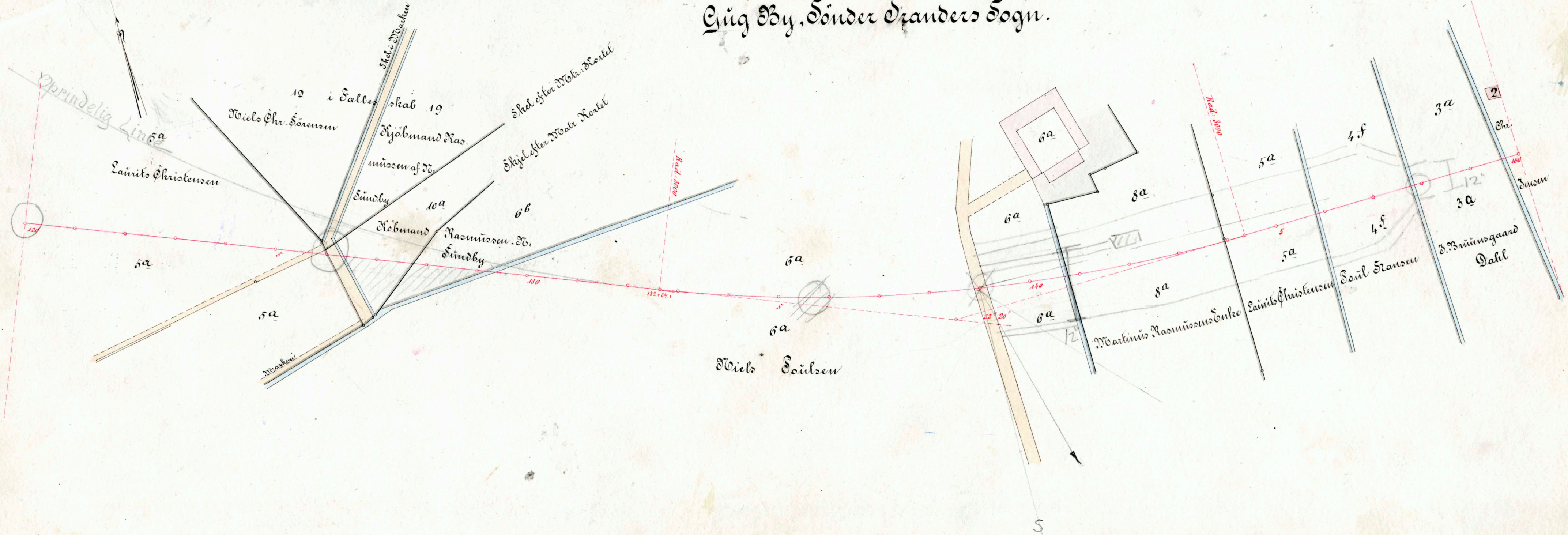

Sønder Brandes Sogn, Gug By

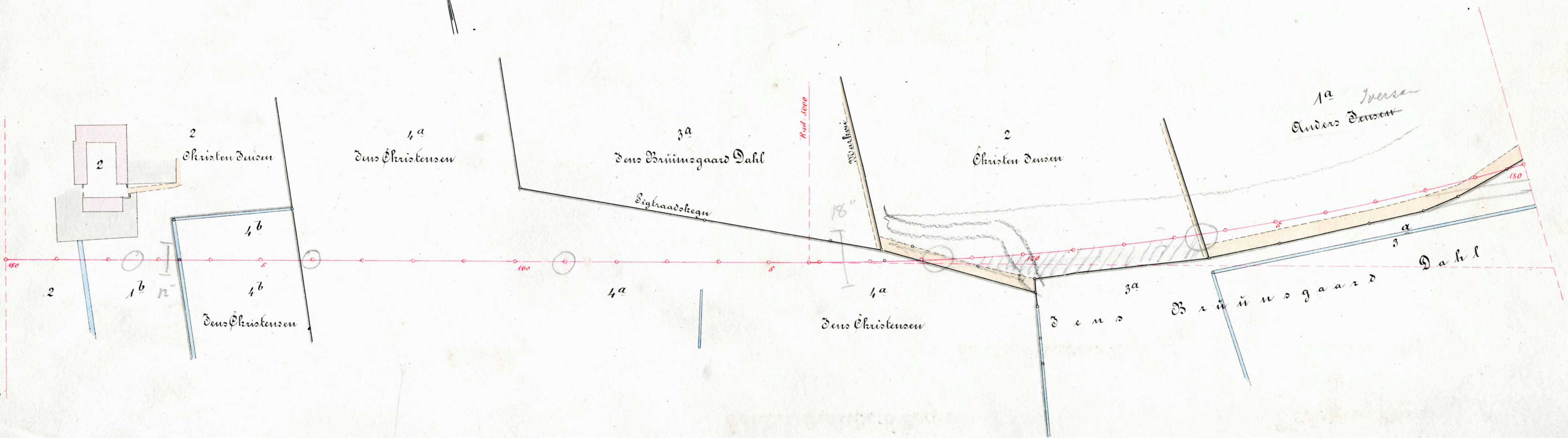

Sönder Franders Sogn.

Hörling Sogn

Güg By.

Sönder Franders By.

Hörling By.

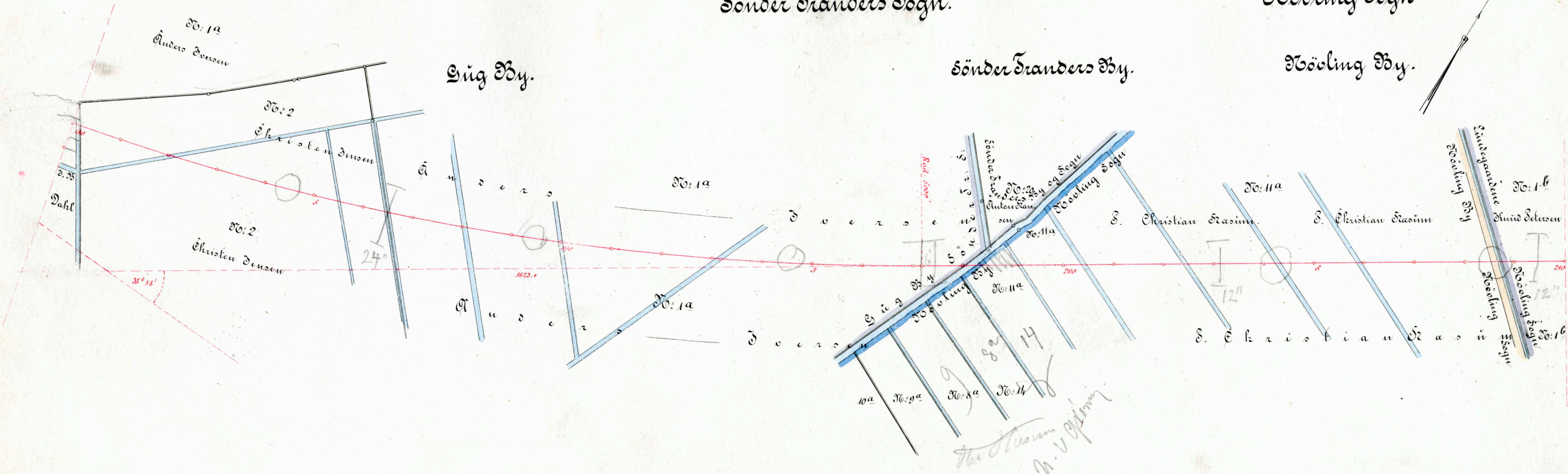

Stöðling Sogn.

Lindegaardene

Gistkrúps By.

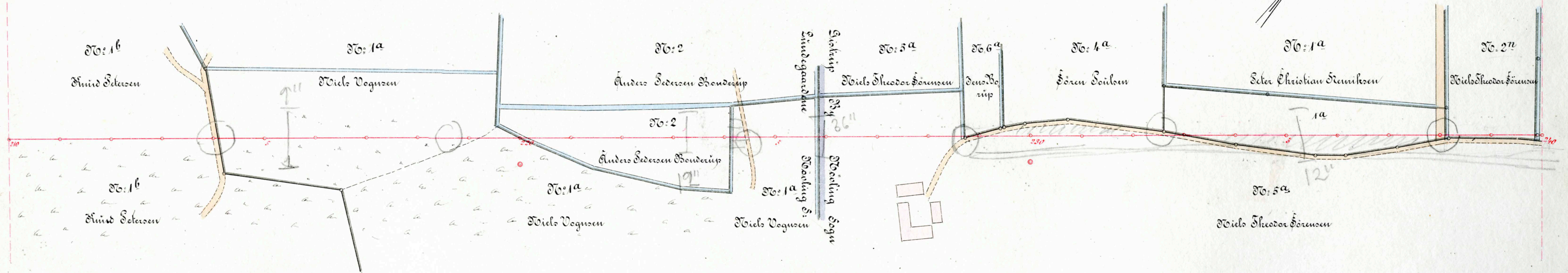

Töölina Sogn.
Sistrup By.

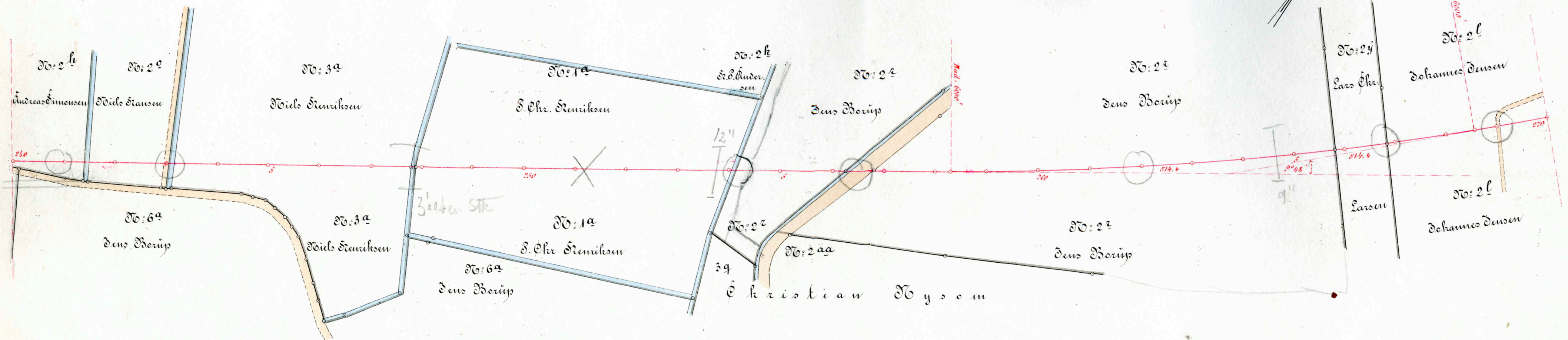

Tööling Sogn.

Gistrup

By

Tööling By.

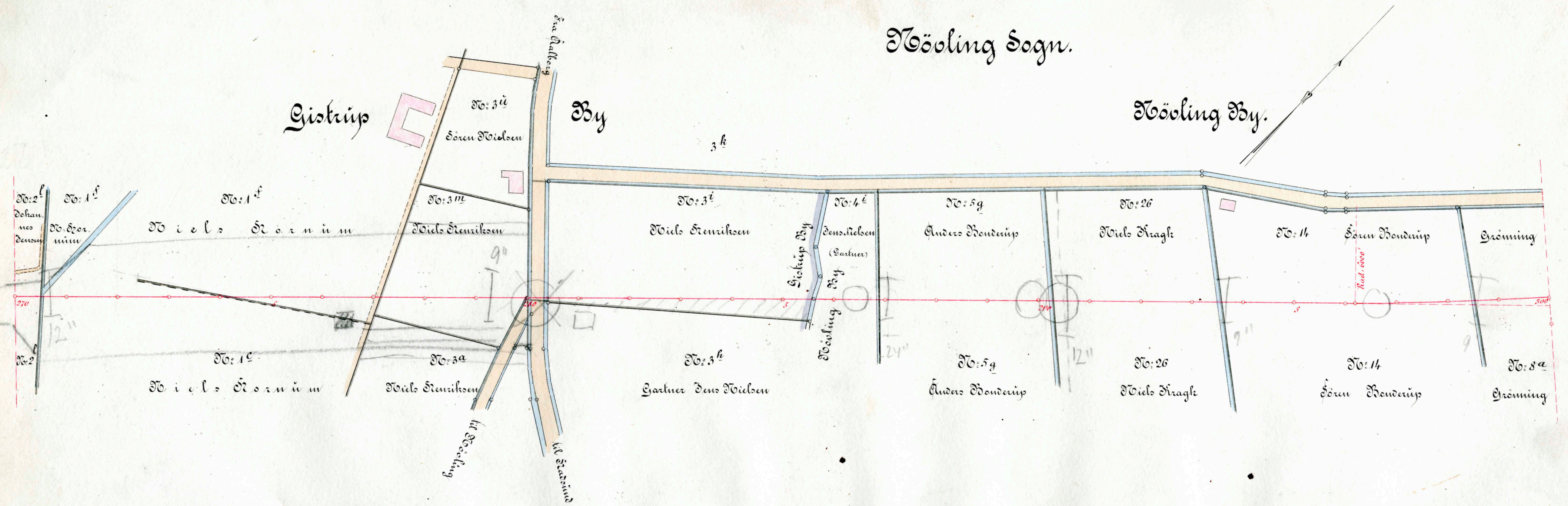

Tööling Sogn.
Tööling By.

Romdrup Sogn.
Romdrup By.

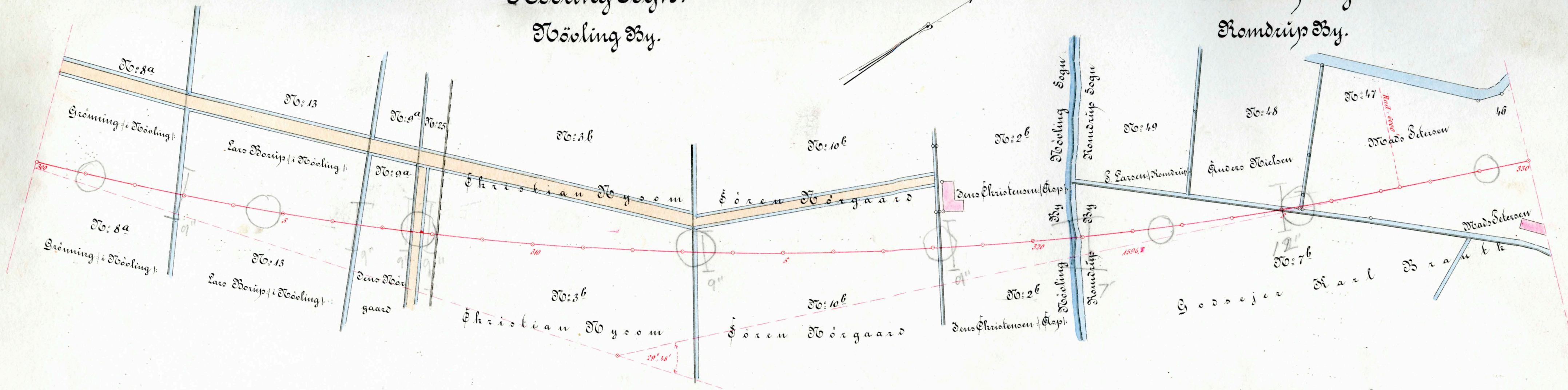

Romdrup Sogn.
Romdrup Dy.

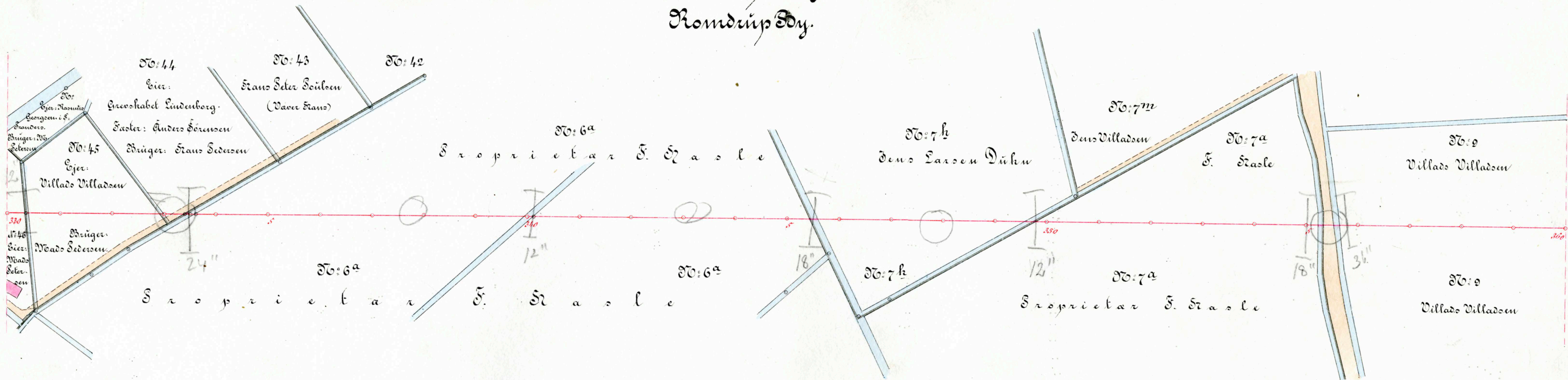

Romdrup Sogn.
Romdrup By.

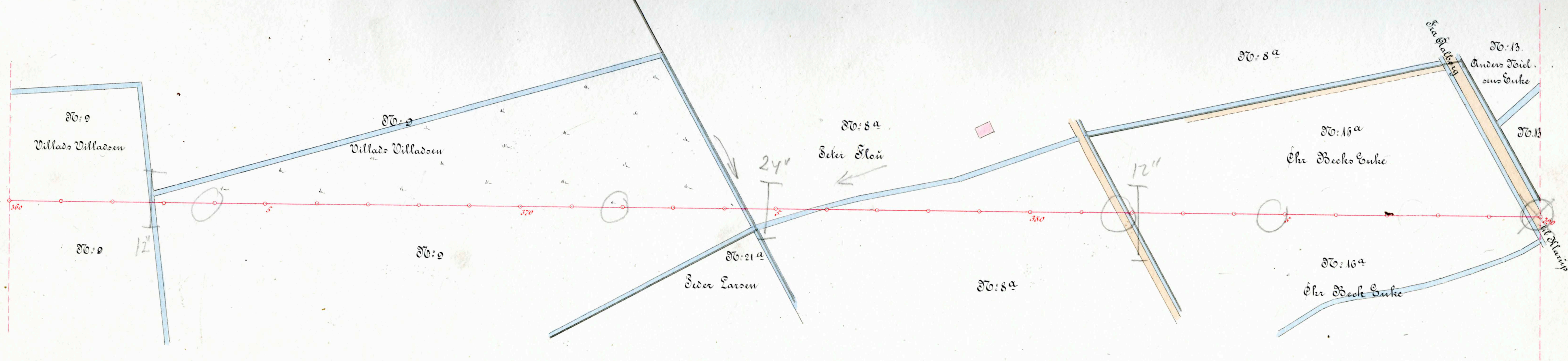

Flomdrup Sogn og By.

Hlarup By og Sogn.

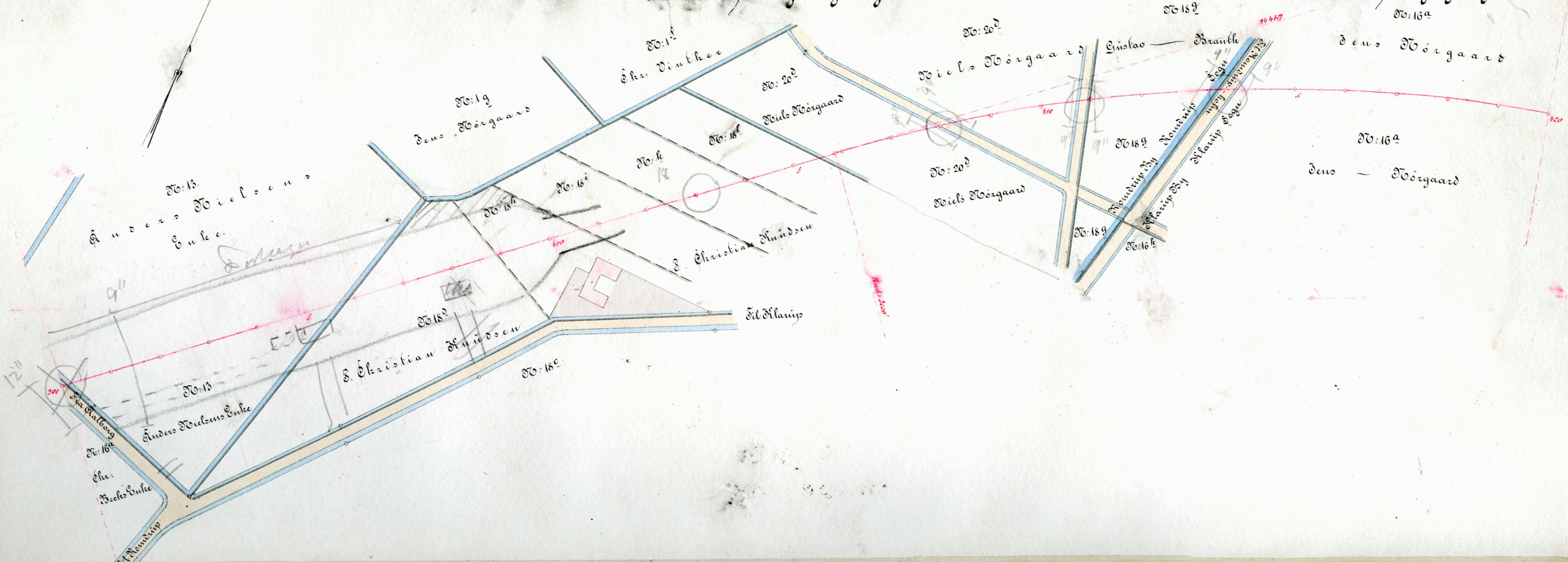

Klarup Sogn.
Klarup By.

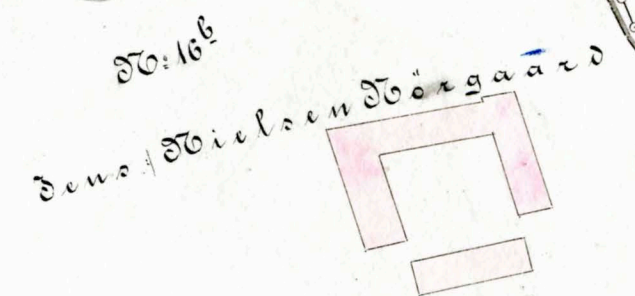
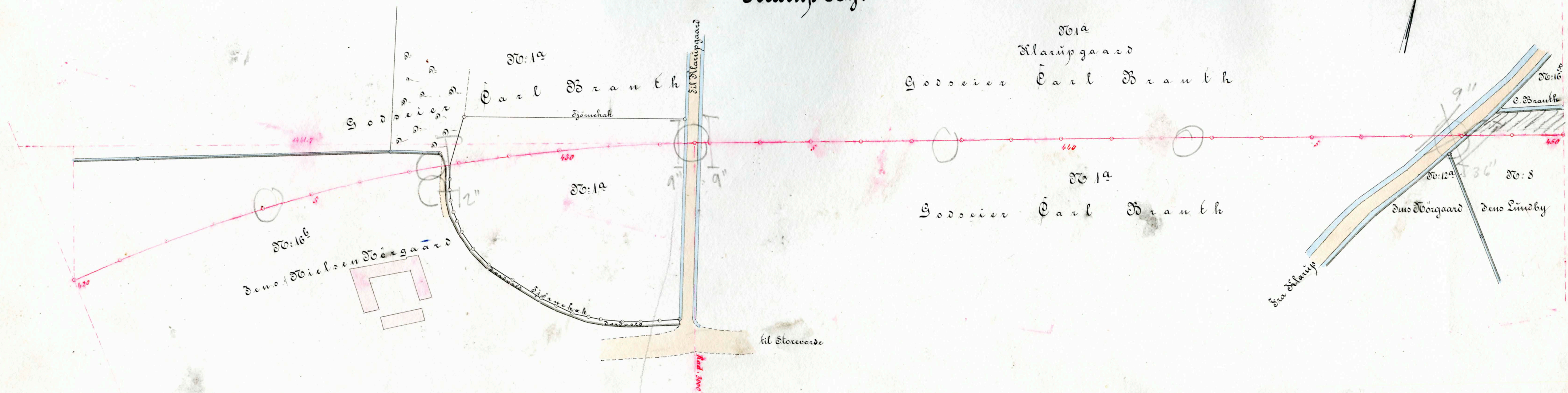

Handwritten note at the bottom of the page:
No. 2. 1851. 1852. 1853. 1854. 1855. 1856. 1857. 1858. 1859. 1860.

Klarup Sogn.
Klarup By.

Storvorde Sogn.
Storvorde By.

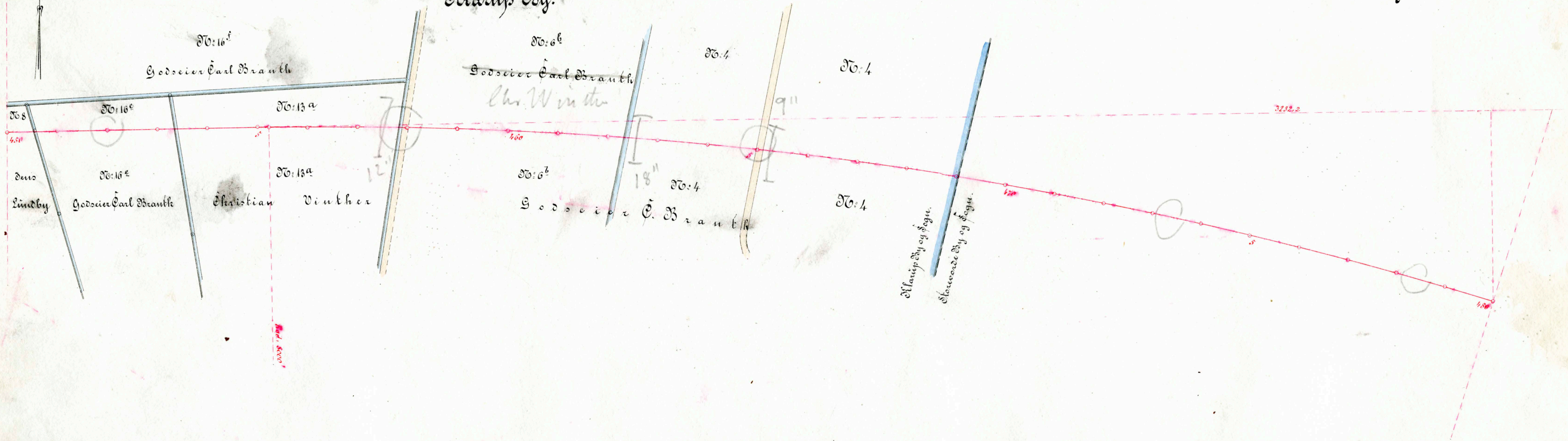

Skovvorde By og Sogn.

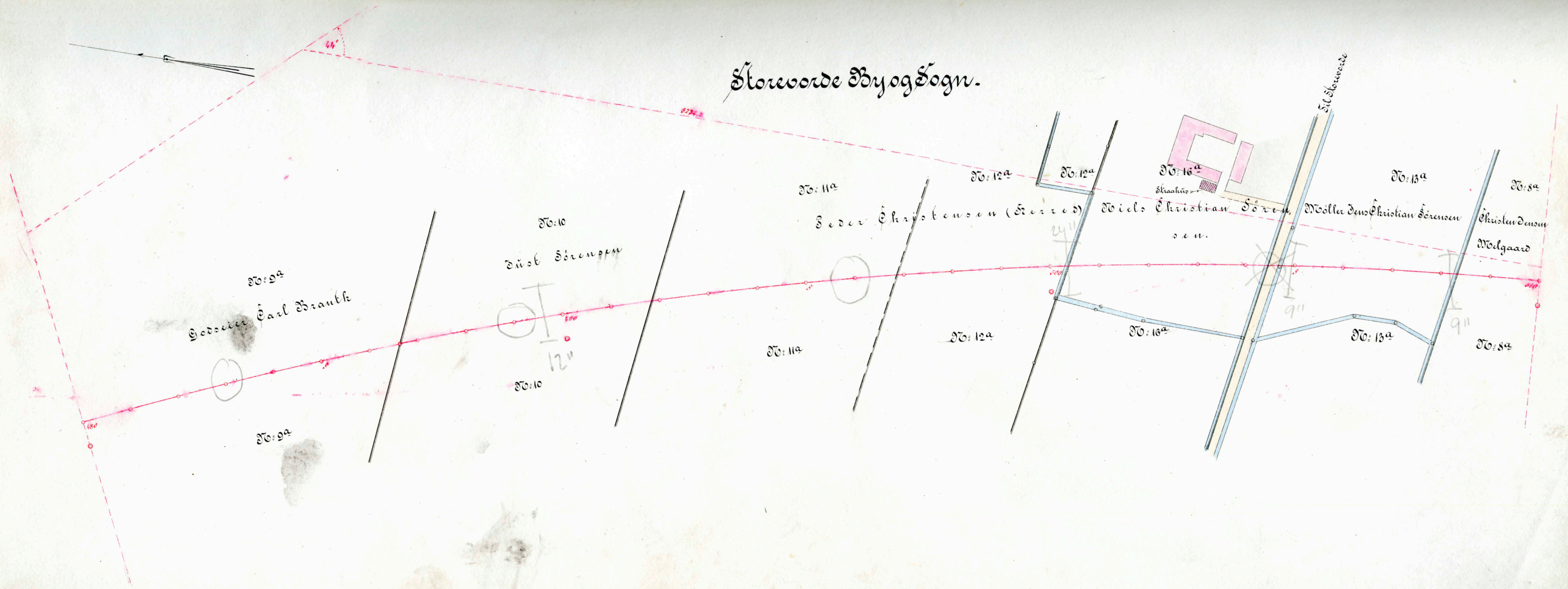

No: 9a
Godseier Carl Brantk

No: 10
Niels Sorenson

No: 11a
Seder Christensen (Sorensen)

No: 12a
Niels Christian Sorenson

No: 13a
Moller den Christian Sorenson

No: 8a
Christen denou Melgaard

Skovvorde

No: 16a

Skaakhus

sen.

No: 10

No: 11a

No: 12a

No: 16a

No: 13a

No: 8a

No: 9a

44°

422

480

410

12"

24"

9"

9"

Skorevorde By og Sogn.

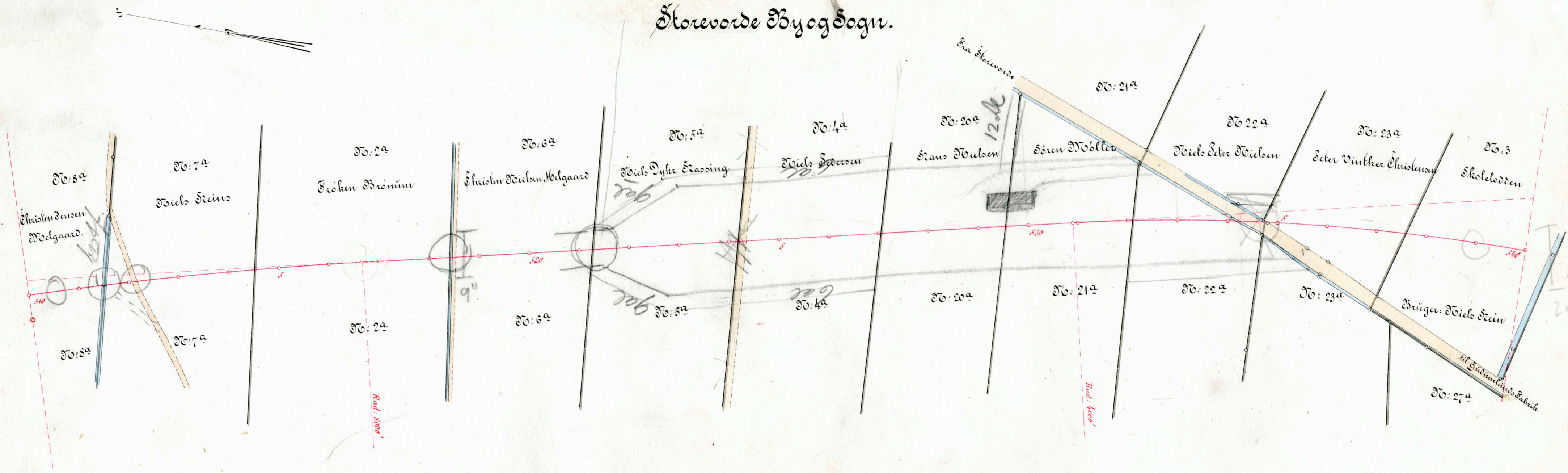

Storevorde By og Sogn

Seilflod By og Sogn.

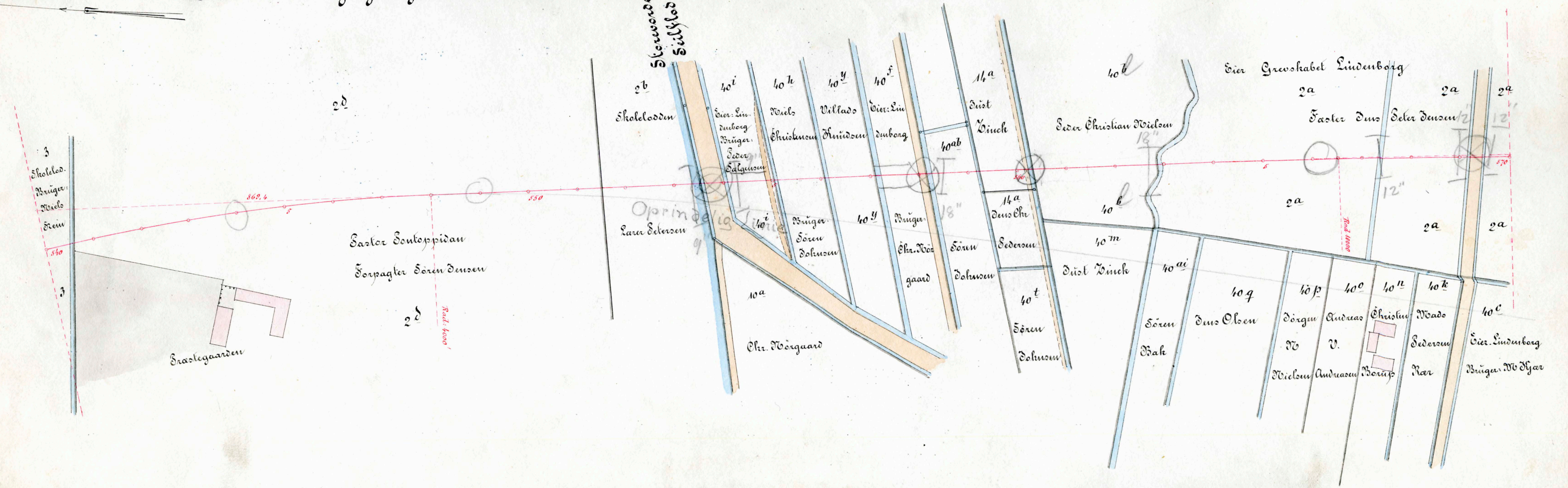

Seilskod By og Sogn.

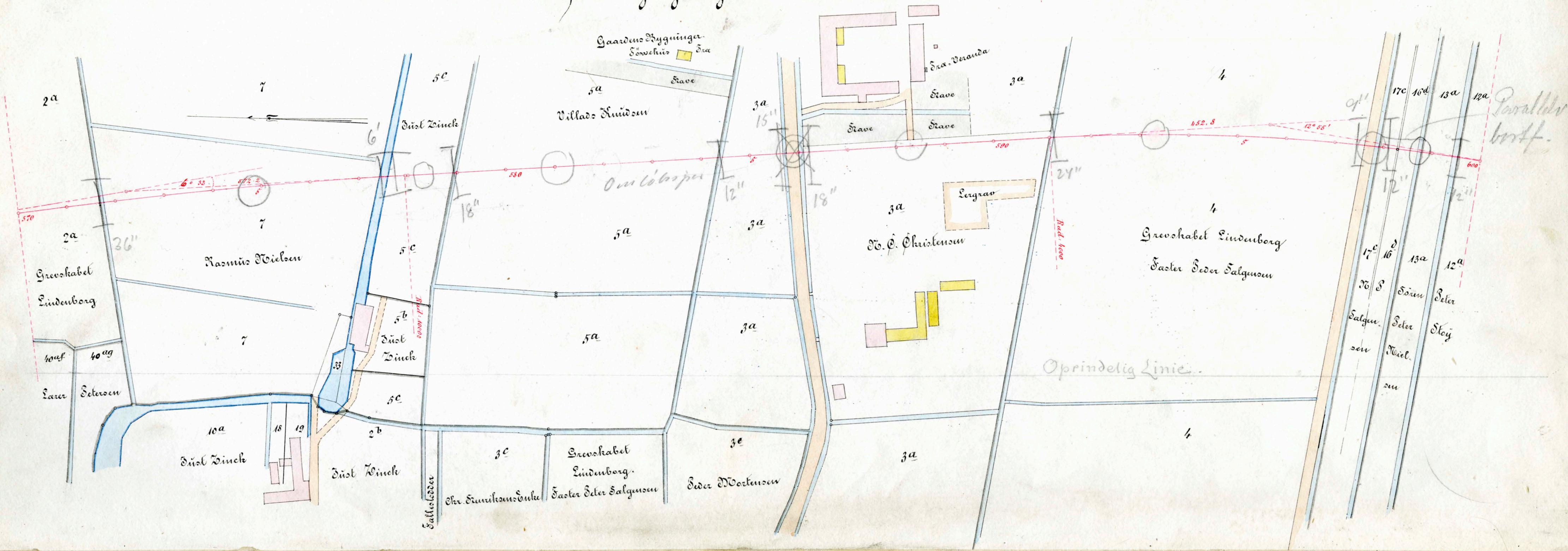

Seilflod By og Sogn.

Lillevorde By og Sogn.

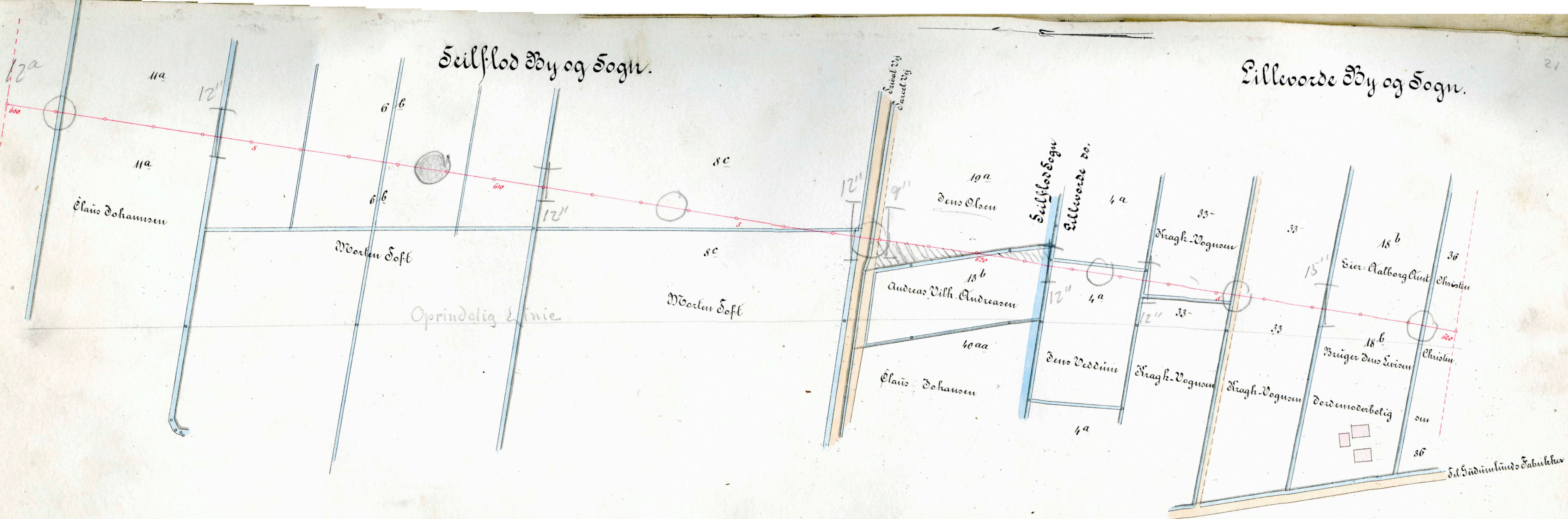

Det Gudsminnes Fabulker

Gudum By og Sogn.

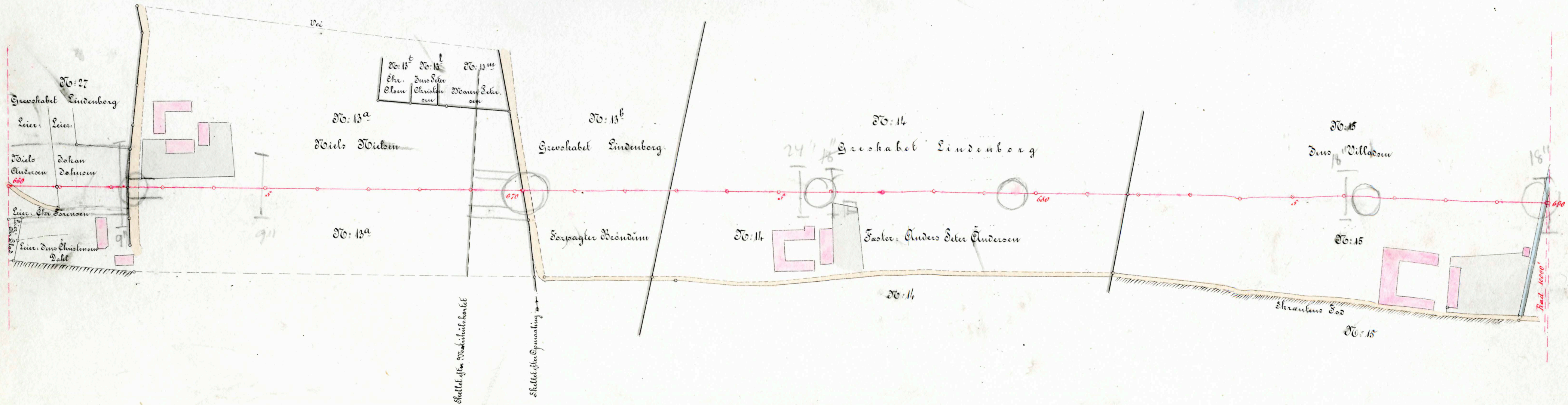

Gudim By og Sogn.

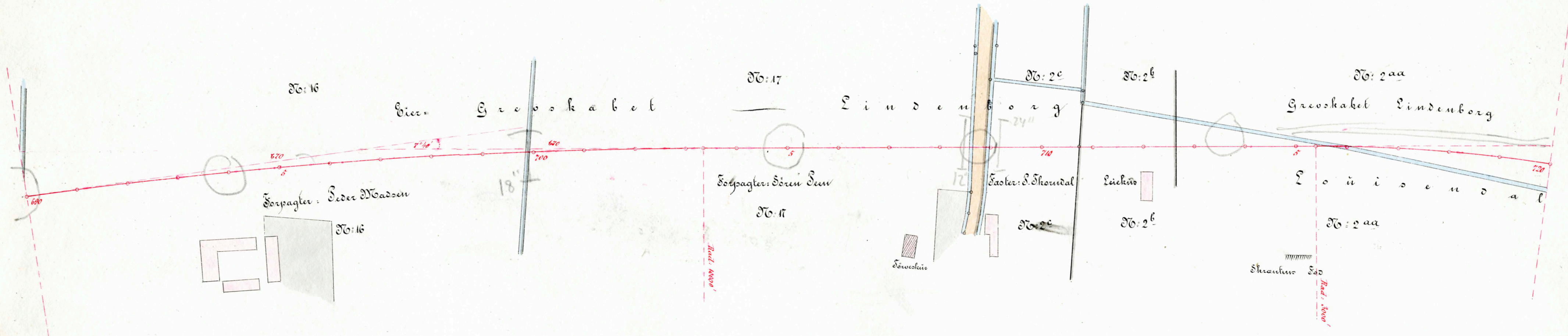

Güdim Sogn.
Løuisendal.

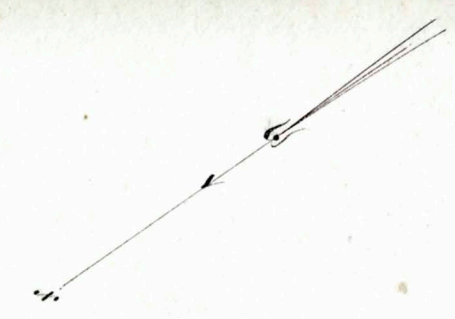
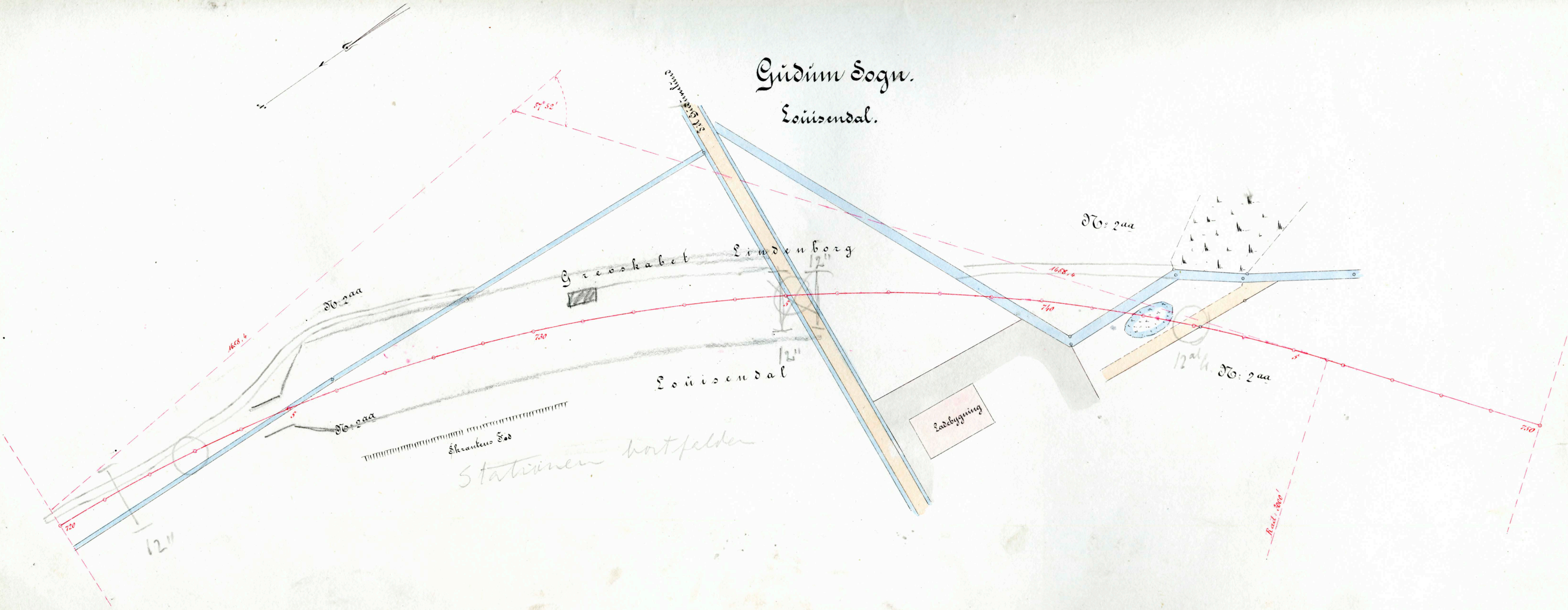

87° 52'

1658.4

D.O. 2aa

Greoskabet Lindenberg

D.O. 2aa

1678.4

730

740

Løuisendal

12' 1/2 D.O. 2aa

D.O. 2aa

Stationen hortfelder
Skranterus Sad

Ladbygning

720

12''

750

Red. 1899

Gudim Sogn.

Louisendal

Gudim By.

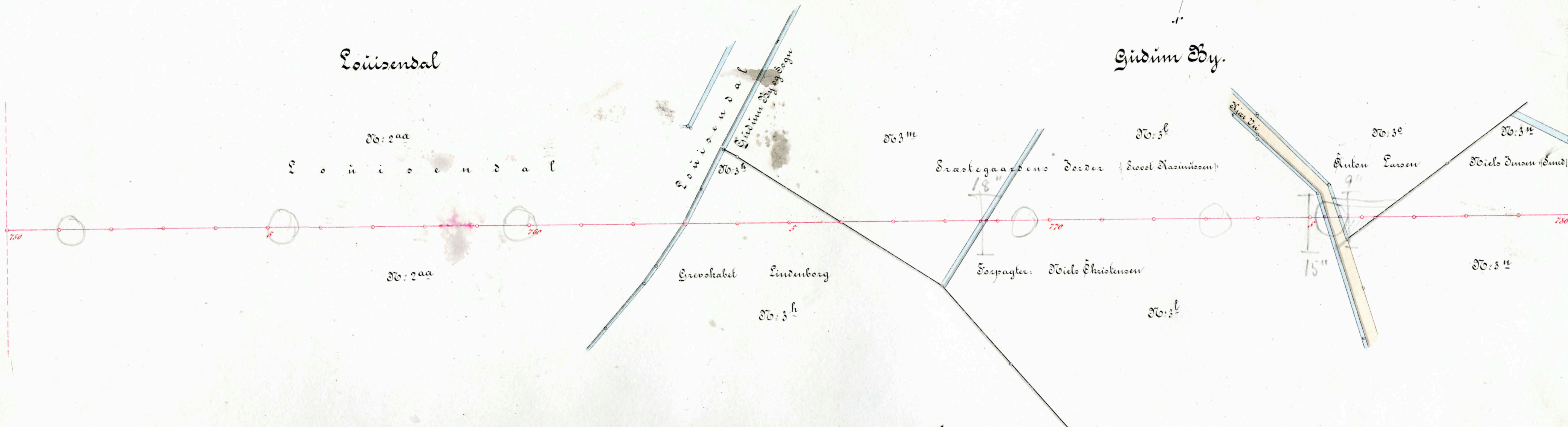

Gjinderup Sogn, Vaarok By.

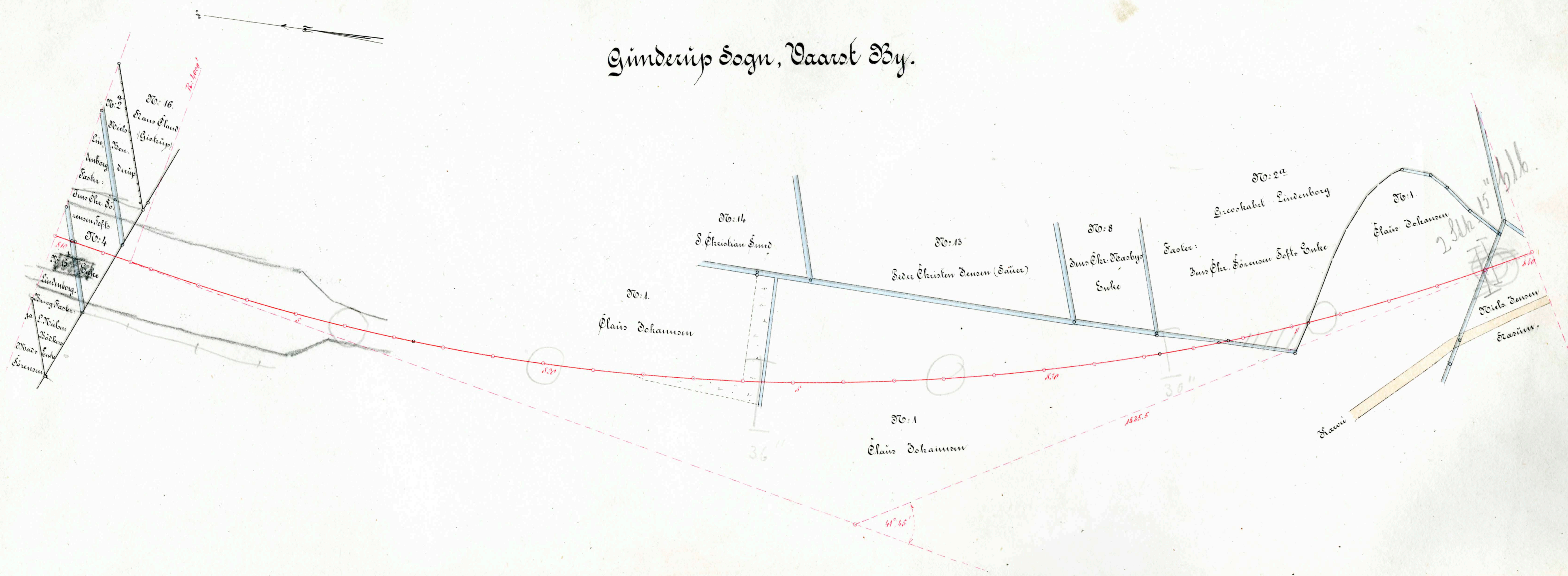

Gjunderup Sogn, Vaarst By.

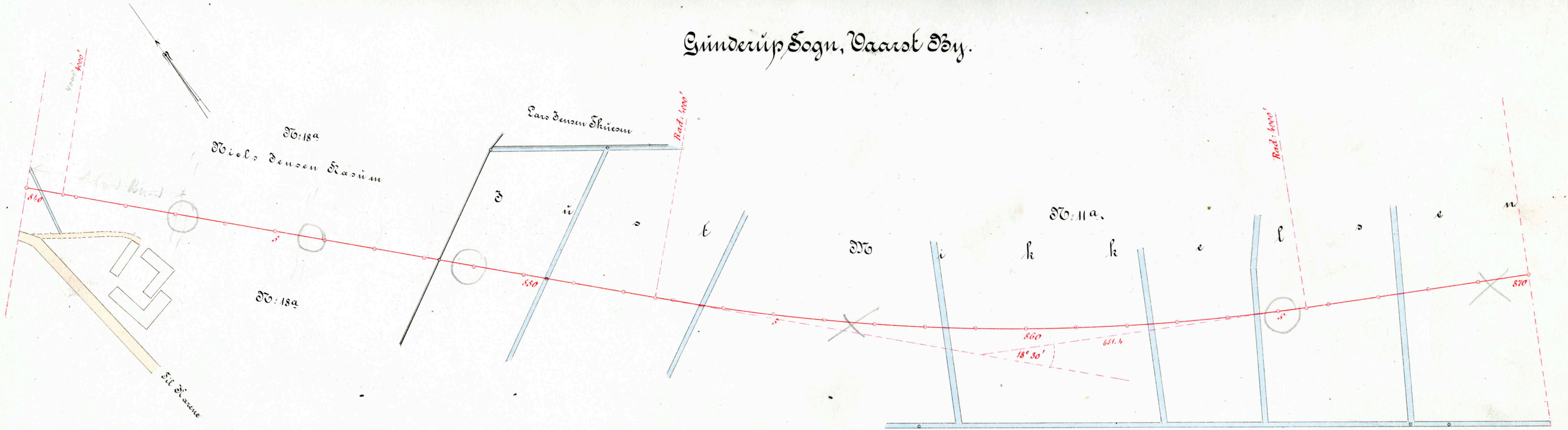

Fleskum Stæd.
Gunderup Sogn.

Stellum Stæd.
Komdrup Sogn.

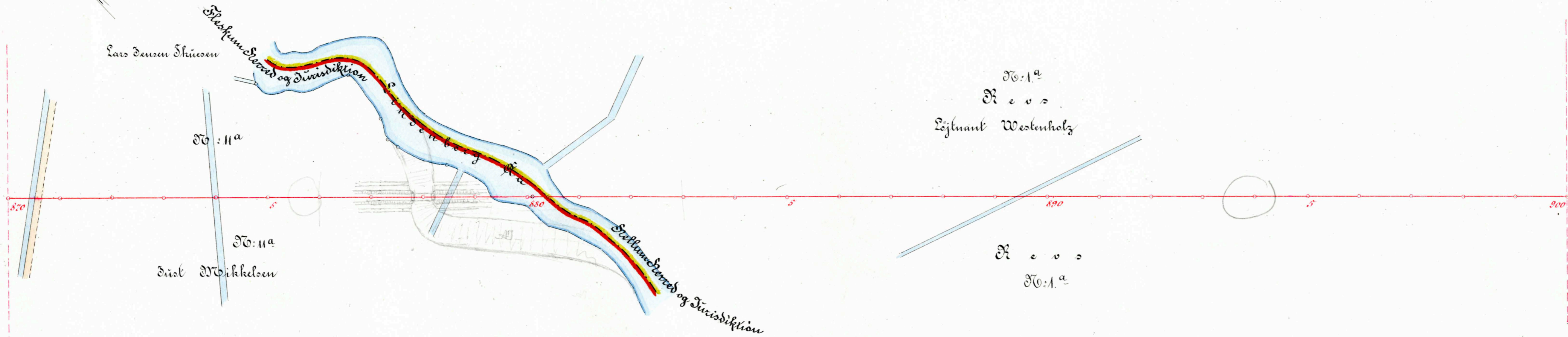

Hömdrúp Sögn.

№: 1^a
R e v s
Löjtnant Westenholz

R e v s
Löjtnant Westenholz
№: 1^a

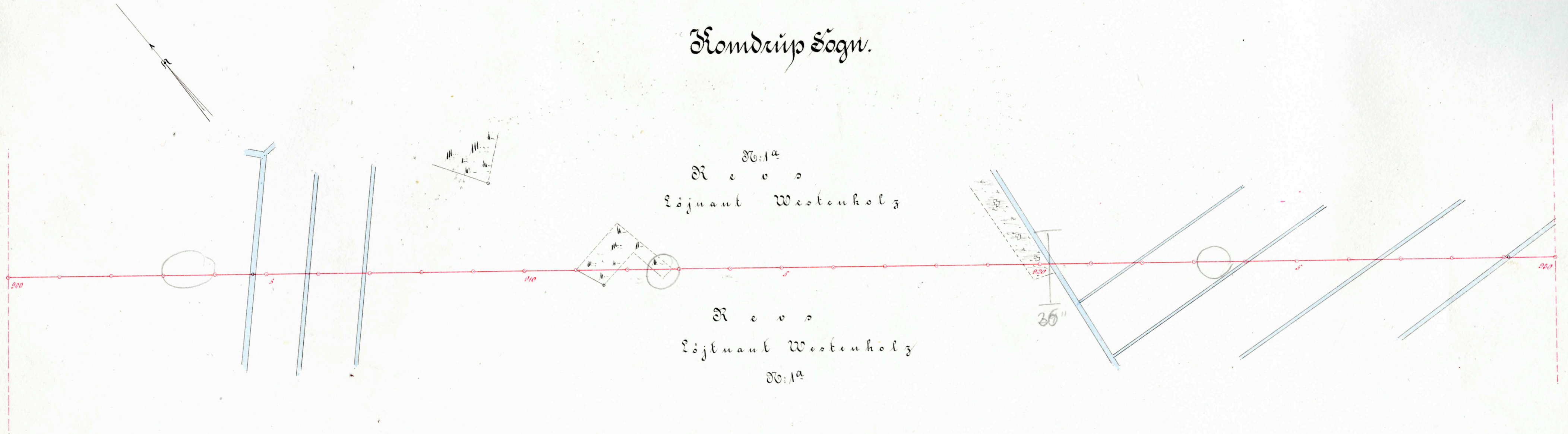

Hondrup Sogn.

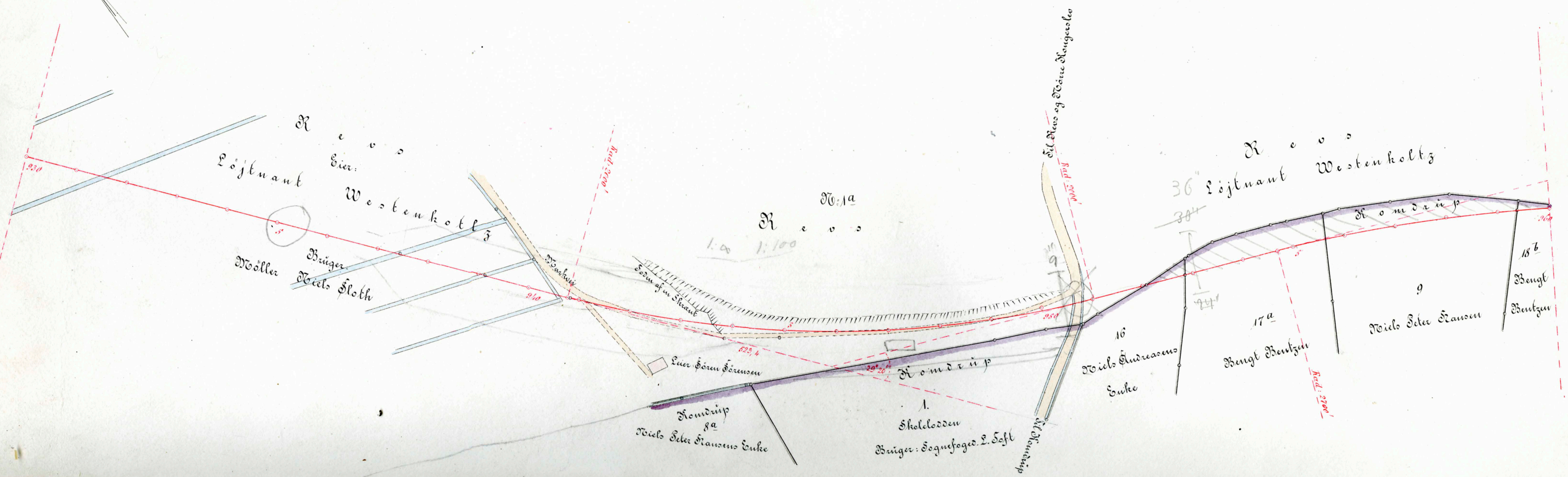

Komdrup Sogn.

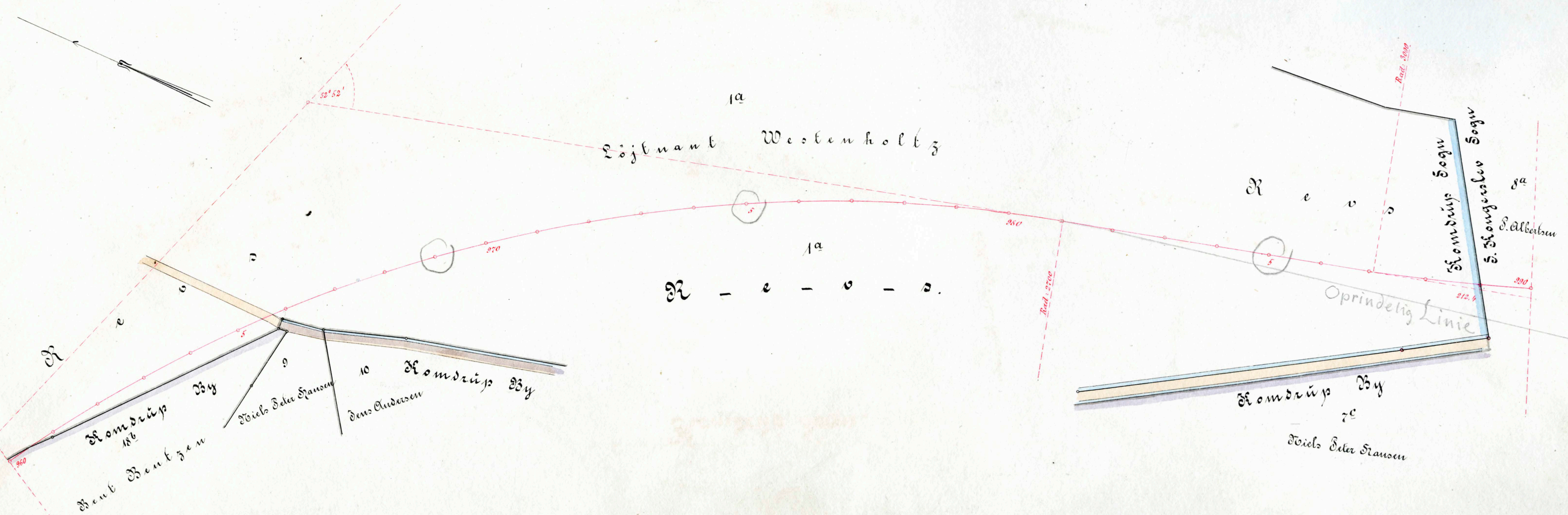

Sønder Kongerslev Sogn og By.

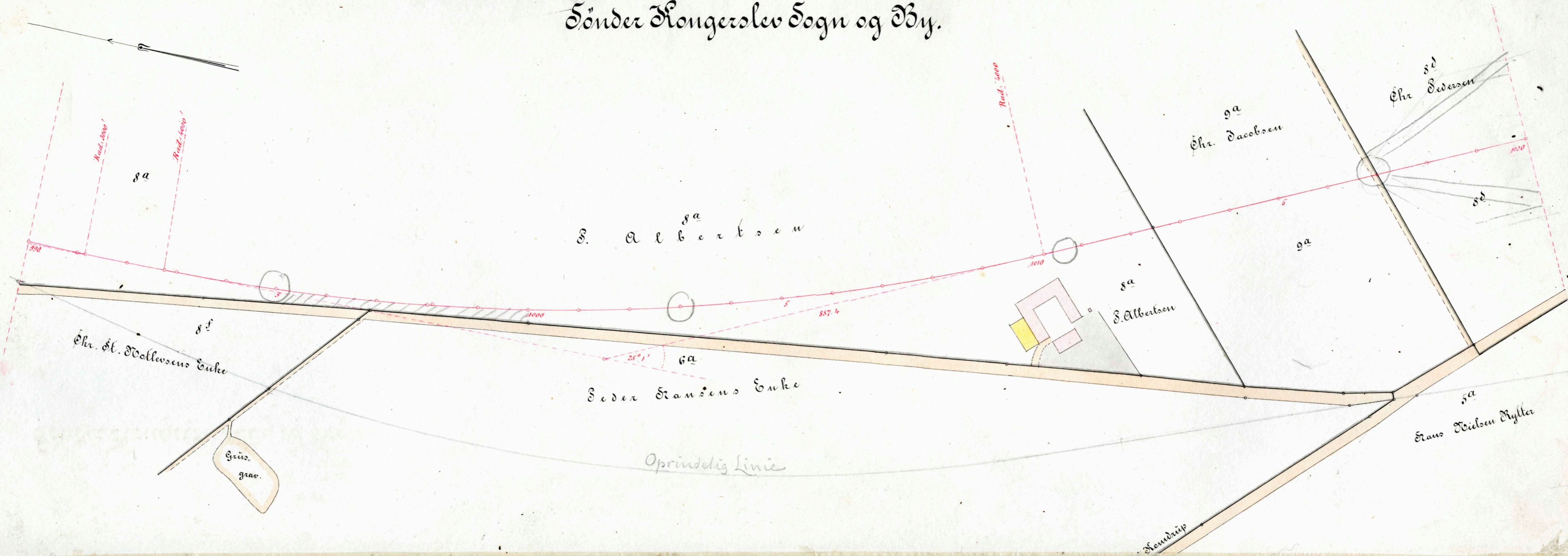

Sönder Kongerslev By og Sogn.

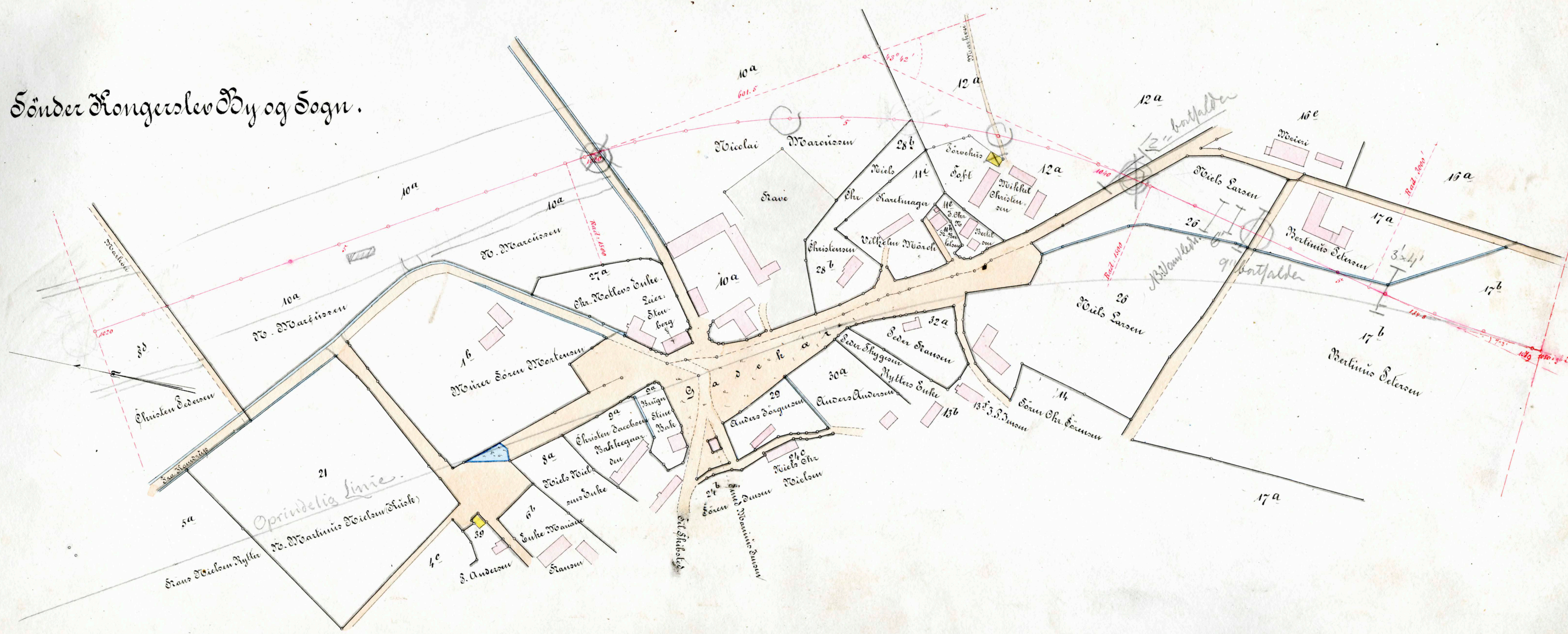

Sønder Frongeslev Sogn.

Skibsted Sogn.

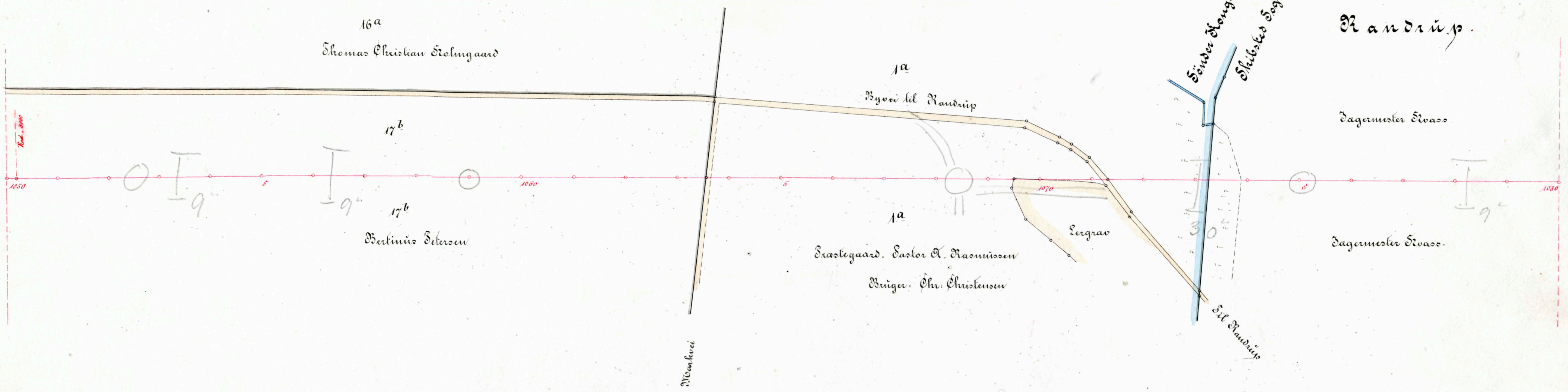

Skibsted Sogn.

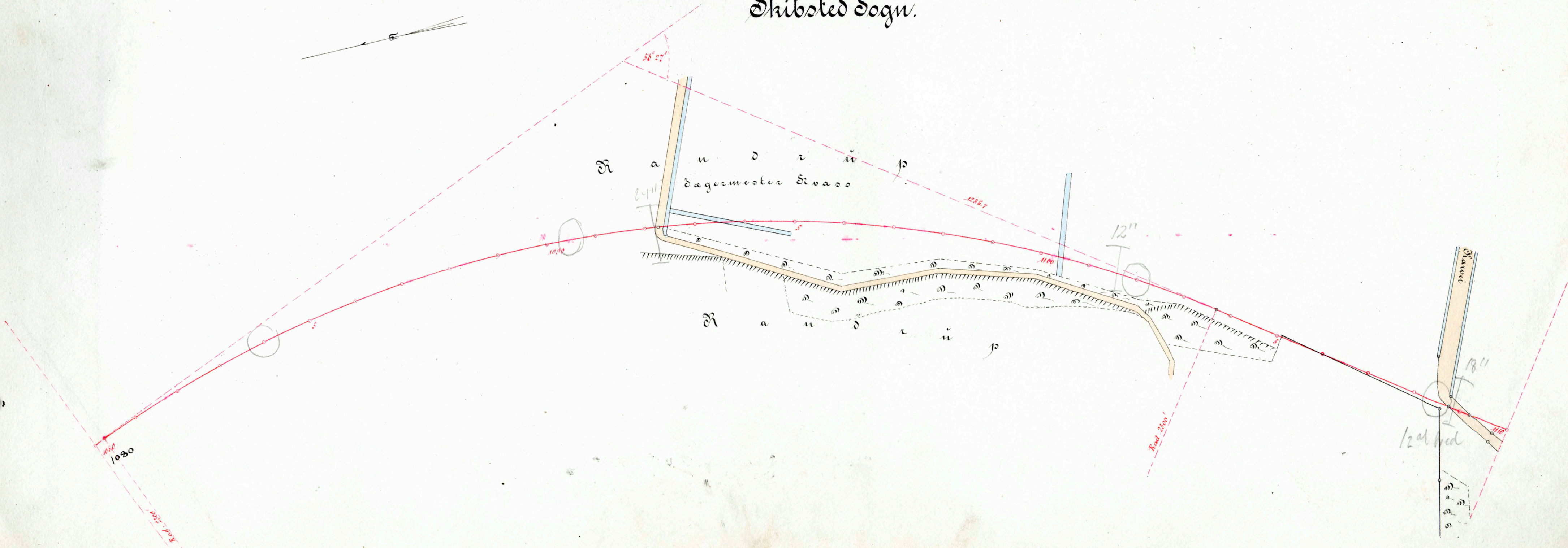

Skibsted sogn.

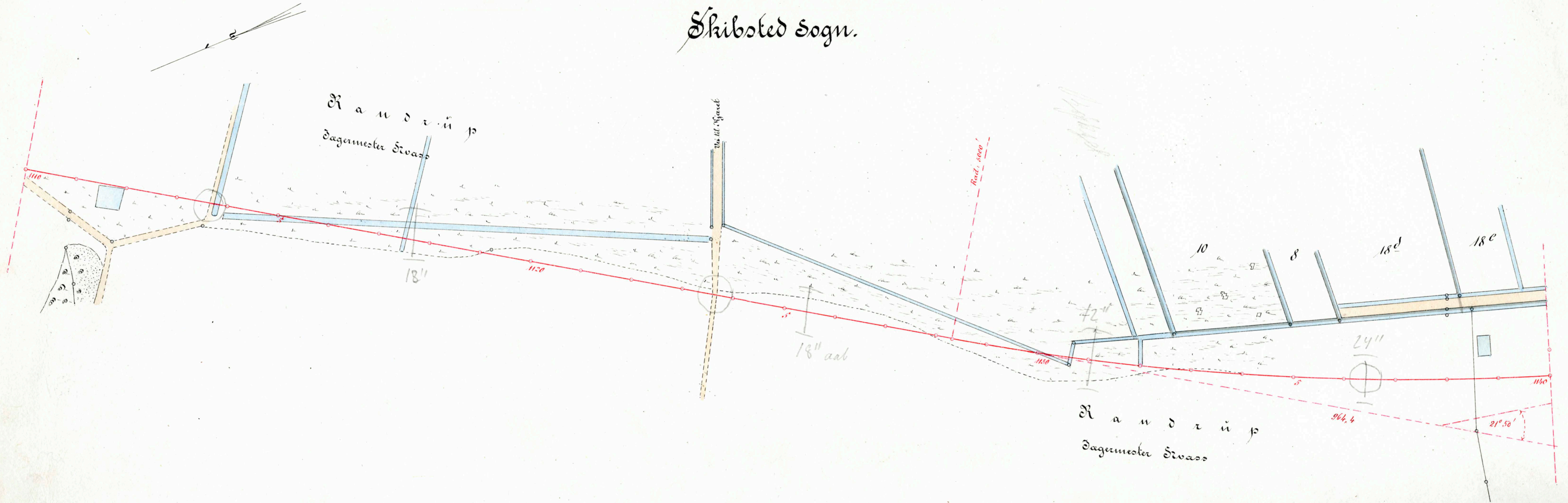

Skibsted Sogn, Svankolk By.

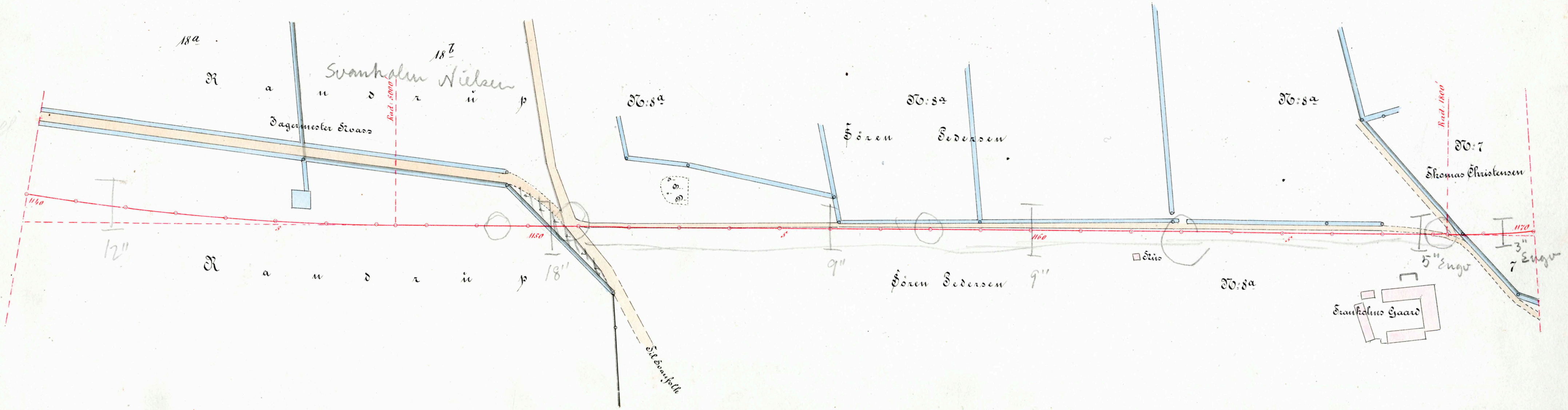

18a

18b

Svankolk Nielsen

Dagemeester Svass

10:8a

10:8a

10:8a

10:7

Thomas Christensen

12"

18"

9"

9"

5" Engv

7" Engv

Frankolms Gaard

St. Svankolk

Skibsted Sogn, Svansfolk By.

Balim Sogn.

