

Facade mod syd, 1:50

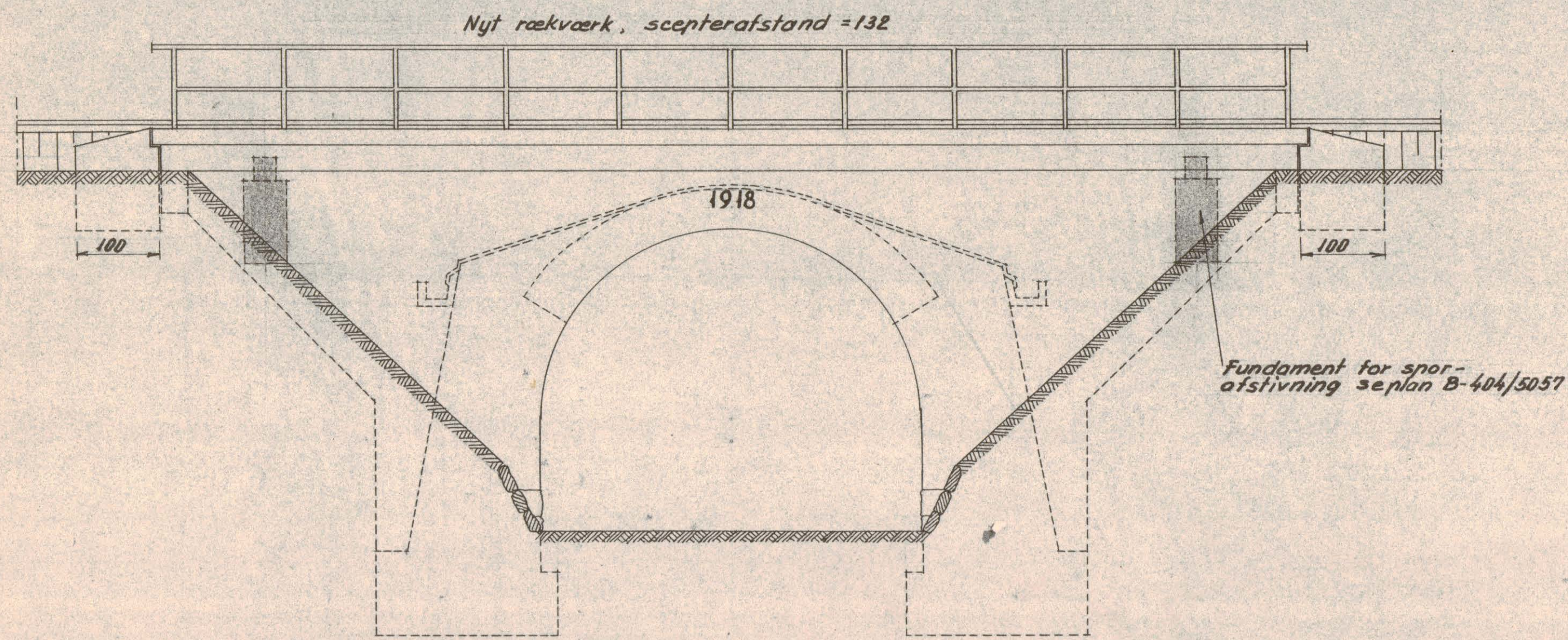

Plan, 1:50

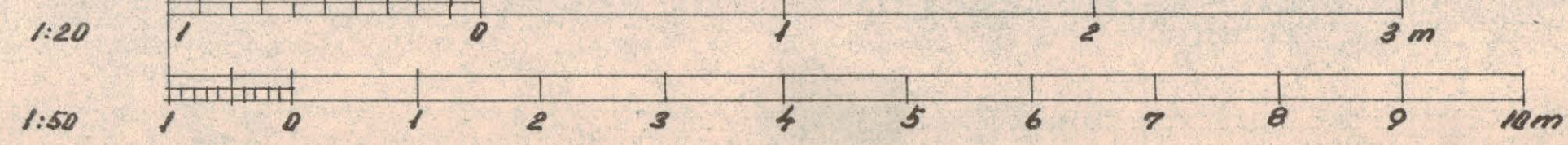
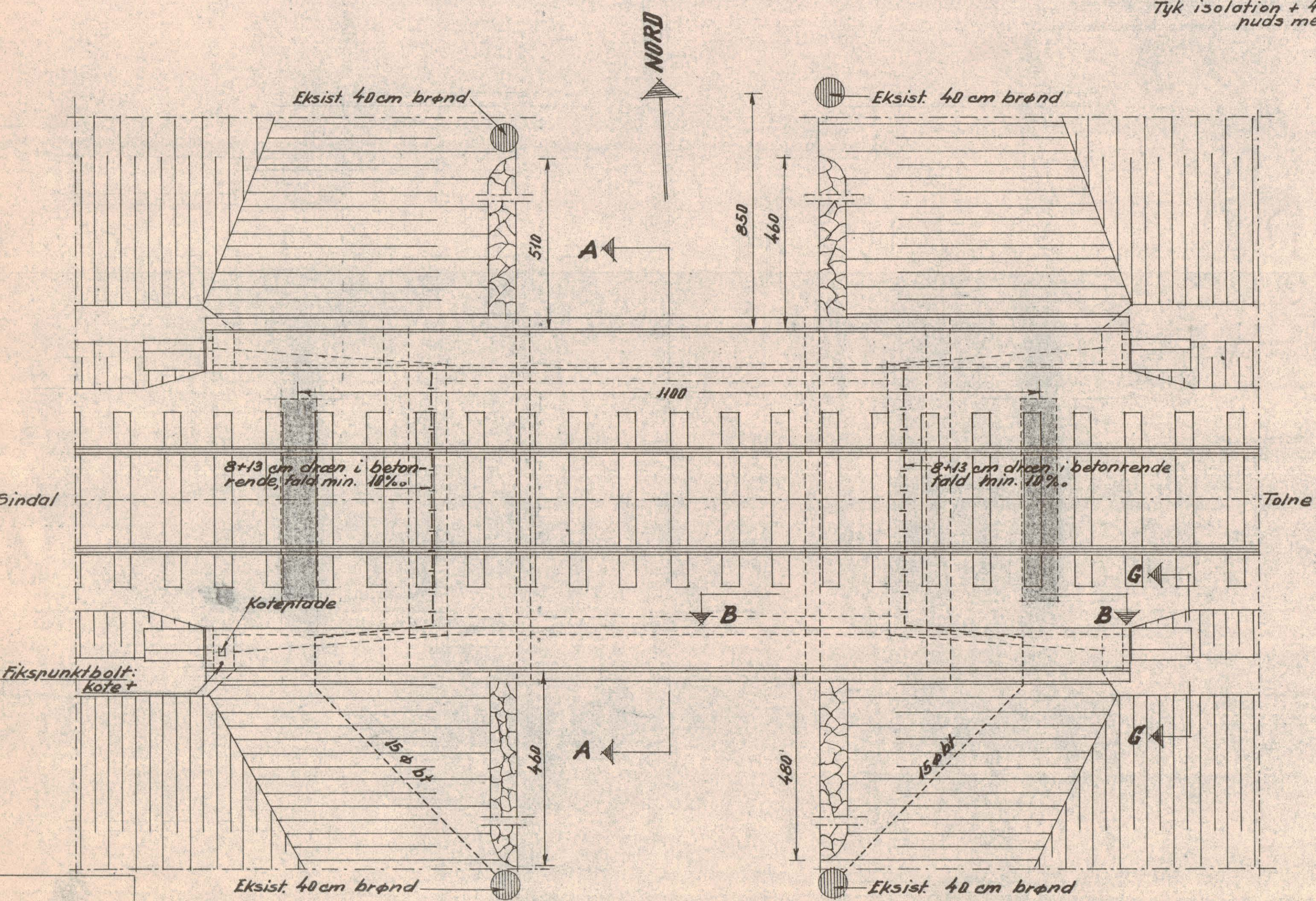

Snit A-A, 1:20

Målsætning af dæksten: se detail, 1:10

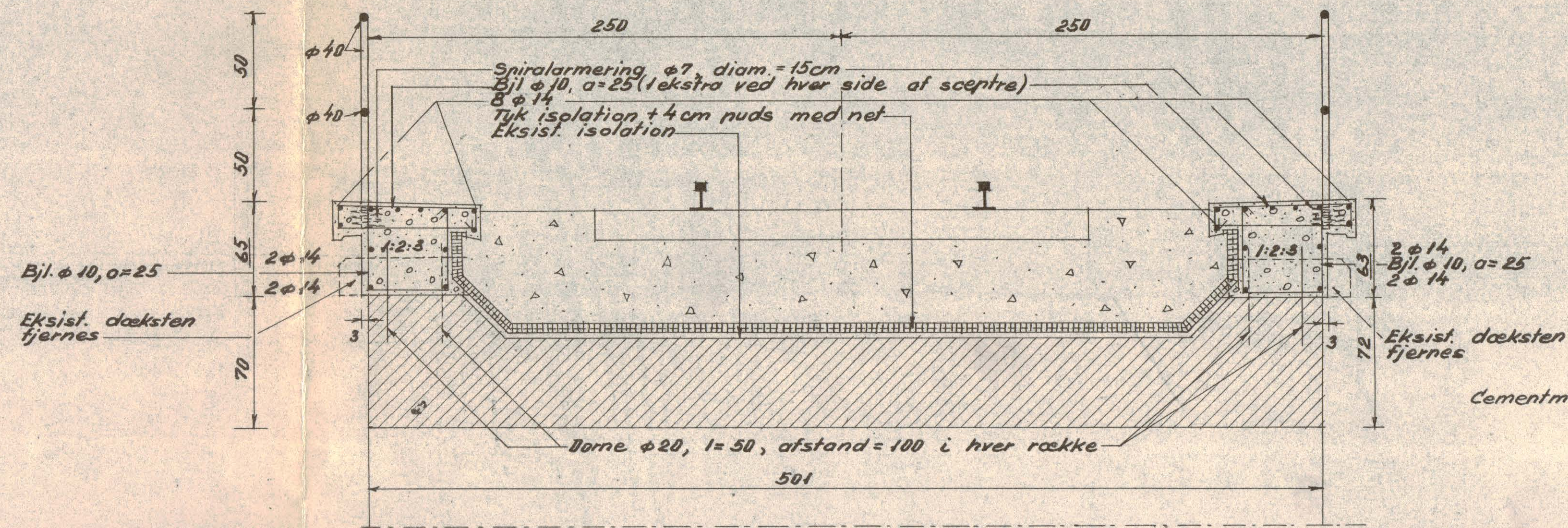

Detail af dæksten, 1:10

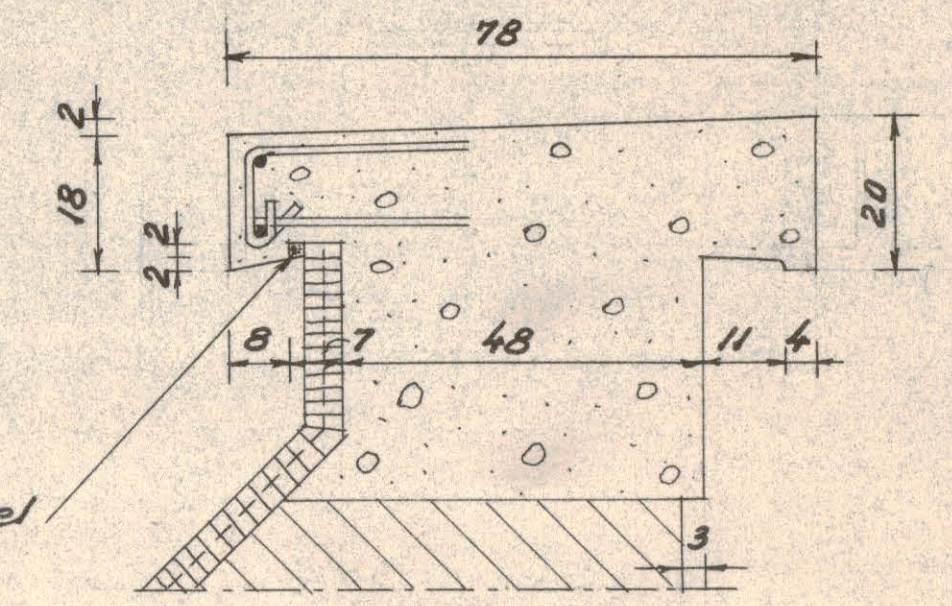

Snit B-B, 1:20

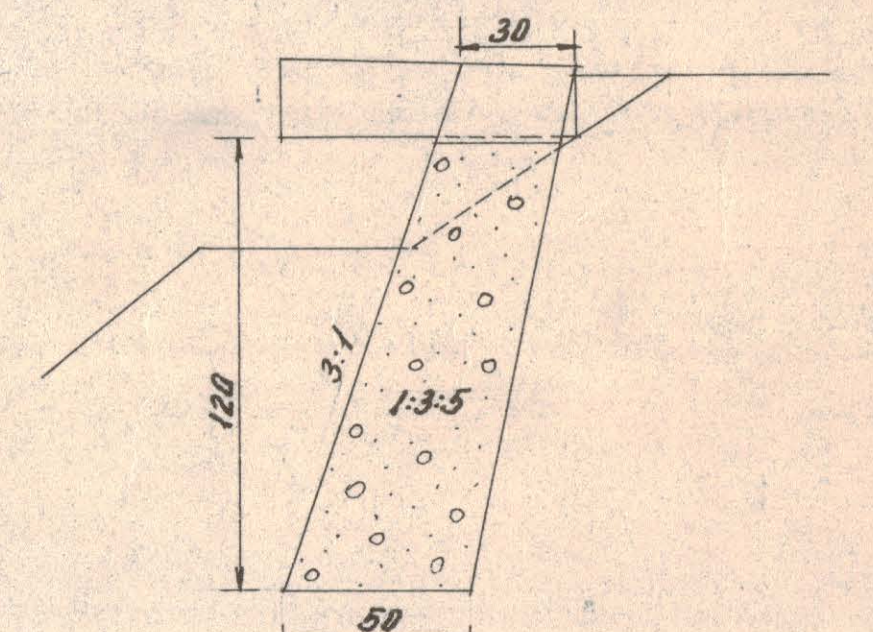

Snit e-e, 1:20

Armering af dæksten og frontmur, se snit e-e

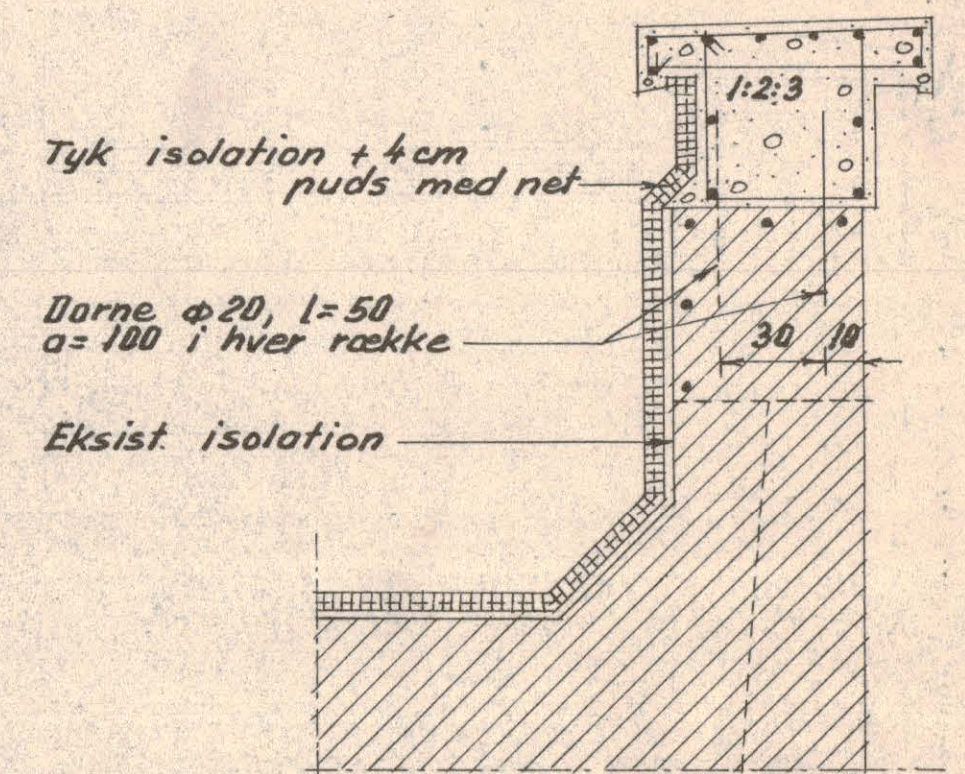

Situationsplan, 1:2000

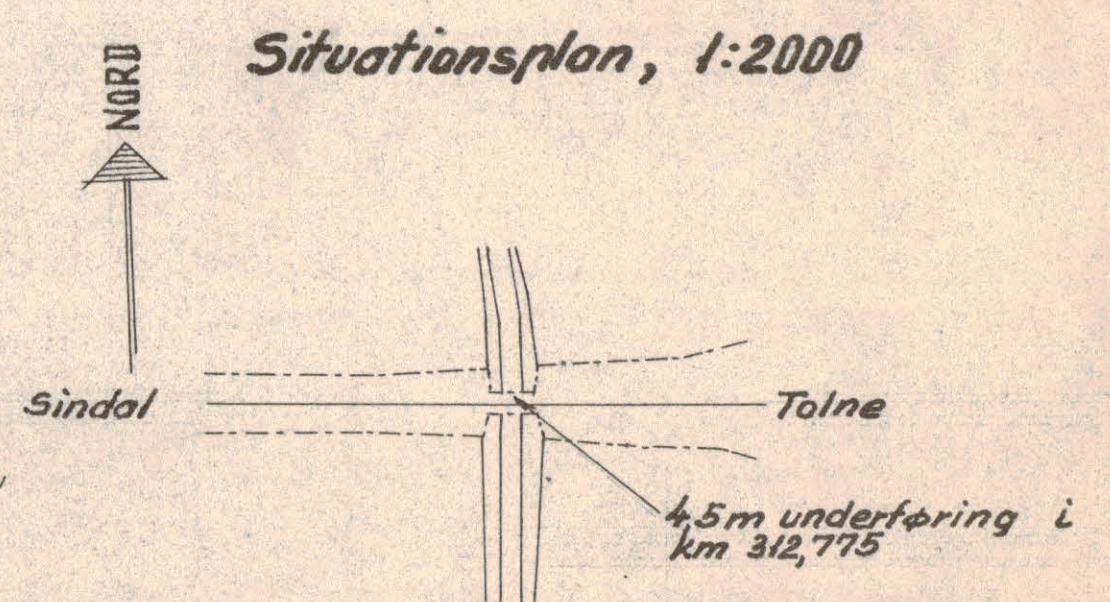

Ubenævnte mål er angivet i cm, jerdimensioner dog i mm.

Obs! understregede mål gælder frem for tegningen

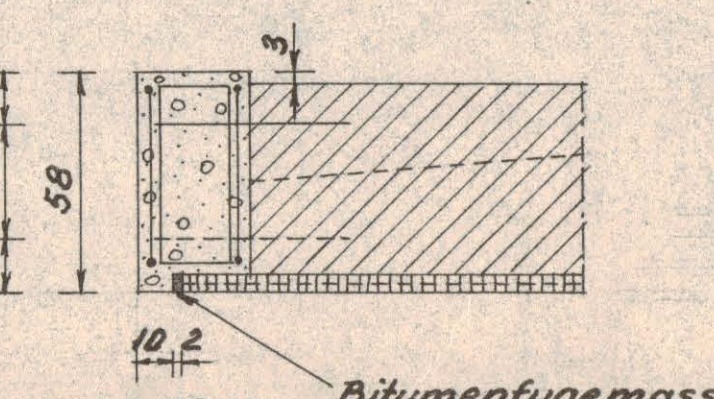

Snit e-e, 1:20

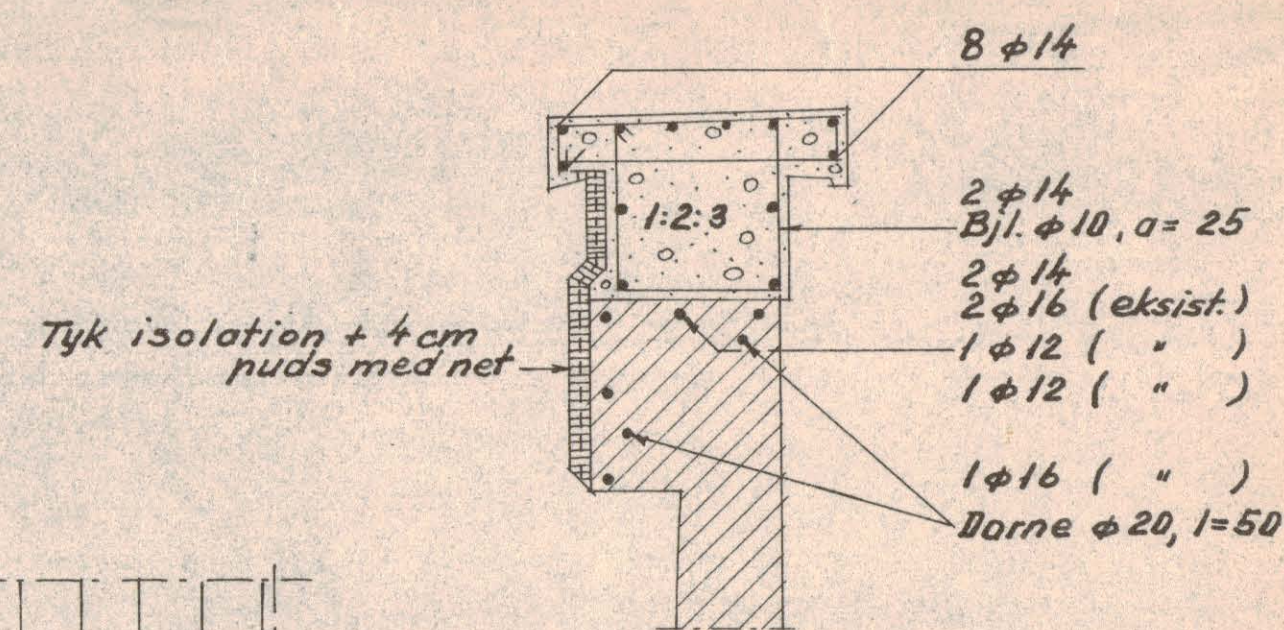

Snit B-B, 1:20

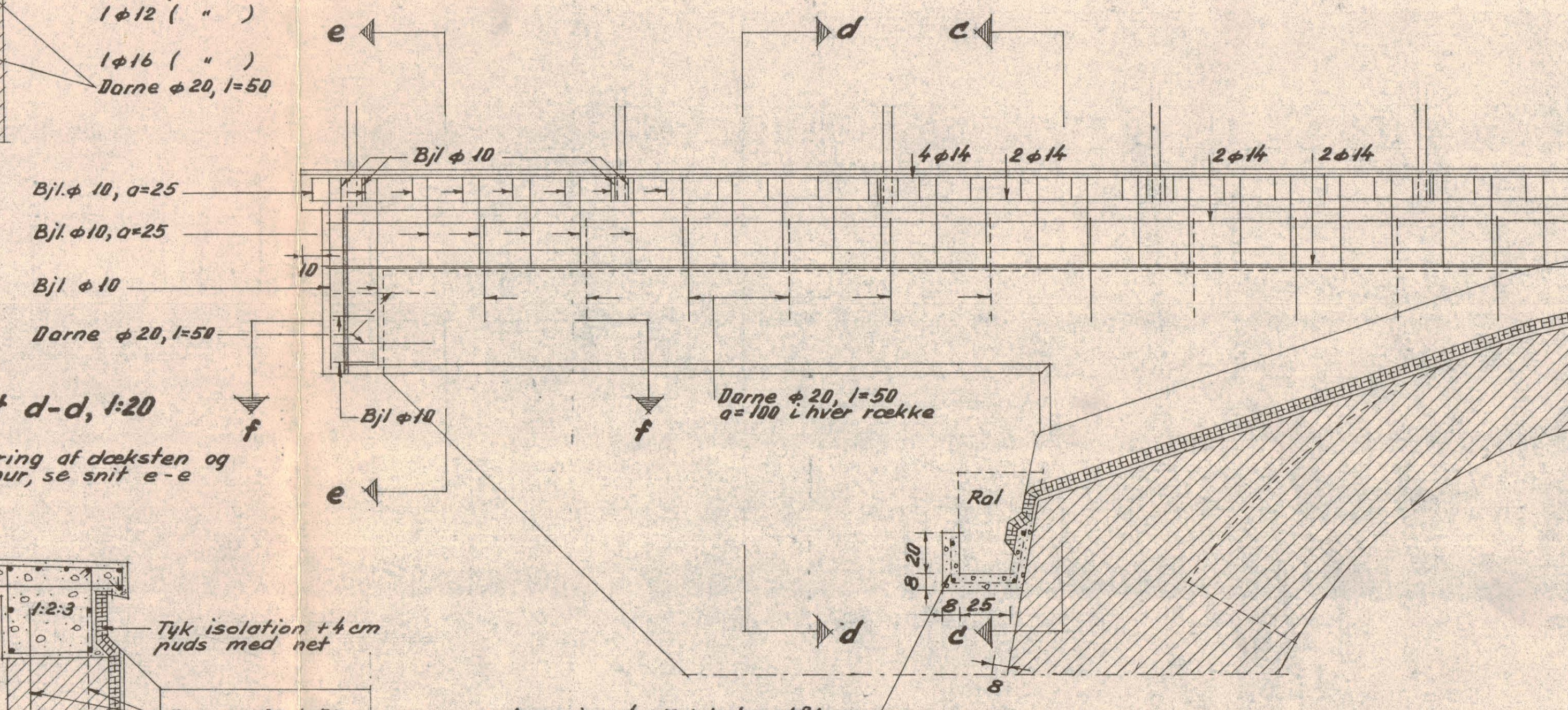

Snit d-d, 1:20

Armering af dæksten og frontmur, se snit e-e

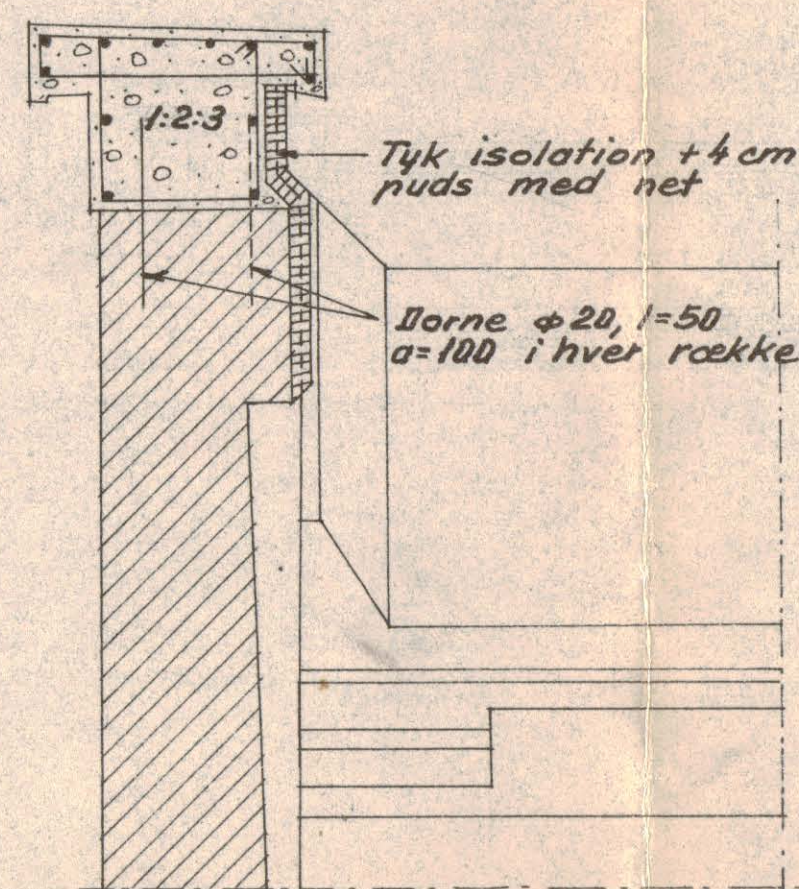

Snit f-f, 1:20



33597

Udførelsesår: 1959
Tegn. rev. efter Udførelsen
d. 4/5 1965. Sign. R. Bjerg.

Tegn. nr.	B-404/5056	Danske Statsbaner
Dato	13-1-59	2. distrikt
Konstr.		Sindal-Tolne, km 312,775
Tegnet af		4,5 m underføring
Kontr.		
Appr.	E. A.	Istandsættelse
Rev.		