

L. Nielsen
Holstebro - Herning

II.

1902.

Holstebro-Herning

Jernbane.

II.

1902.

Forklaring.

Byskjel	
Sogneskjel	
Herredsskjel	
Jurisdiktionskjel	
Amtsskjel	
Kilometer	15,0 15,5
Stations No ^o	470 80
Viadukt over Banen	16'
do under do	12'
Bro	10'
Stenkiste	2 1/2'

Kærlædning	
Off. Niveauoverkjørsel	23
Privat do	24
Niveauovergang	
Vejanlæg	offentl. privat
Gangsti	
Aaførlægning	
Banevogterhus	13
Exproprieret Areal, der er af Statsbanerne.	
Exproprieret Areal, der senere er solgt.	
Snebælte	

1: 20000.

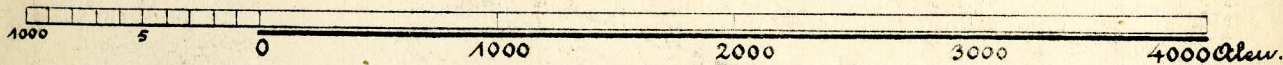
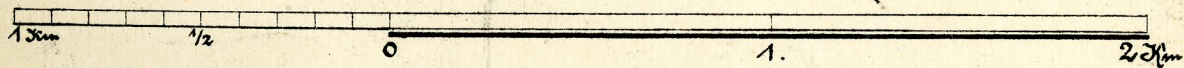

Øversigtskort.

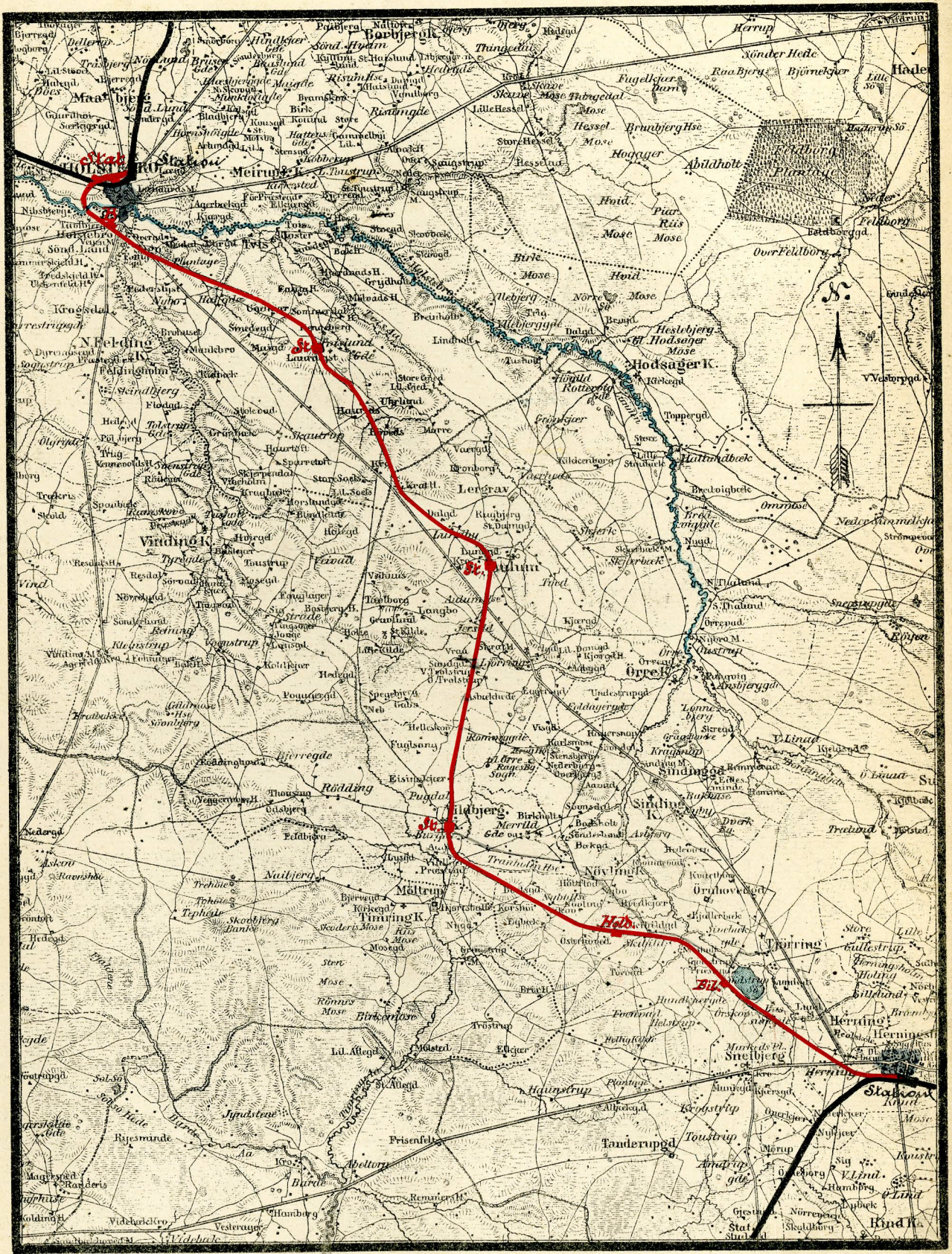

1 1/4 1/2 0 1 Mil.

Ringkjøbing Amt.

Djerm - Ulfborg - og Hammern Herred.

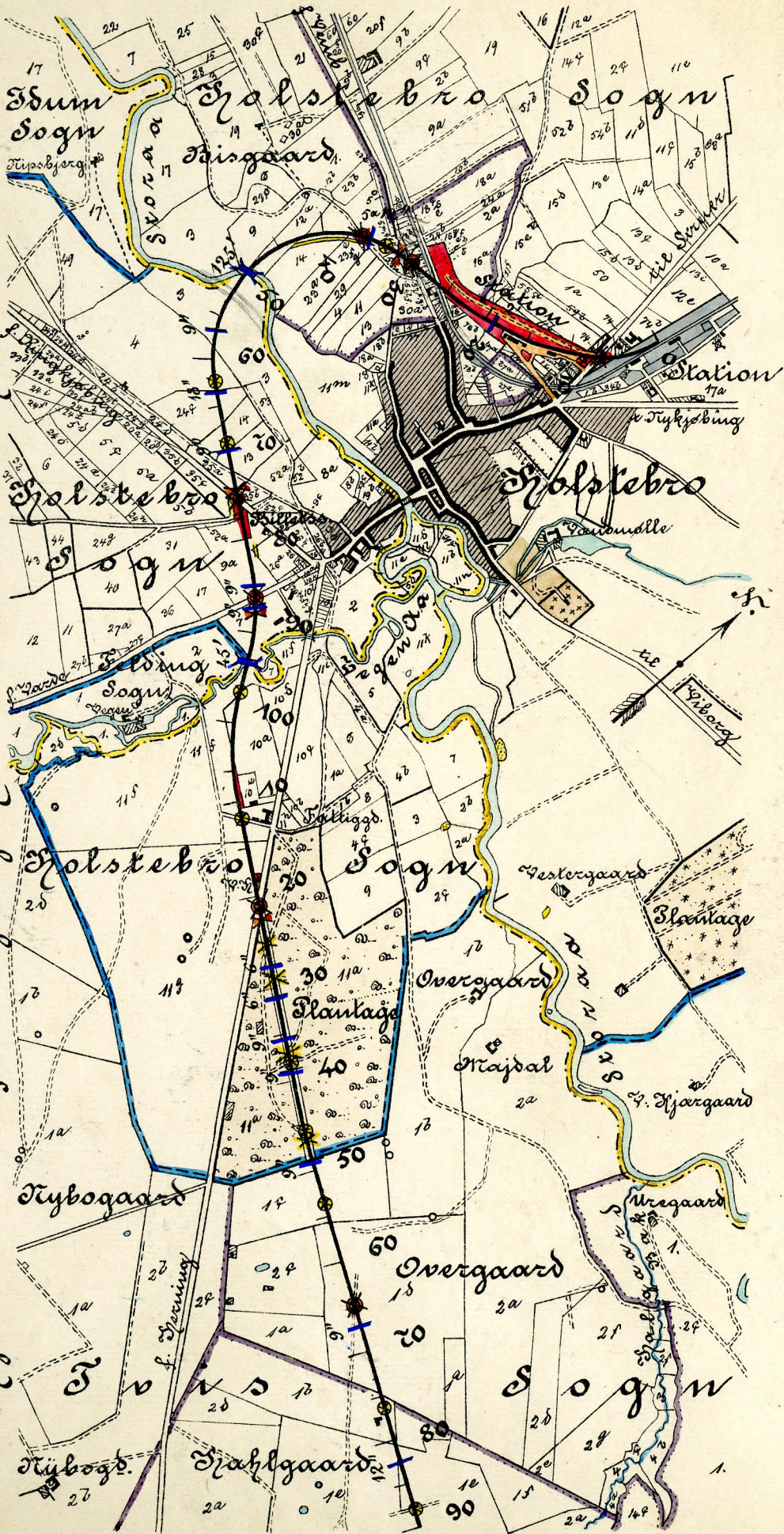

Djerm og Sinding Herred og Hølstebro Stjorkreds Omisdiktion.

Ringkjøbing Amt.

Sammenlægning af 18 Sogne.

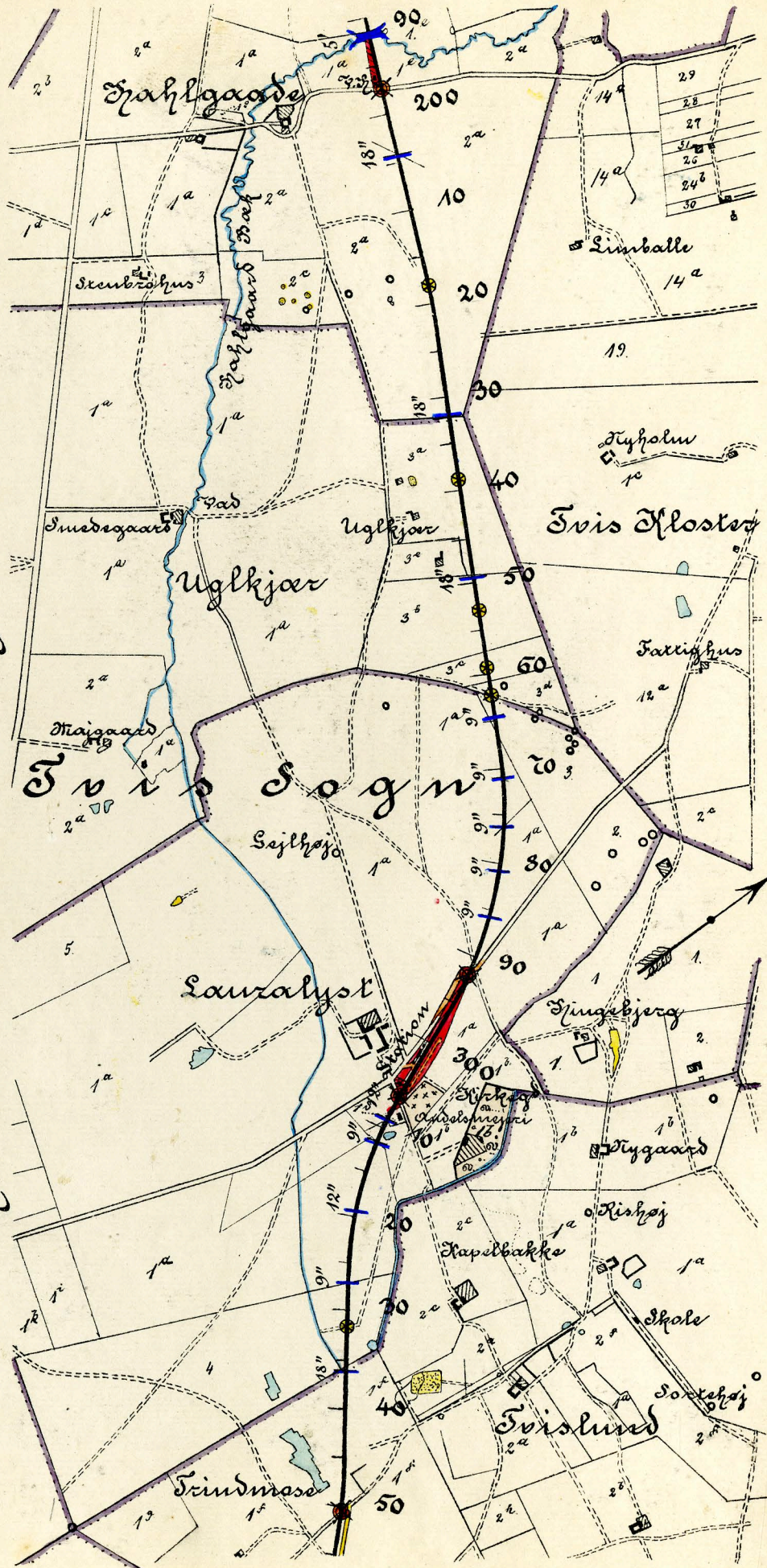

Erjem og Sinding Herredets Jurisdiction.

Ringkjøbing Amt.

Hammerum Herred.

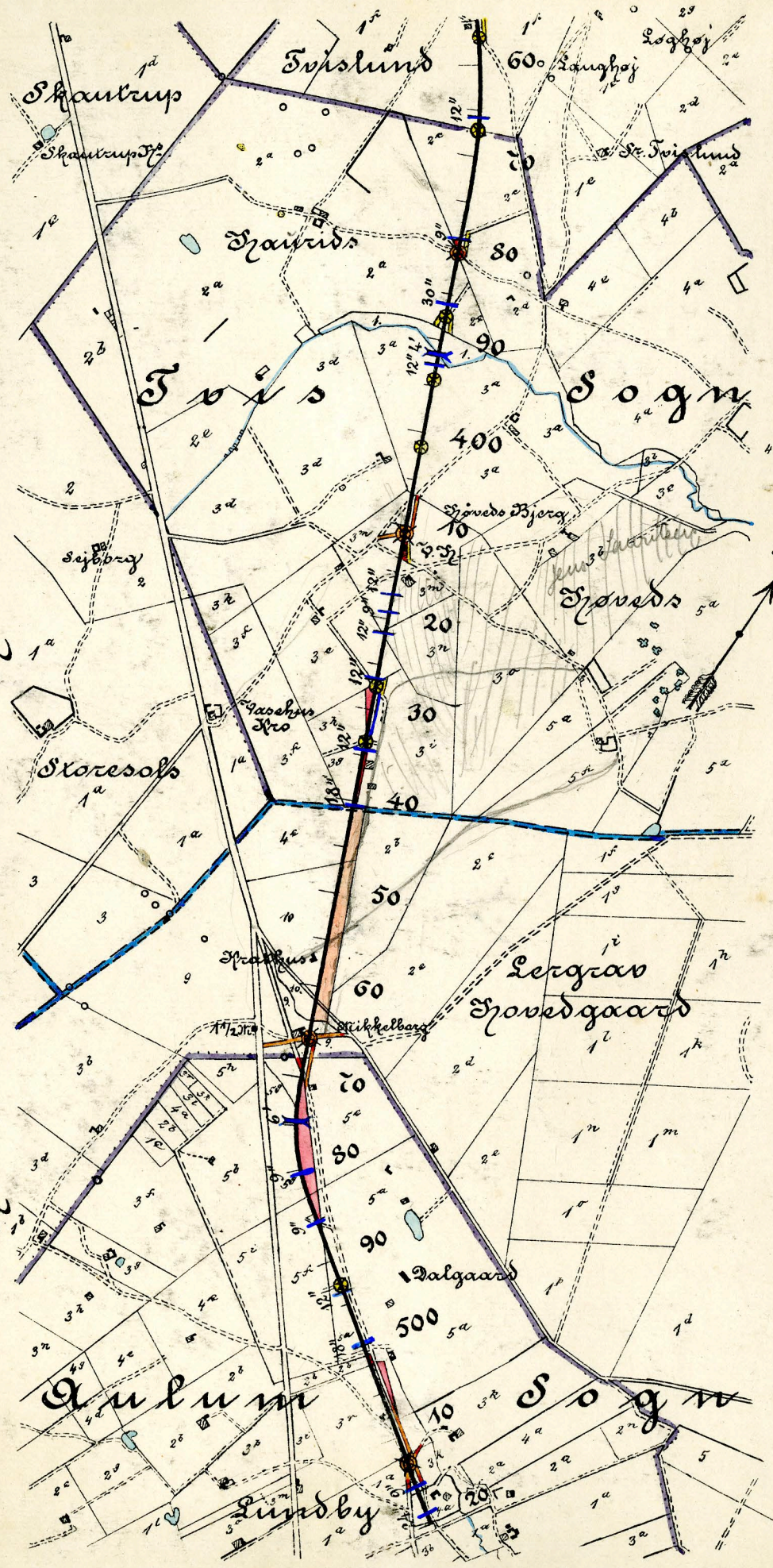

Hammerum Sjøveds Sjøvedsdistriktion.

Ringkjøbing Amt.

Øammerum Herred.

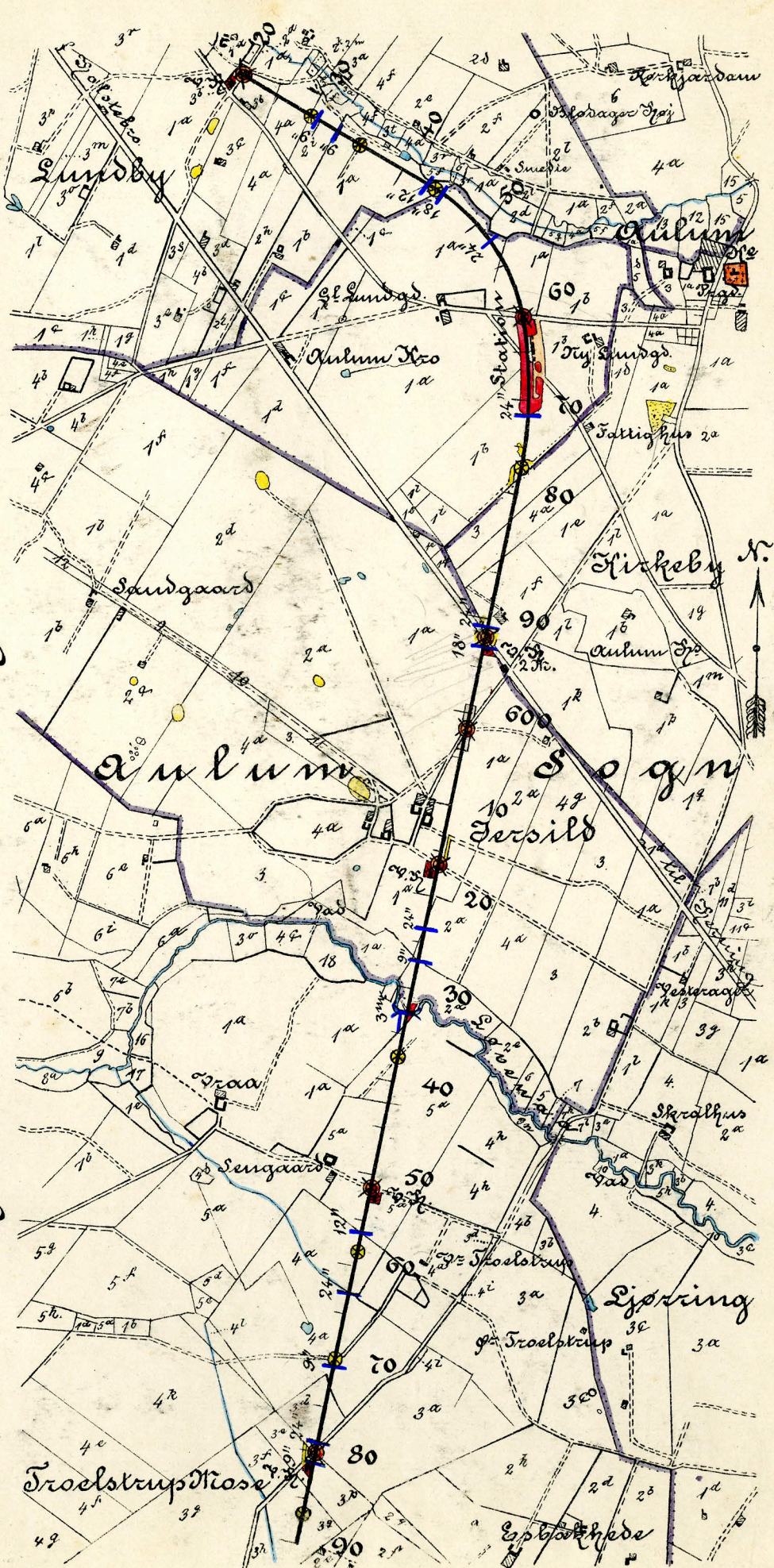

Øammerum Herreds Jurisdiktion.

Ringkjøbing Amt.

Hammerum Herreds Omridsskizze.

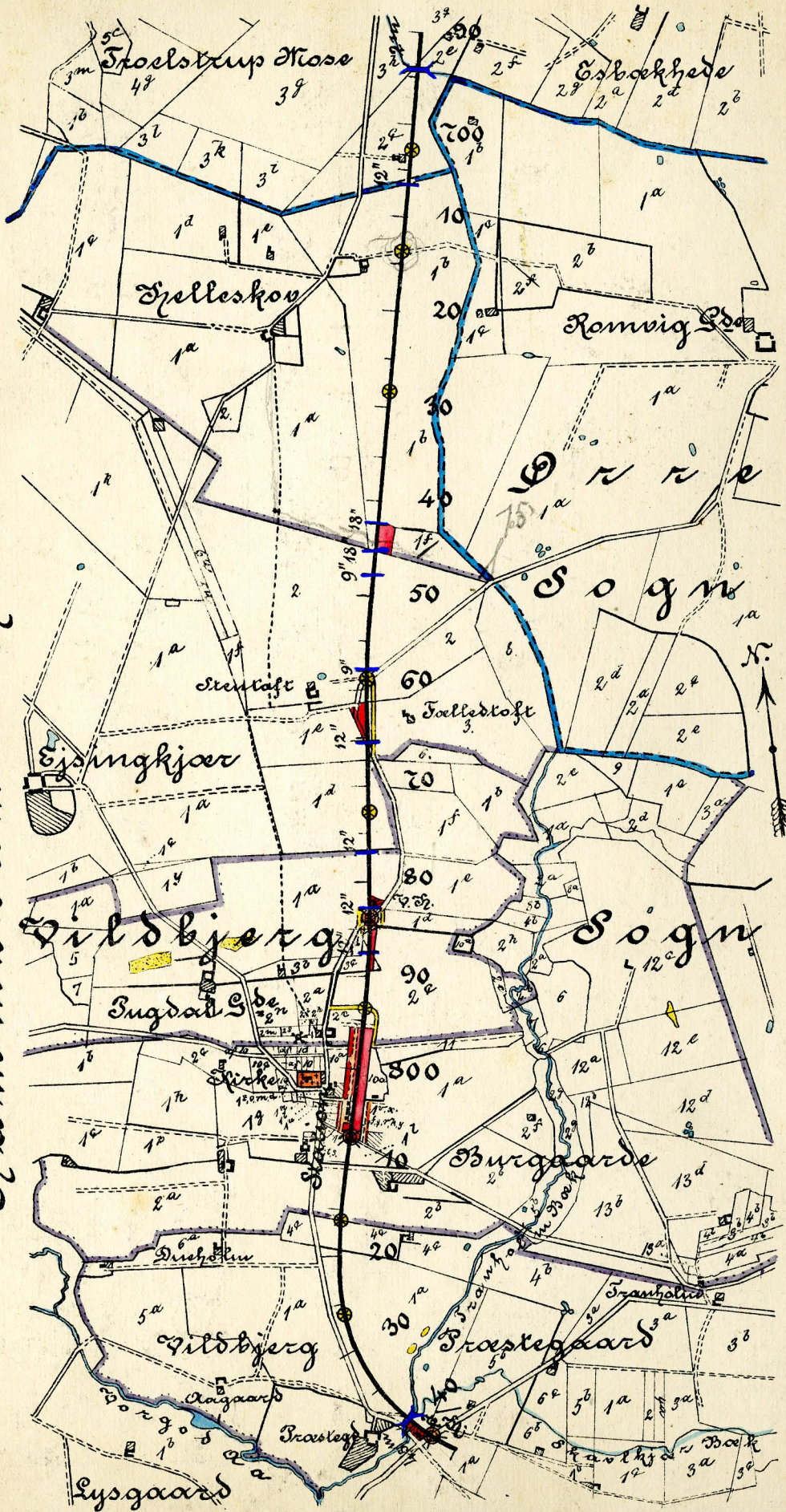

Hammerum Herreds Omridsskizze.

Ringkjøbing Amt.

Hammerum Herred.

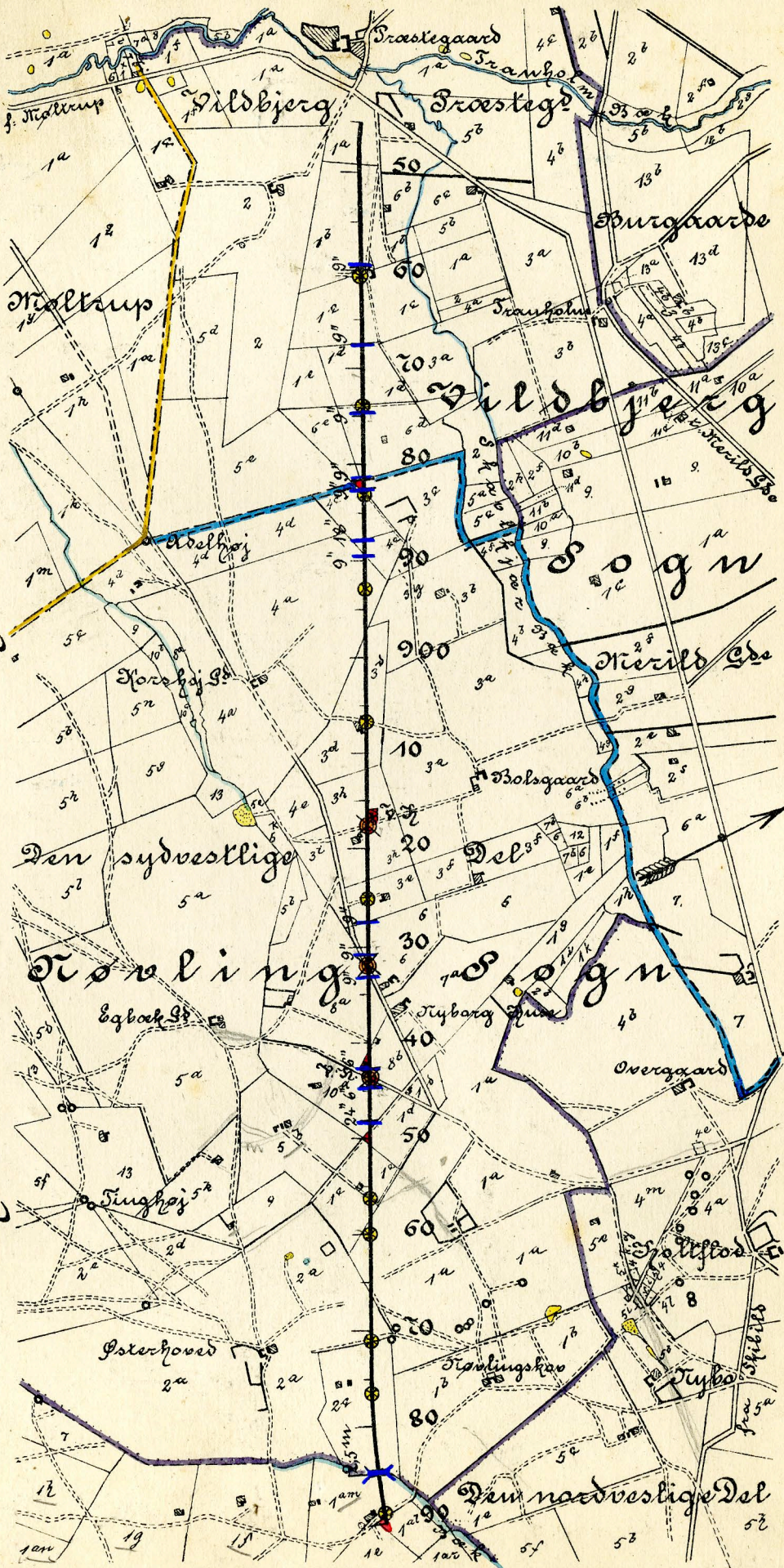

Hammerum Herreds Jurisdiktion.

Hingkjøbing Amt.

Hammerum Herred.

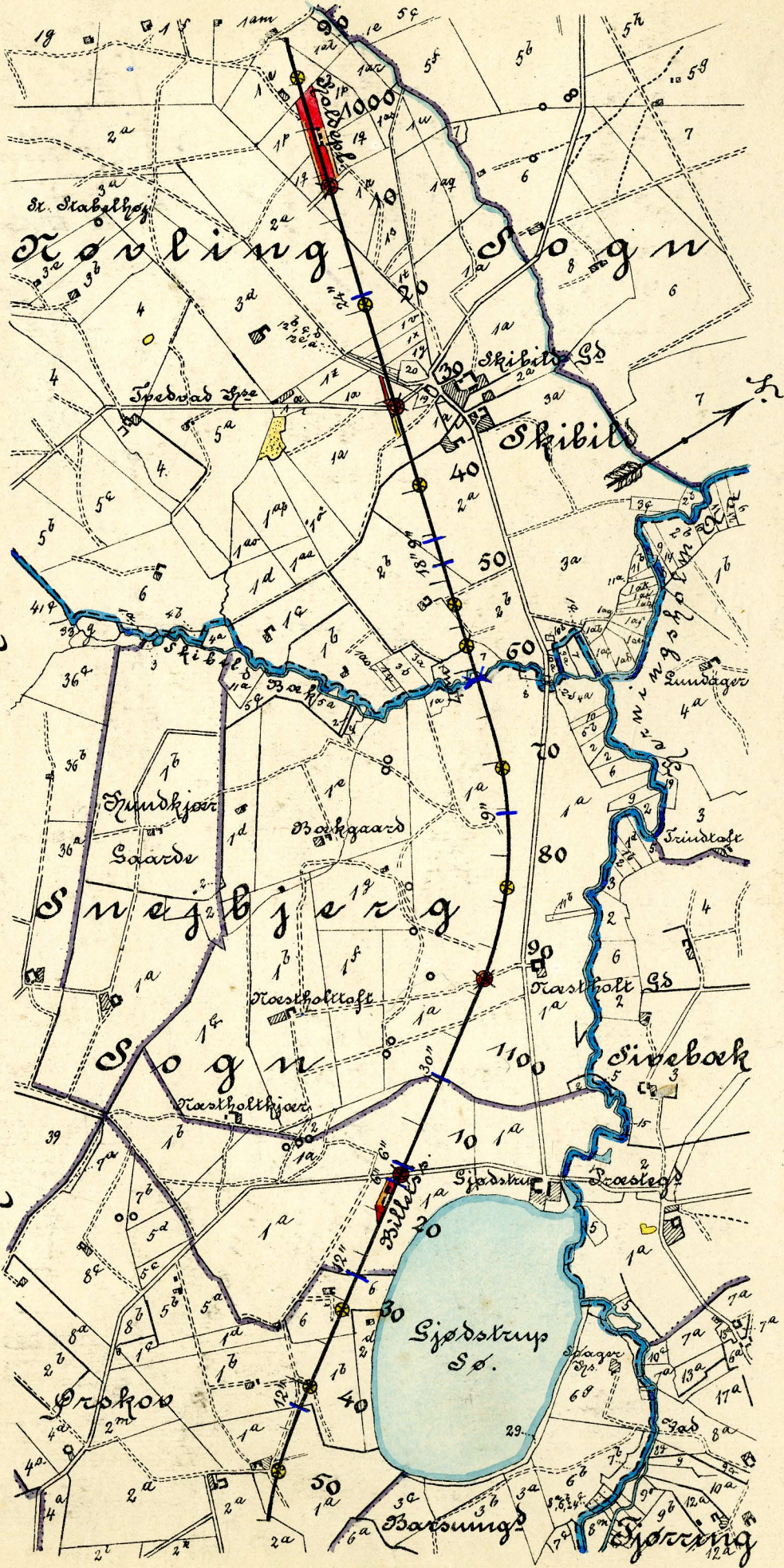

Hammerum Herreds Jurisdiktion.

Ringkjøbing Amt.

Hammerum Herred.

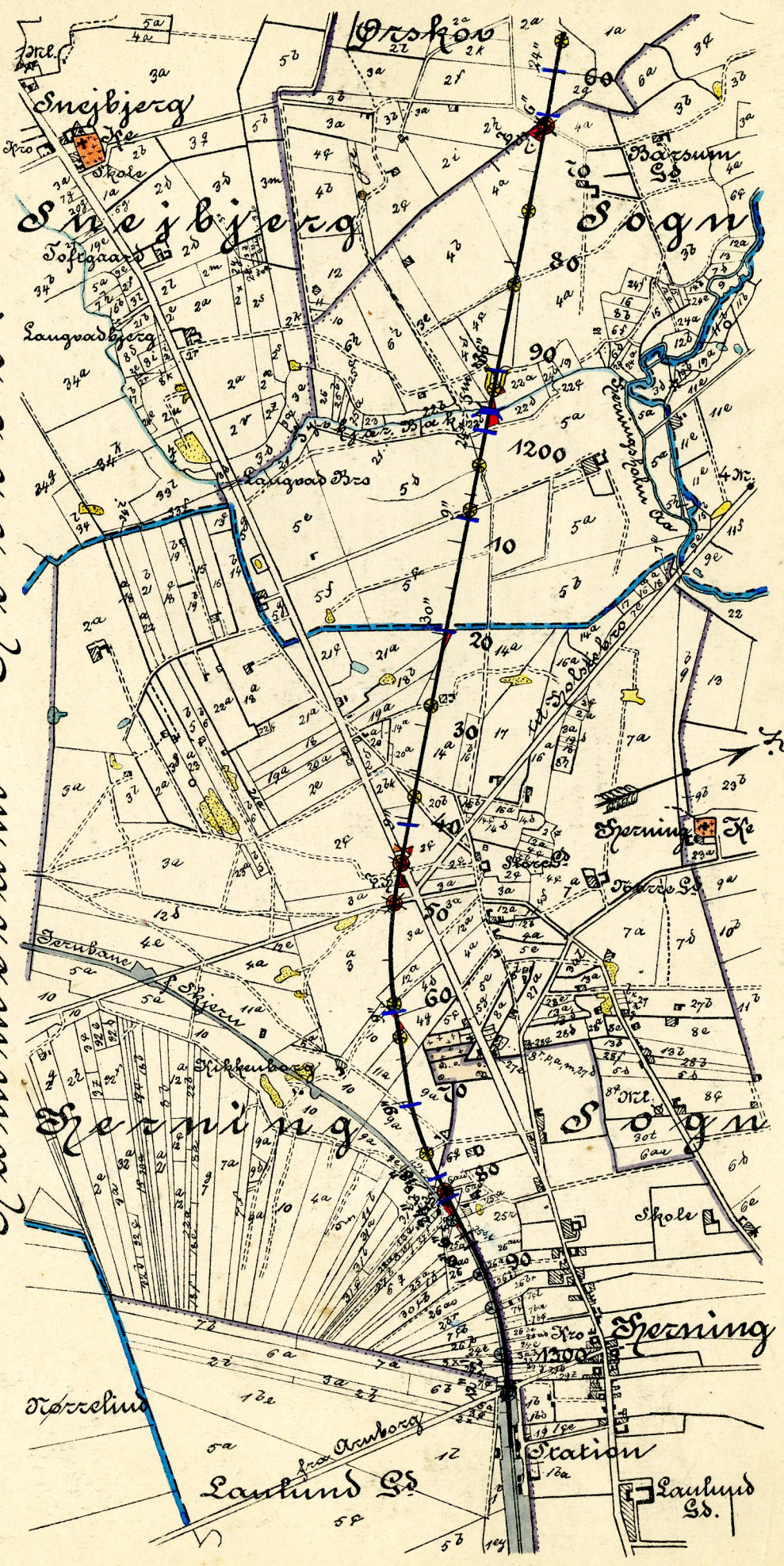

Hammerum Herreds Jurisdiktion.

